



SoftZone®

Architectural Acoustic Lighting

Introducing Spatial SoftZone & StencilFlex™ SoftZone

axis

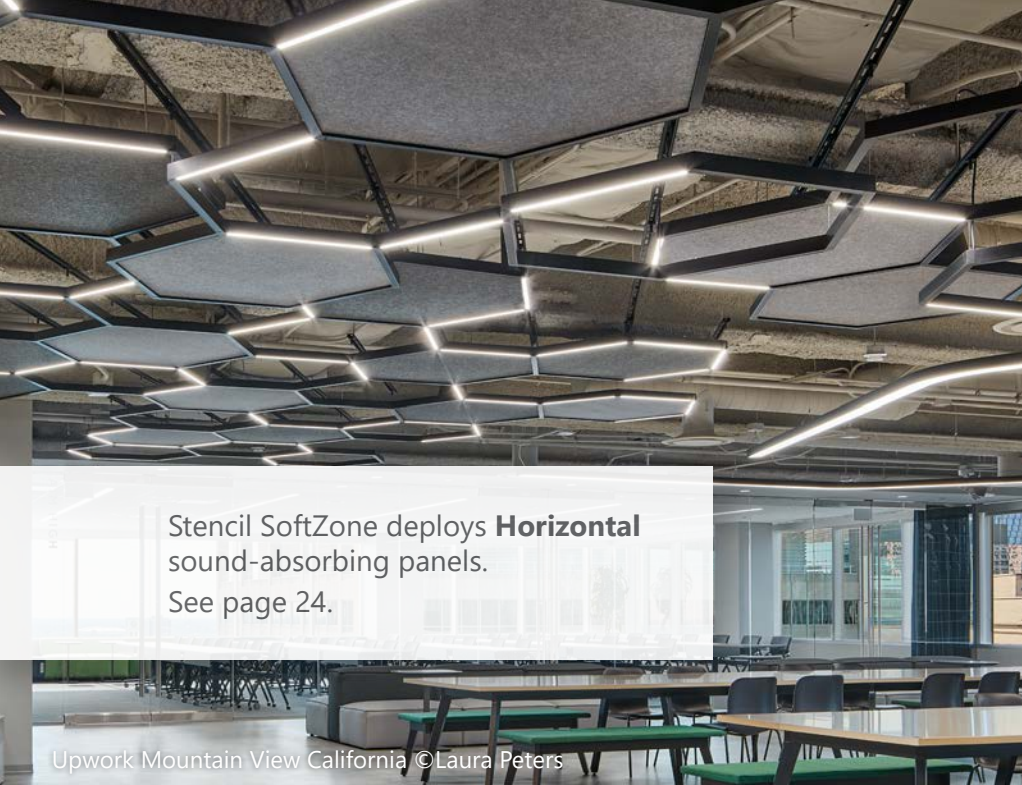

Stencil SoftZone deploys **Horizontal** sound-absorbing panels.
See page 24.

Upwork Mountain View California ©Laura Peters

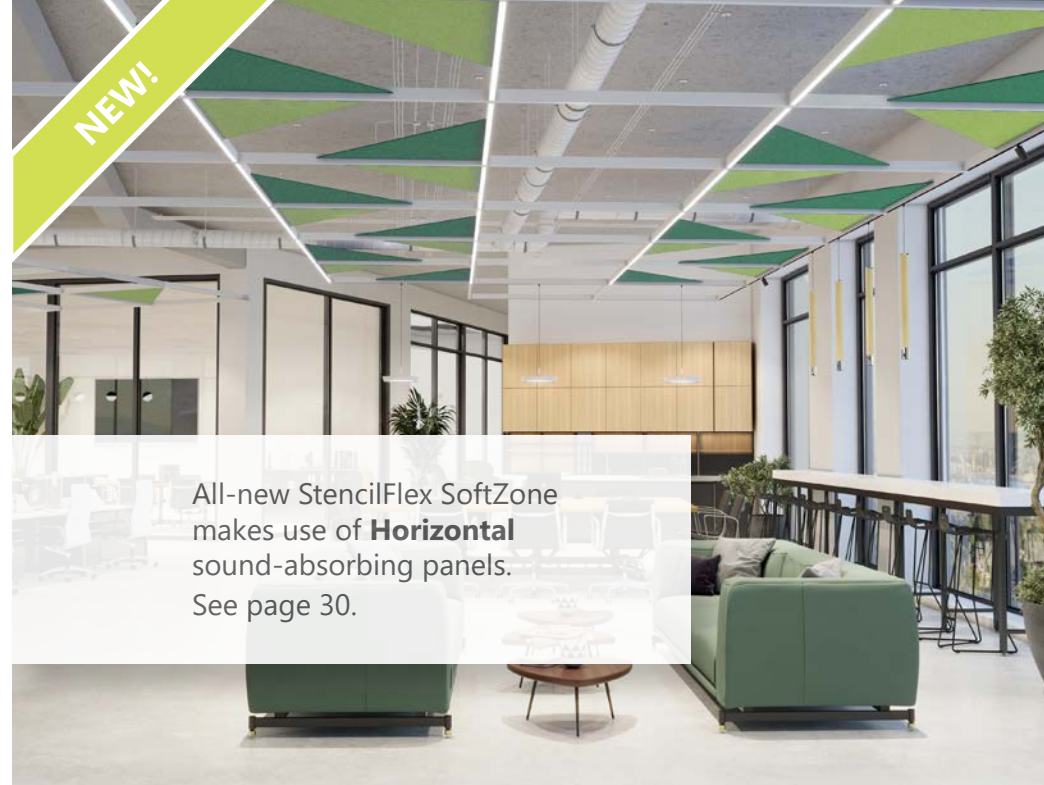

All-new StencilFlex SoftZone makes use of **Horizontal** sound-absorbing panels.
See page 30.

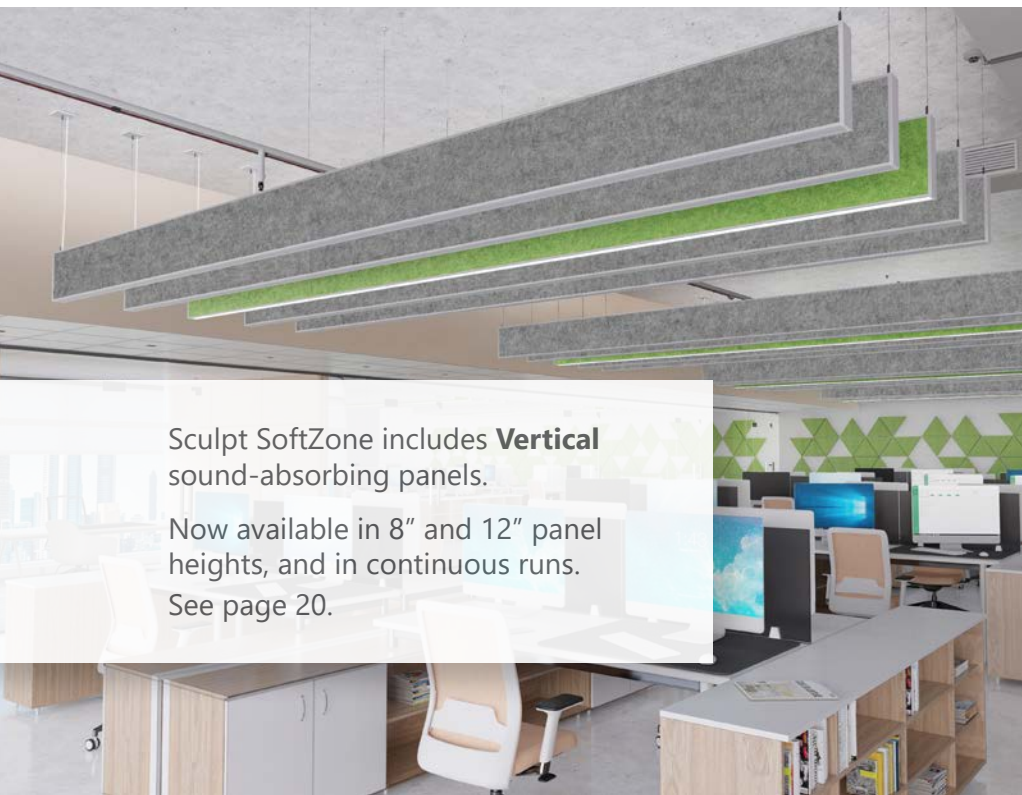

Sculpt SoftZone includes **Vertical** sound-absorbing panels.

Now available in 8" and 12" panel heights, and in continuous runs.
See page 20.

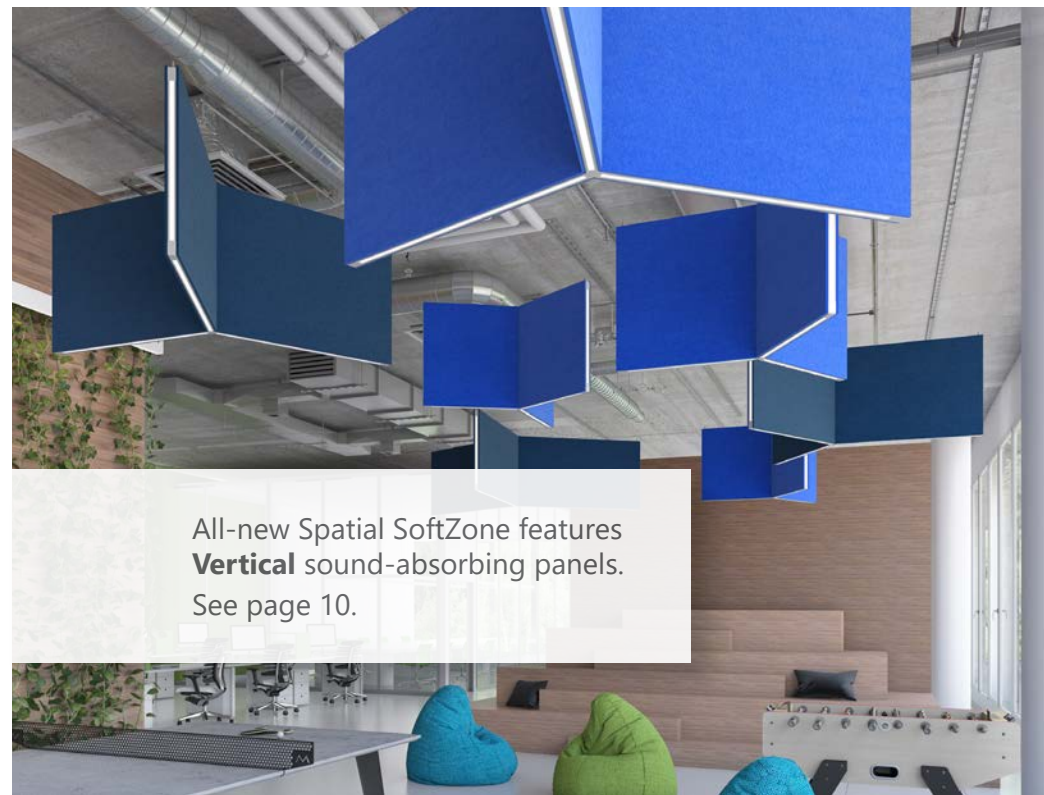

All-new Spatial SoftZone features **Vertical** sound-absorbing panels.
See page 10.

SoftZone®

Improve workplace acoustics with style

Acoustics play an important role in occupant performance and well-being in office interiors. Noisy open office areas, sound-reflecting surfaces and other low-absorption design elements can increase the background din, distract occupants and contribute to lower productivity in the workplace.

SoftZone provides unparalleled design flexibility for creating architectural pendant lighting with effective sound attenuation properties.

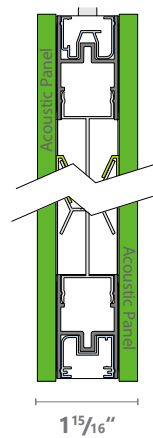

Spatial SoftZone

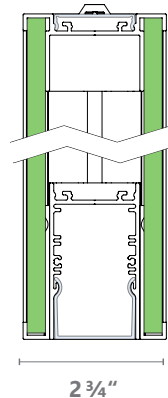

Sculpt™ SoftZone

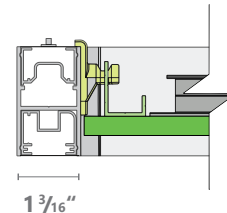

Stencil® SoftZone

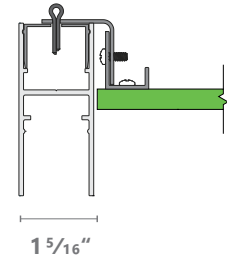

StencilFlex™ SoftZone

About acoustics

Here are a few notions about sound absorption in enclosed spaces that will help you develop more acoustically effective workplaces, with the assistance of your Axis Lighting representative.

Sound absorption

When sound strikes a surface or a wall, some of it is reflected (reverberation), some of it is absorbed and some of it is transmitted to the other side. The nature of the obstacle determines how much sound is reflected, absorbed and transmitted.

A measure of a material's performance is the absorption coefficient α :

$\alpha = 0$ if totally reflective

$\alpha = 1$ if totally absorptive and/or transmissive

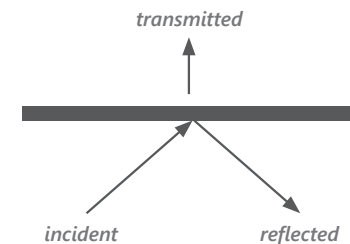



3' Stencil® SoftZone® segmented hexagon panels

The more sound absorption you need, the more SoftZone panels you use in the space.

Different surfaces have different sound-absorbing properties. Porous matter, such as carpeting, wood and the material used for SoftZone, are very effective at absorbing sound. In comparison, hard and smooth surfaces, such as concrete, plate glass and metal, reflect acoustic energy and create reverberation that SoftZone panels help to absorb.

Why SoftZone®

SoftZone improves acoustics by enhancing speech clarity where needed and by preventing people's conversations from disturbing other people. Here are the main benefits to combining sound attenuation and architectural lighting using SoftZone integrated solutions.



Affordability

Less costly than building separate acoustic tile ceilings.



Design Flexibility

Horizontal and vertical options, building system integration possibilities, large choice of colors and design-friendly shapes.



Layering

Leverage the design capabilities of SoftZone horizontal and vertical solutions to modulate layers of sound attenuation in addition to layers of light (ambient, accent, MikroLite®).



Scalability

Add SoftZone panels in step with the development needs of any space.



Adaptability

Create neighborhoods of noise control by using SoftZone where you need sound attenuation.



Cost-effective Retrofits

Stencil SoftZone panels can be easily reconfigured or added to existing Stencil Pendant layouts.

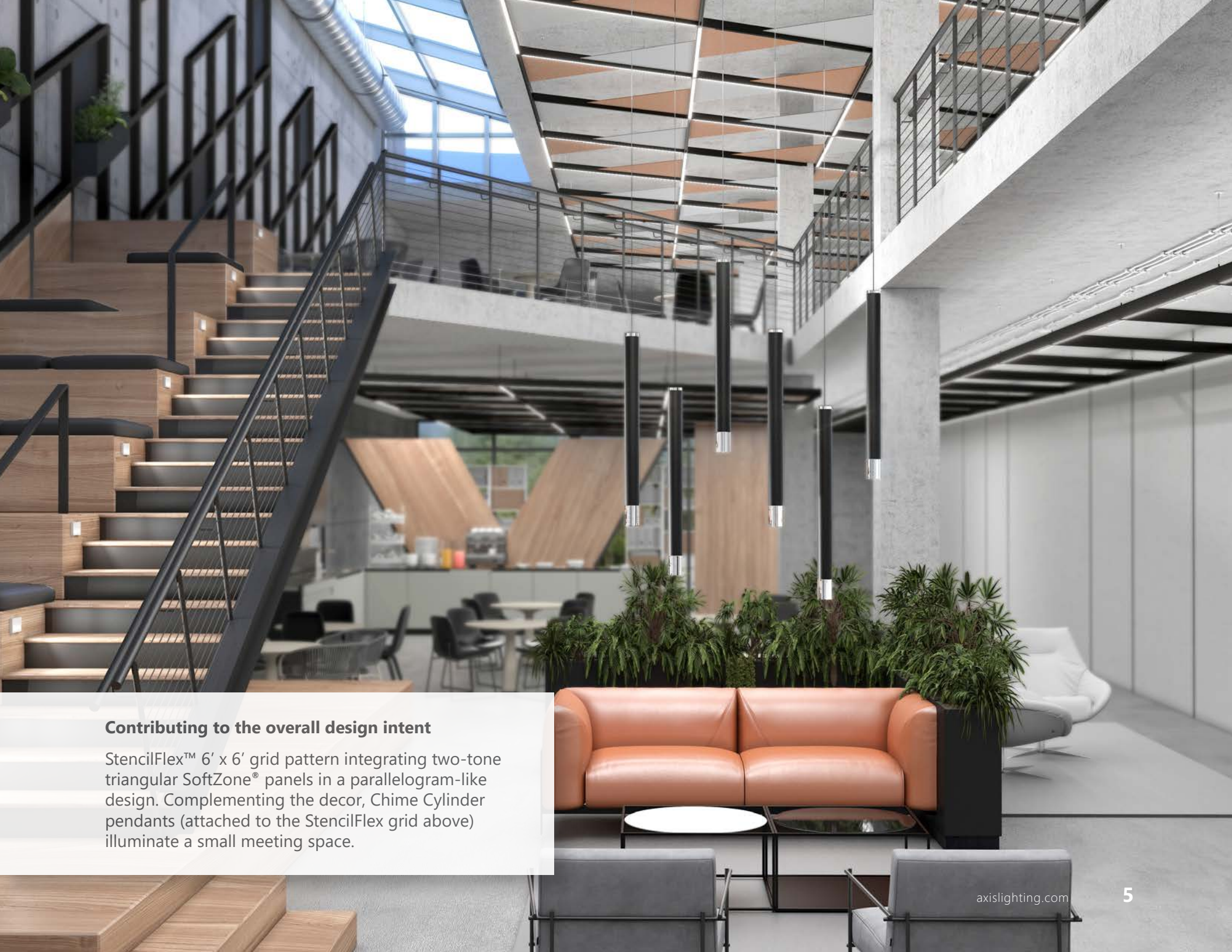

Contributing to the overall design intent

StencilFlex™ 6' x 6' grid pattern integrating two-tone triangular SoftZone® panels in a parallelogram-like design. Complementing the decor, Chime Cylinder pendants (attached to the StencilFlex grid above) illuminate a small meeting space.



2' x 5' Spatial SoftZone® continuous zigzag form (ZZ135) with, in the background, Stencil® SoftZone square and rectangular panels set in a Mondrian pattern.

All-new Spatial SoftZone forms add a playful element to linear acoustical baffling.

SoftZone® at a glance

Use SoftZone to create neighborhoods of intimacy, whether you need more privacy in collaborative spaces, improved speech clarity in conference rooms or less reverberation in an area.

SoftZone is a flexible sound-absorbing pendant lighting design system available in Horizontal (Stencil®, StencilFlex™) and Vertical (Spatial) forms, as well as Vertical linear solutions (Spatial and Sculpt™). It features a modular approach that lets you vary the quantity of panels to achieve the desired level of sound attenuation.

- ✓ Panels made of 100% polyester containing at least 40% of recycled PET plastic
- ✓ Functional flexibility: Unlit SoftZone panels can be used for sound attenuation only
- ✓ Facilitates building system integration (sprinklers, speakers, etc.)
- ✓ Class A fire rated and moisture resistant
- ✓ Per-unit Noise Reduction Coefficient (NRC): up to 1.05
- ✓ 15 standard colors to choose from (see page 8) – custom colors available

Color palette

Standard Palette



When ordering SoftZone panels in Standard colors, you can order matching SoftZone luminaire housings for a coordinated look. Housing colors (RAL, HSS & PMS codes) come in matte or glossy finishes depending on selected color. Consult your Axis representative for details.

Extended Custom Palette



Extended custom color palette panels available upon request. Consult your Axis representative for details.



2'x2', 4'x4', 2'x4' and 2'x6' Stencil® SoftZone® square and rectangular panels

Rectangular Stencil forms accept SoftZone panels in a Mondrian pattern featuring a mix of colors that matches interior design elements.

Vertical solutions: Spatial SoftZone®

Creative acoustic lighting

All-new Spatial SoftZone features the thin 1" aperture, proven lighting performance and superior design flexibility of Stencil®. Choose from an assortment of unique 3D elements, including linear solutions, squares, zigzags, open shapes and continuous forms.

Lighting flexibility

Spatial SoftZone offers a full range of lighting distributions, including direct, indirect and edge lighting configurations, a first in vertical acoustic lighting. In addition to sending light in different directions, you can have fully unlit segments.

Architectural adaptability

Segments and panels come in varying lengths (up to 7' standalone) and heights (up to 3'), extending the possibilities for coordinated layouts. Hairline panel joints make for practically seamless continuous runs, enhancing architectural integration.



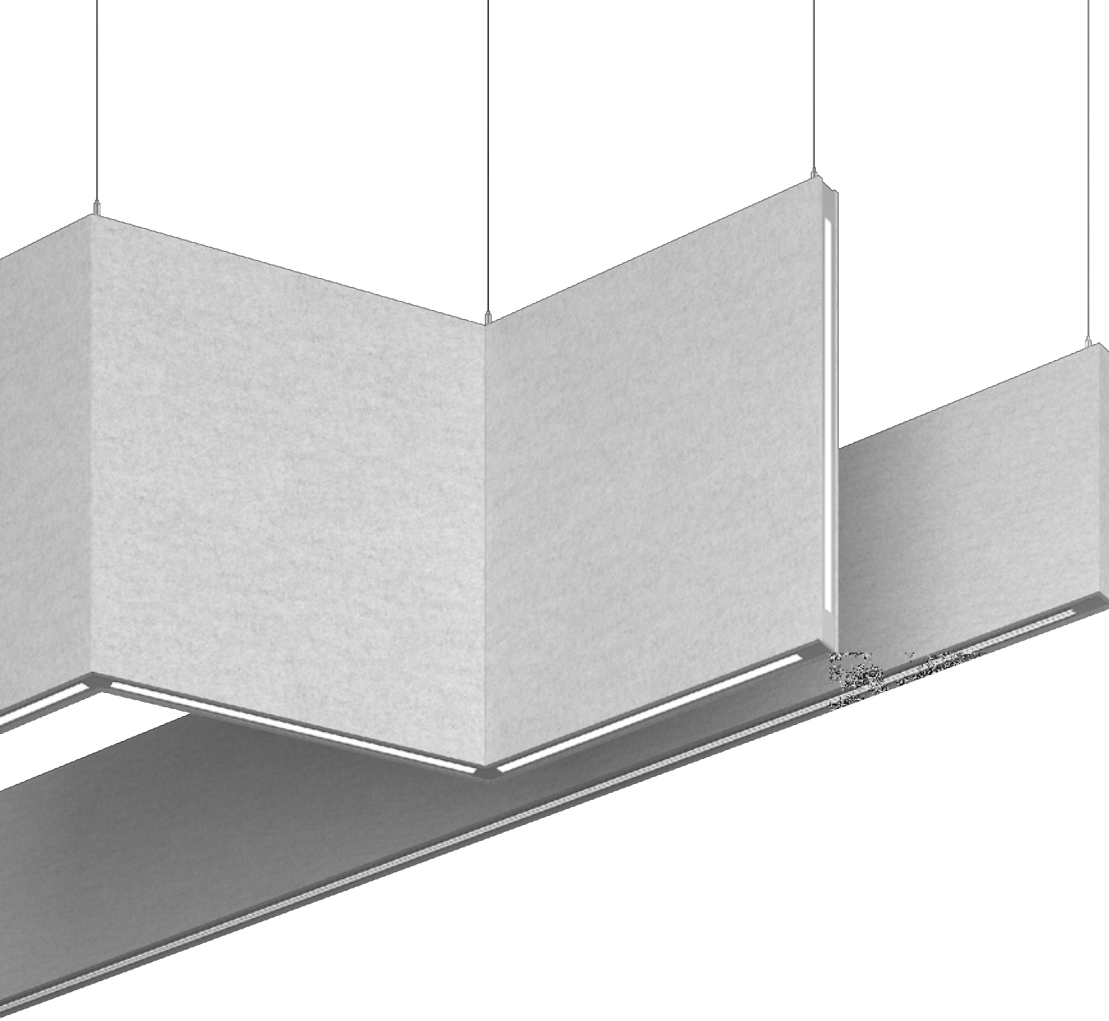

2' and 3' Spatial SoftZone® square forms (SQ90)

Compelling 3D concepts in their own right, Spatial SoftZone elements can be used individually or alongside other forms to create harmonized configurations.



Spatial SoftZone® **Choice of optics**

- ✓ Choice of direct, indirect (SurroundLite™ ) and Edge lighting
- ✓ Use blanks to create fully unlit acoustic panels
- ✓ Integral mini-driver 
- ✓ Controls available

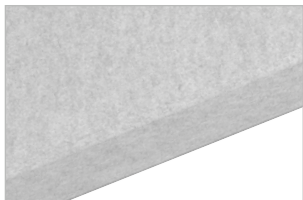

Blank

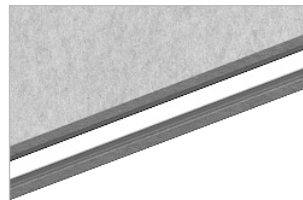

Spotless lens

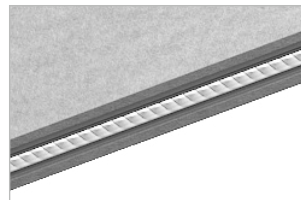

Louver

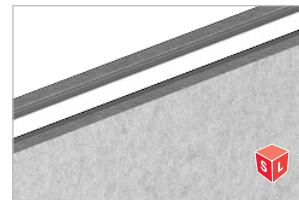

Indirect

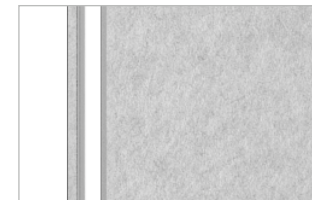

Edge lighting option

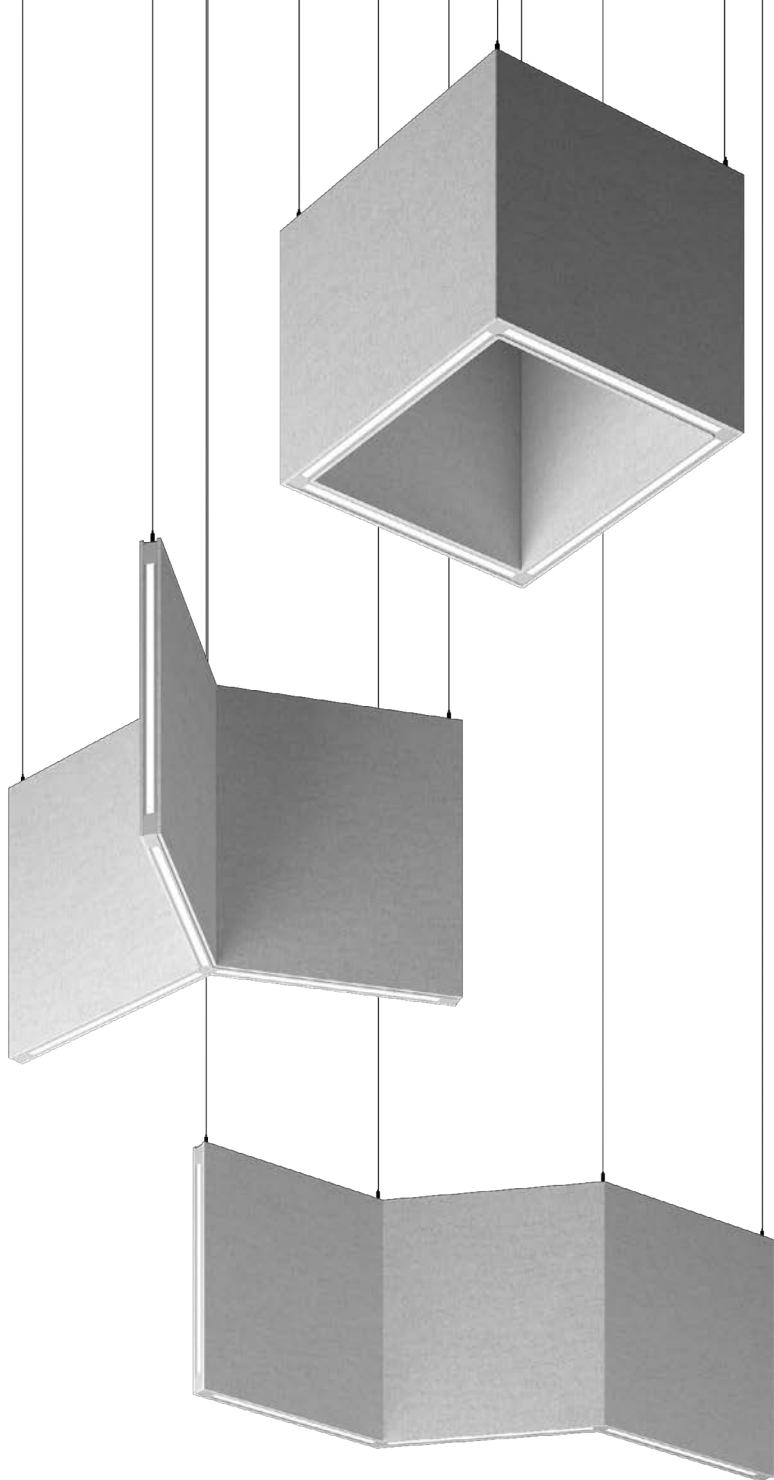

Spatial SoftZone® **Choice of 3D designs**

Easy-to-assemble kits for the 3D element specified include all the required Hubs, segments, acoustic panels and lighting hardware. Segments: Black, white, aluminum paint – custom finishes available.

- ✓ Linear Solutions
- ✓ Standard Forms
- ✓ Continuous Forms

Spatial SoftZone®

Linear Solutions

- ✓ Panel lengths: 2' to 7' (longer system runs available)
- ✓ Panel heights: 8", 12", 18", 24", 36"
- ✓ Lit edge available only for 24", 36" panel heights
- ✓ Unlit edge available for all heights





3' x 7' Spatial SoftZone® linear solutions

Develop signature lighting designs that add rhythm and enhance architecture with long arrays of Spatial linear solutions.

Spatial SoftZone®

Standard Forms

SQ90 – Square

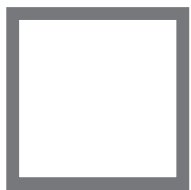

L90



Y120

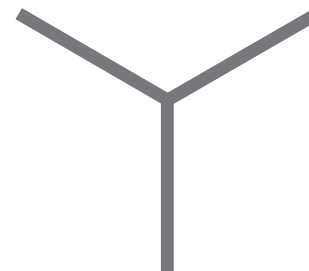

T90



X120

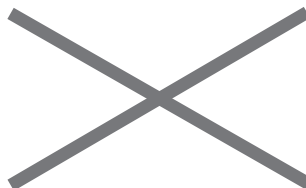

X90

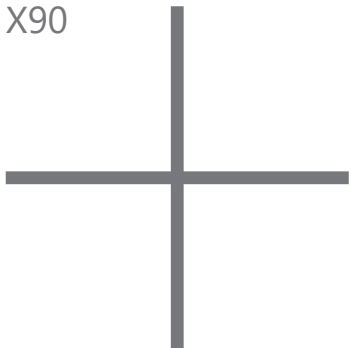

V120



V135



Z120



Z135



Choice of 2' or 3' segments. Unlit edge available for all heights.

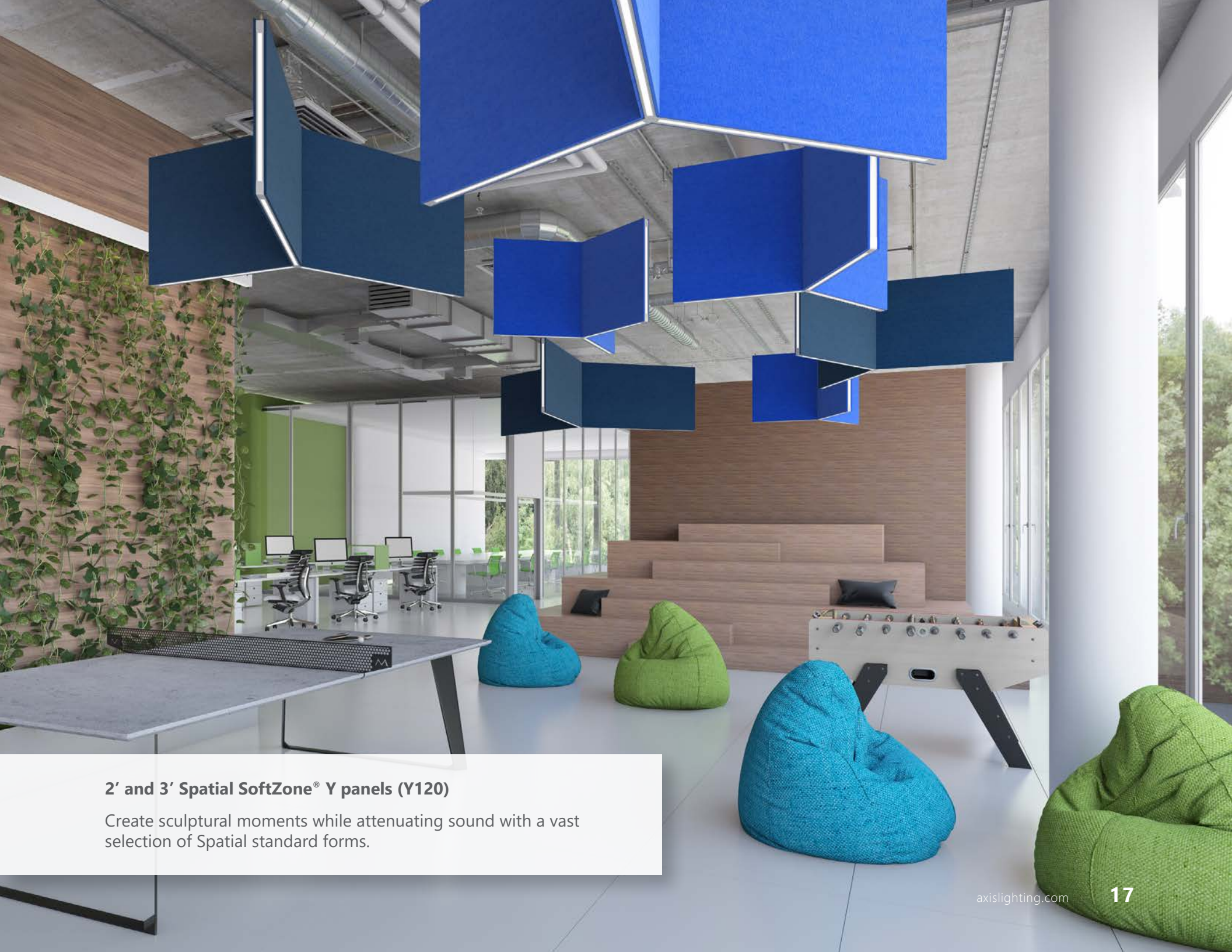

2' and 3' Spatial SoftZone® Y panels (Y120)

Create sculptural moments while attenuating sound with a vast selection of Spatial standard forms.

Spatial SoftZone®

Continuous Forms

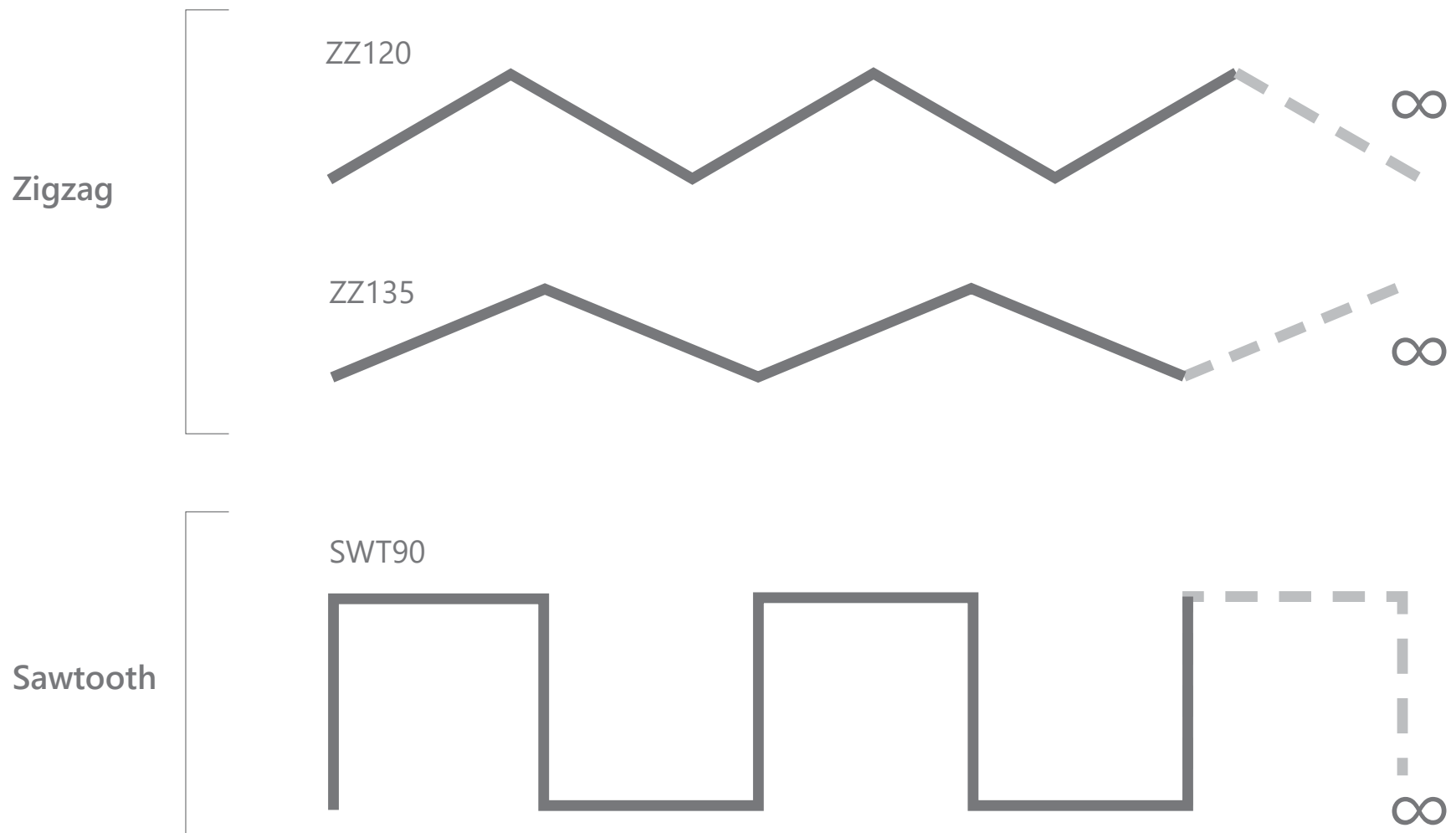



2' x 5' Spatial SoftZone® zigzag forms (ZZ135)

Spatial continuous forms let you create coordinated designs using original non-linear arrays.

Vertical solutions: Sculpt™ SoftZone®

Linear creativity

Combine SoftZone vertical panels with Sculpt Pendant luminaires to design appealing acoustic lighting environments that add linear rhythm while softening ambient noise levels. Now available in long continuous runs (longer than 8') with minimal hairline joints.

Lit and unlit panels

Integrate lighting and sound attenuation as required in your lighting concepts by alternating between lit and unlit Sculpt SoftZone panels (see opposite).

An elegant frame and a flush appearance

The top of SoftZone vertical panels is level with the uplight optics of Sculpt Pendant luminaires, providing true indirect lighting and a sophisticated architectural esthetic.



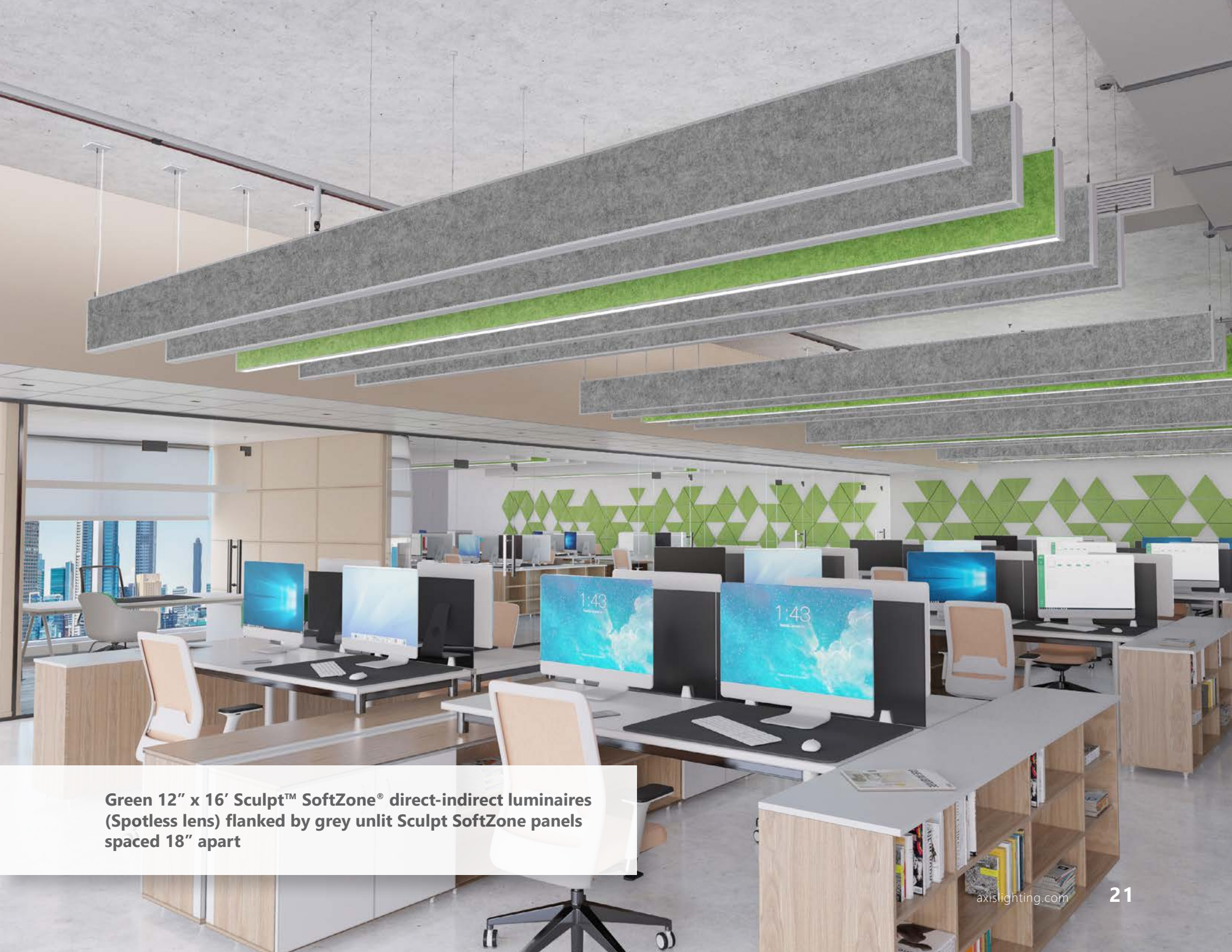

Green 12" x 16' Sculpt™ SoftZone® direct-indirect luminaires (Spotless lens) flanked by grey unlit Sculpt SoftZone panels spaced 18" apart

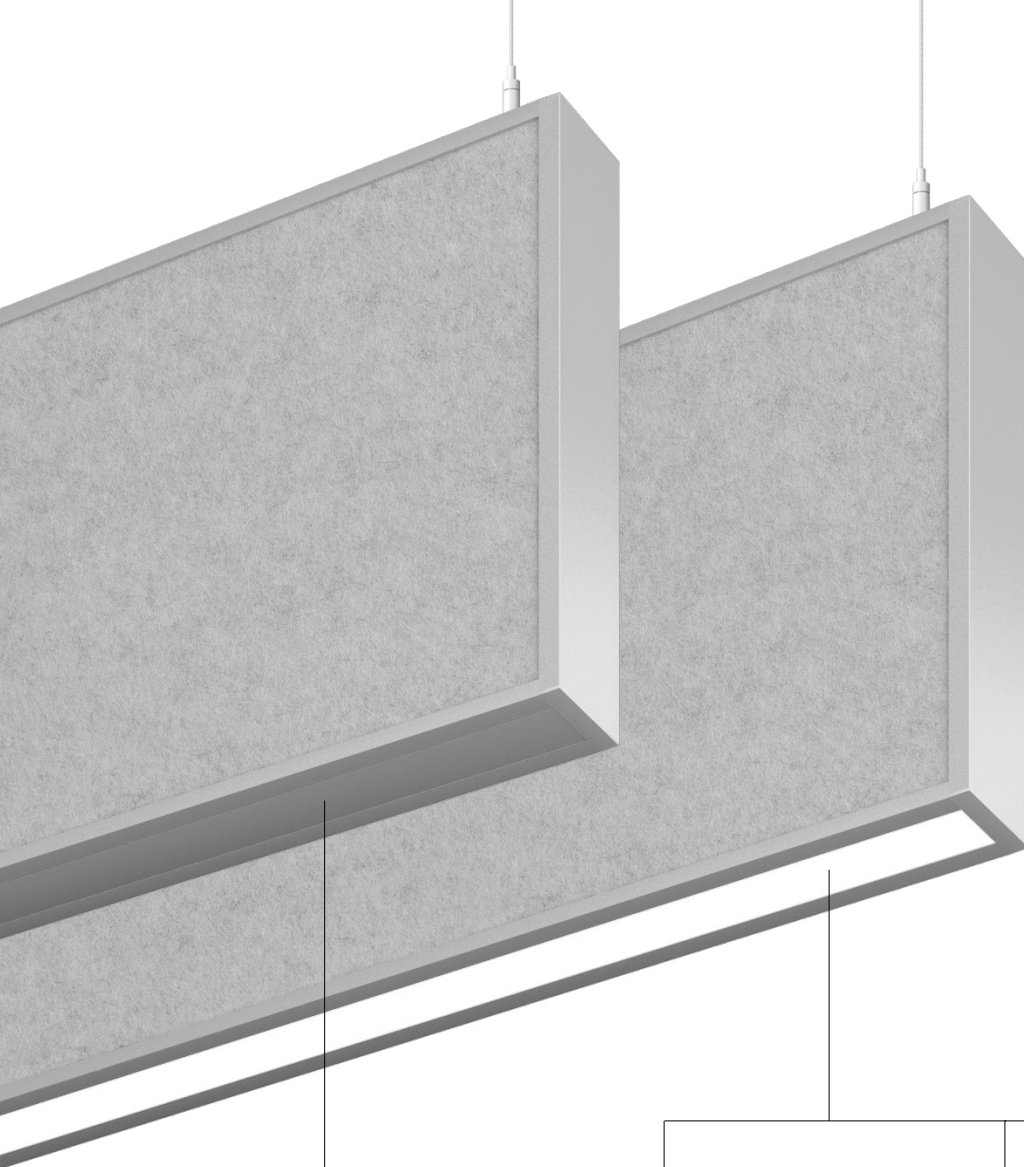

Sculpt™ SoftZone® Choice of optics

- ✓ Range of light distributions:
Direct, Indirect, Direct/Indirect
- ✓ Use blanks to create unlit SoftZone panels
- ✓ Integral driver
- ✓ Controls available, including Axitune® 

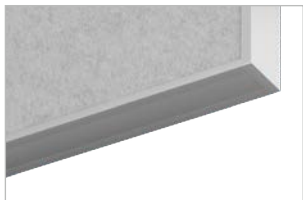

Blank or Indirect

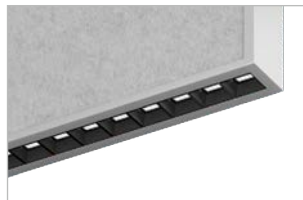

MikroLite® 1.5

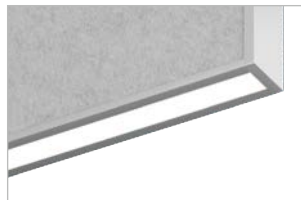

Spotless lens

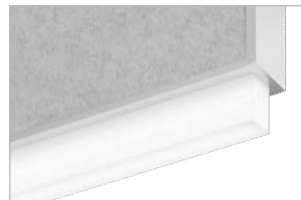

StepLens (0.5" and 2")

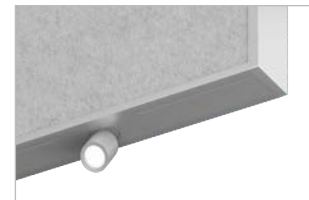

Accents

Sculpt™ SoftZone®

Choice of panel lengths and heights

- ✓ Panel lengths: 2' to 8'
- ✓ Long continuous runs available
- ✓ Panel heights: 8", 12"
- ✓ Linear lengths only (Geometric lighting forms not available with Sculpt SoftZone)
- ✓ Segments: Black, white, aluminum paint - custom finishes available

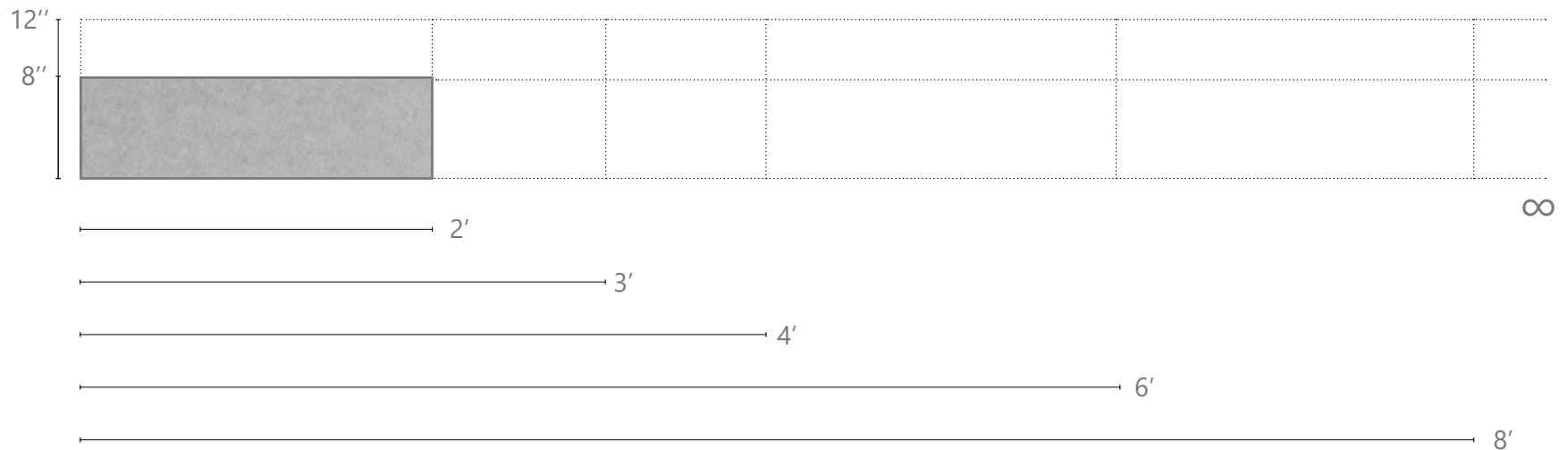



Horizontal solutions: Stencil® SoftZone®

Discreet scalability

Horizontal forms provide effective sound absorption while reducing visual clutter. Stencil® Pendant solutions let you create appealing, dynamic geometries using a wide selection of scalable shapes and sizes.

Design flexibility

Horizontal SoftZone panels capitalize on the exceptional design freedom of Stencil Pendant. Together, they provide an effective, one-of-a-kind design tool for creating a wide variety of forms and patterns.

- ✓ Layer lighting using a wide range of optics, segments, Hubs and lighting controls.
- ✓ Layer sound attenuation using open and closed forms featuring full or partial paneling, as well as unlit SoftZone panels.
- ✓ Integrate building systems (e.g. sprinklers, ventilation) by creating openings through and between SoftZone panels.

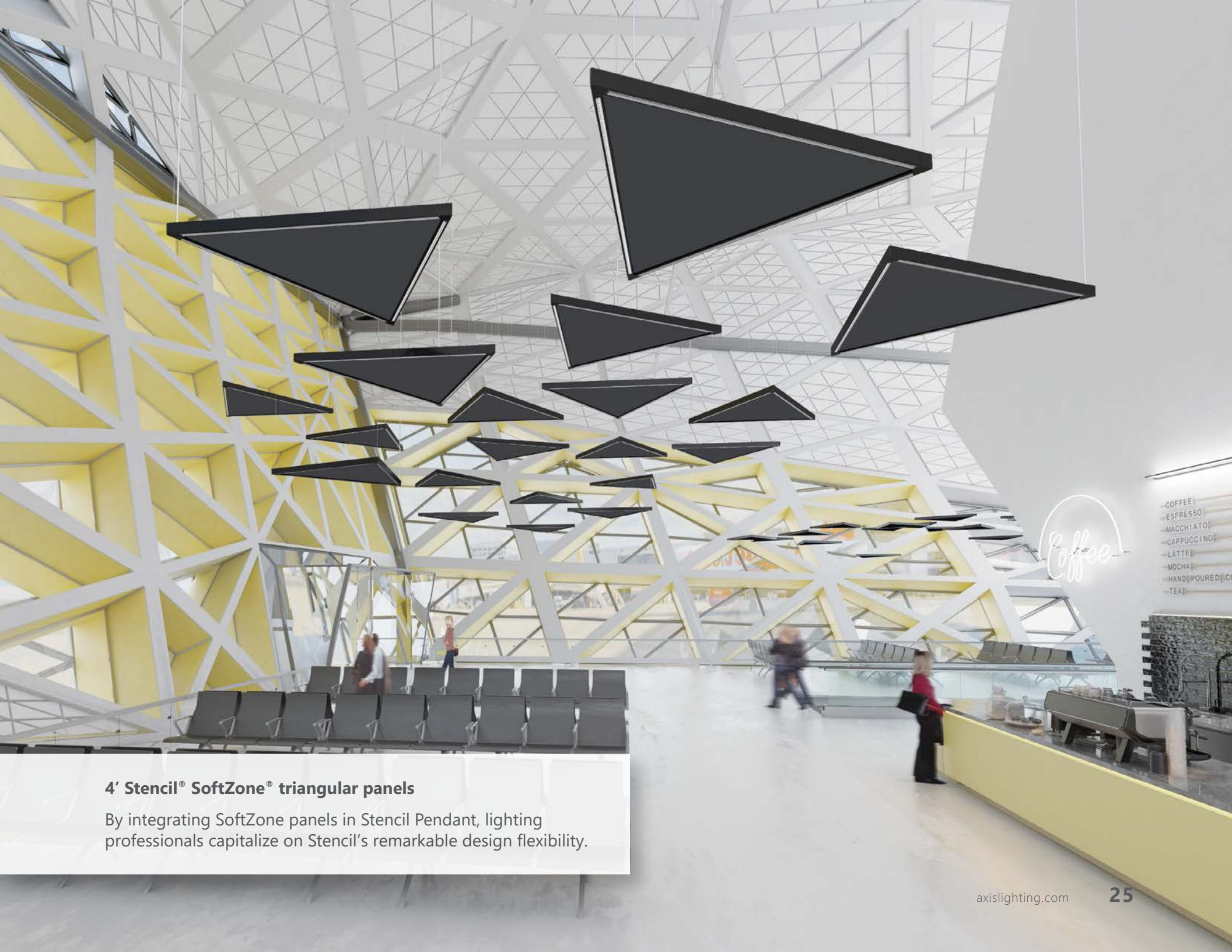

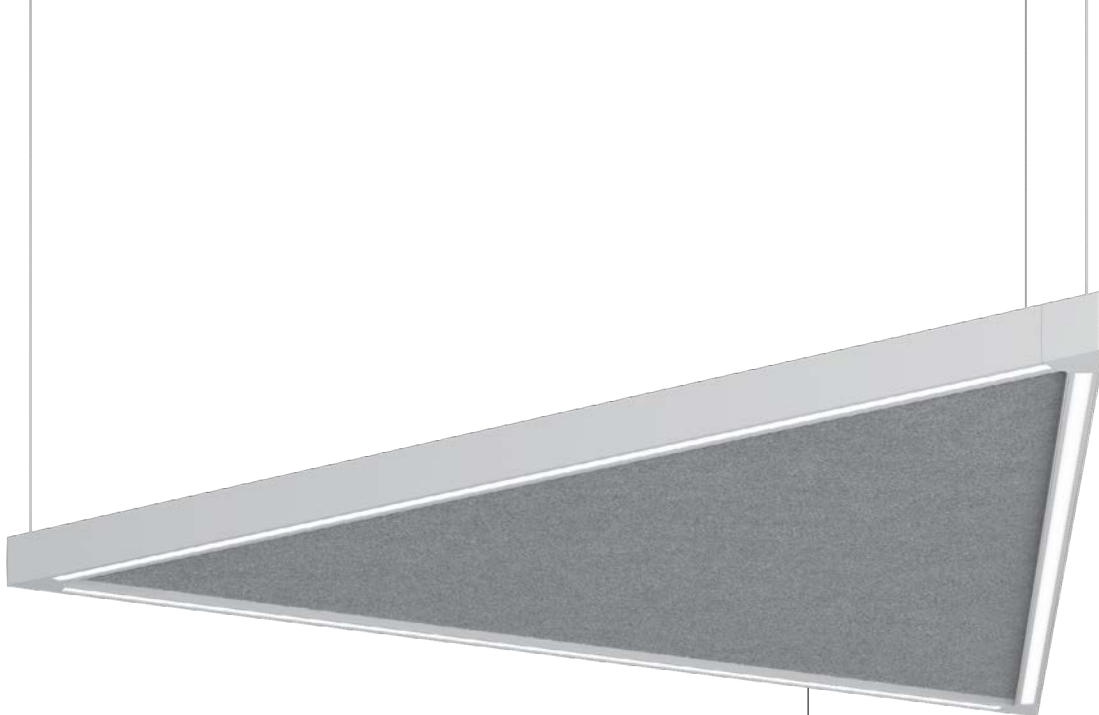

4' Stencil® SoftZone® triangular panels

By integrating SoftZone panels in Stencil Pendant, lighting professionals capitalize on Stencil's remarkable design flexibility.



Stencil® SoftZone® Choice of optics

- ✓ Choice of Direct, Indirect or Direct-Indirect
- ✓ Indirect: SurroundLite™ sym. or asym. 
- ✓ Use blanks to create unlit SoftZone panels
- ✓ SoftZone retrofits available
- ✓ Integral mini-driver  (remote for DI)
- ✓ Controls available

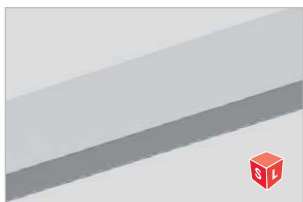

Blank or Indirect

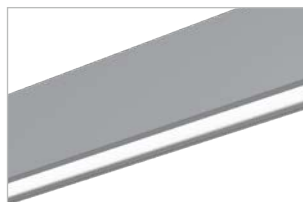

Spotless lens

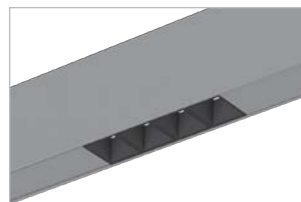

MikroLite® 1.0

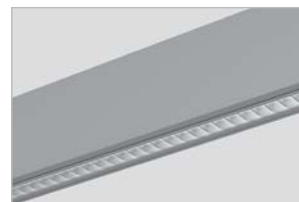

Louver

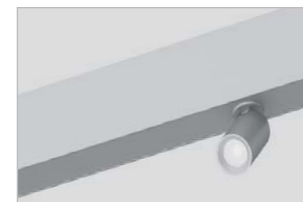

Accents

Stencil® SoftZone® Choice of panel forms

Horizontal SoftZone panels are compatible with a wide variety of Stencil Pendant forms and patterns. Segments: Black, white, aluminum paint – custom finishes available.

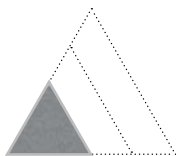

Triangle 60°

2', 3' and 4' section lengths

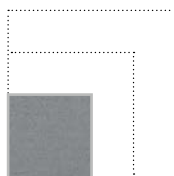

Square

2' x 2', 3' x 3', 4' x 4'

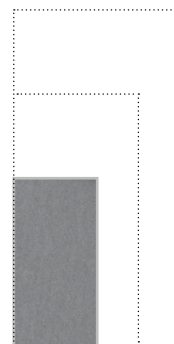

Rectangle

2' x 8' 3' x 8' 4' x 8'
2' x 7' 3' x 7' 4' x 7'
2' x 6' 3' x 6' 4' x 6'
2' x 5' 3' x 5' 4' x 5'
2' x 4' 3' x 4'
2' x 3'



Segmented Hexagon

2', 3' and 4' section lengths

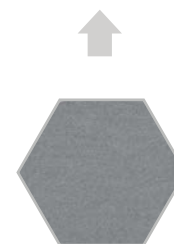





Hexagonal

2' full hexagon







Stencil® SoftZone® Choice of Hubs

Hubs are patented, non-illuminated die-cast joiners featuring soft corners. These connectors are the building blocks for creating Stencil forms and patterns of all sizes.

Series A

90°	
120°	
180°	
End cap	

Series B

60°		180°	
120°		End cap	
60°/120°			
120°/60°			

Note: Forms require configuration drawings. Consult your Axis Lighting representative for assistance.

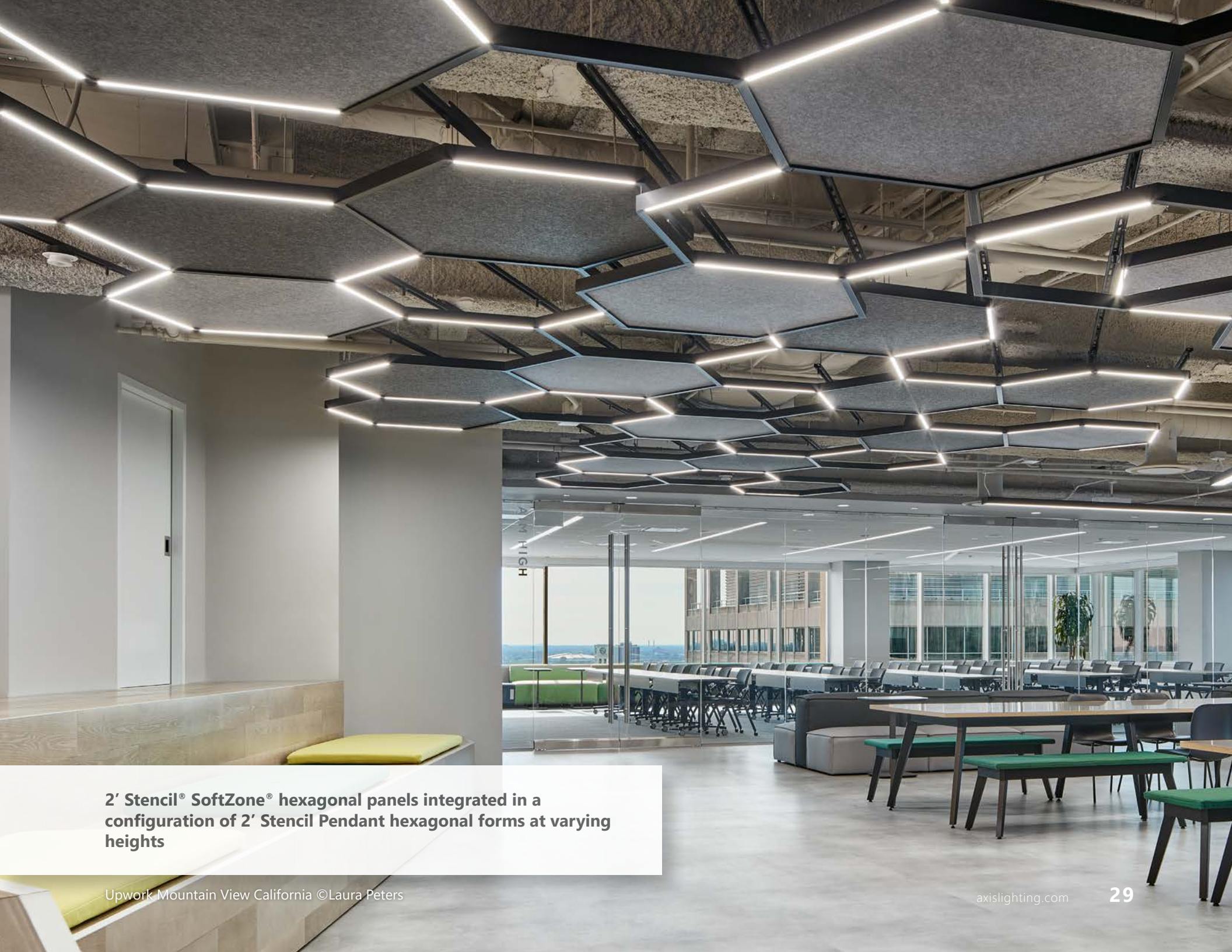

2' Stencil® SoftZone® hexagonal panels integrated in a configuration of 2' Stencil Pendant hexagonal forms at varying heights



Horizontal solutions: StencilFlex™ SoftZone®

Discreet scalability

Horizontal forms provide effective sound absorption while reducing visual clutter. StencilFlex™ solutions let you create appealing, dynamic geometries using scalable frameworks able to integrate triangular-shaped SoftZone panels.

Design flexibility

StencilFlex is a simple, cost-effective pendant delivery system for layers of light and sound attenuation, wherever they are required in a space. This horizontal SoftZone solution features exceptional design freedom based on the Stencil® form factor.

- ✓ Layer lighting using a wide range of optics, segments, StencilFlex Hubs and lighting controls, including Empower wireless.
- ✓ Layer sound attenuation using frameworks featuring colorful triangular paneling, as well as unlit SoftZone panels.
- ✓ Integrate building systems (e.g. sprinklers, ventilation) by creating openings through and between SoftZone panels.



Playful SoftZone panelling

StencilFlex 4' x 4' framework pattern with two-tone triangular SoftZone panels. Luna Orb pendants and Stella spots on AxisTrak™ lighting inserts complement the lighting design.



StencilFlex™ SoftZone® Choice of optics

- ✓ Choice of Direct, Indirect or Direct-Indirect
- ✓ Direct optics: Louver (60 or 70), Flush, Regressed, MikroLite®, Wall Wash
- ✓ Use blanks (flush, regressed) to create unlit SoftZone panels
- ✓ Integral mini-driver [!\[\]\(95b42f0077faf7439a26242a54e021ec_img.jpg\)](#)
- ✓ Controls available, including Empower wireless



Blank or Indirect

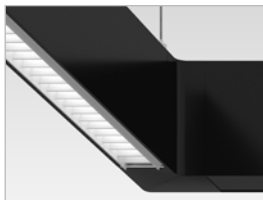

Louver (60 or 70)

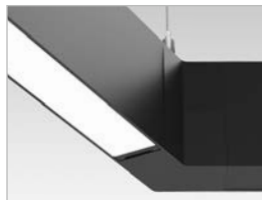

Flush

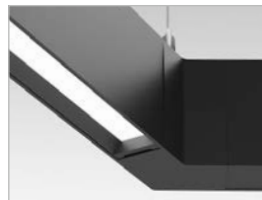

Regressed

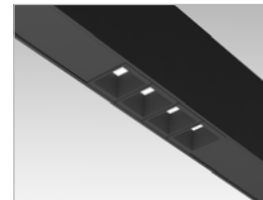

MikroLite®



Wall Wash

StencilFlex™ SoftZone®

Choice of panel forms

Triangular-shaped horizontal SoftZone panels available for insertion in StencilFlex frameworks. Segments: Black, white, aluminum paint – custom finishes available.

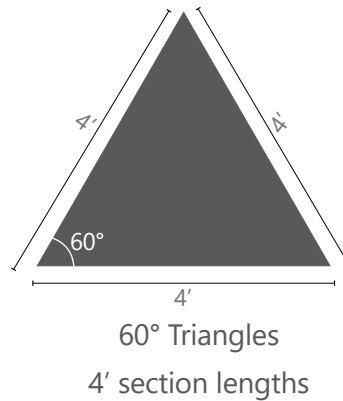
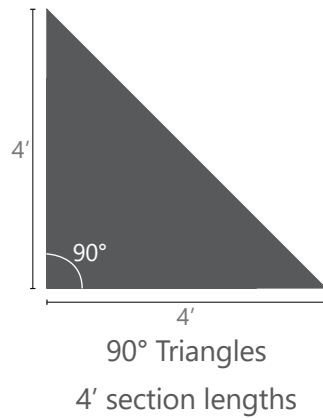

StencilFlex™ SoftZone®

Choice of Hubs

StencilFlex Hubs are patented, non-illuminated die-cast joiners featuring soft corners. These connectors are the key to StencilFlex flexibility, allowing you to create forms and patterns of all sizes.



Note: Forms require configuration drawings. Consult your Axis Lighting representative for assistance.

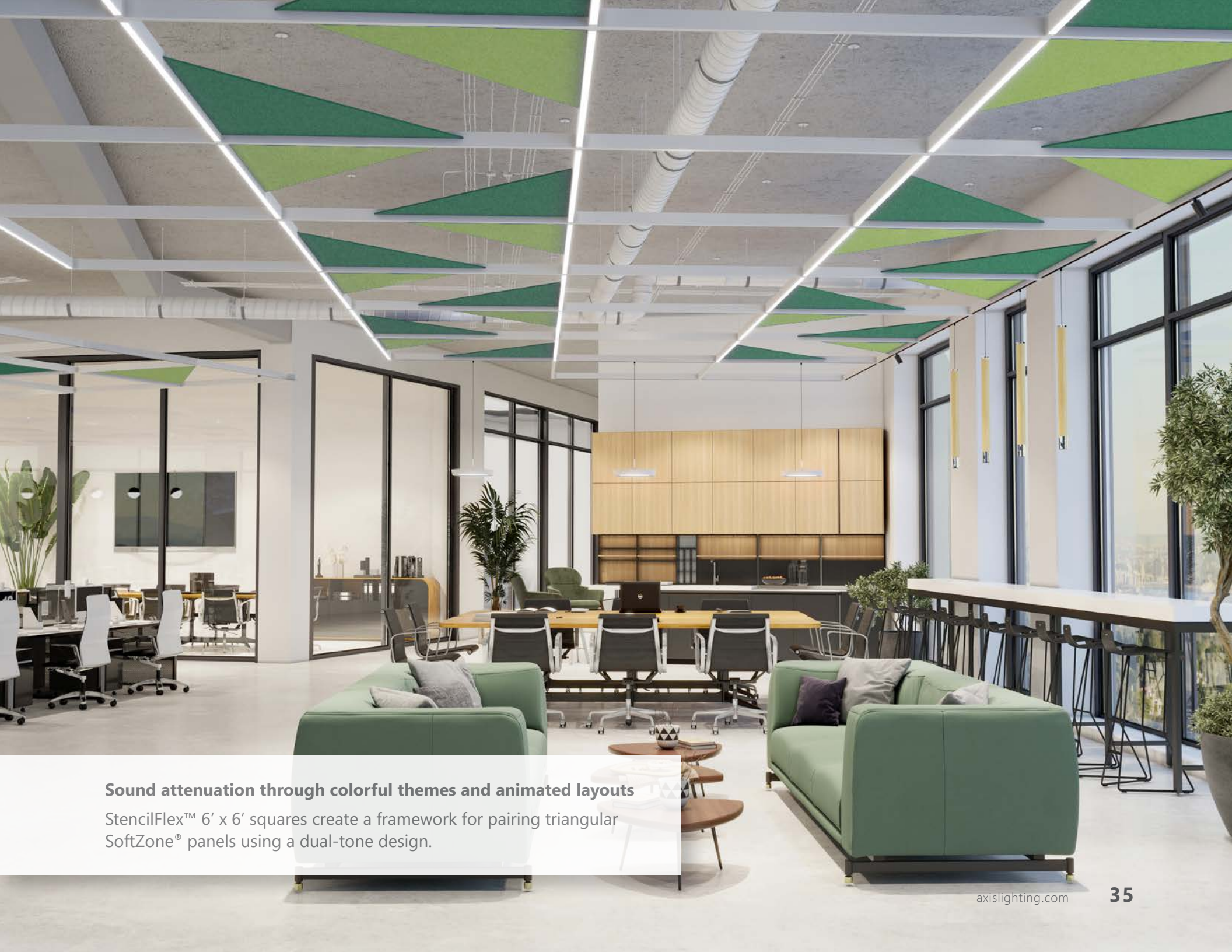

Sound attenuation through colorful themes and animated layouts

StencilFlex™ 6' x 6' squares create a framework for pairing triangular SoftZone® panels using a dual-tone design.



12" x 6' Sculpt™ SoftZone® panels spaced 18" apart with lighting provided by Sculpt Direct-Indirect optics (Spotless lens, MikroLite®)

Sculpt SoftZone lets you create a design motif while increasing sound absorption by alternating lit panels (in blue) with unlit sound-attenuating panels (in grey).



2' Stencil® SoftZone® hexagonal panels

**8' Sculpt™ SoftZone® Direct luminaires (flush lens) and
12" x 8' unlit Sculpt SoftZone panels spaced 24" and 38" apart**

See the difference. Hear the difference.

Create your very own SoftZone® solution.

Design the optimal sound-attenuation layout with
the assistance of your Axis representative.

Consult spec sheets at axislighting.com

Order color panel samples at
axislighting.com/resources/softzone-samples



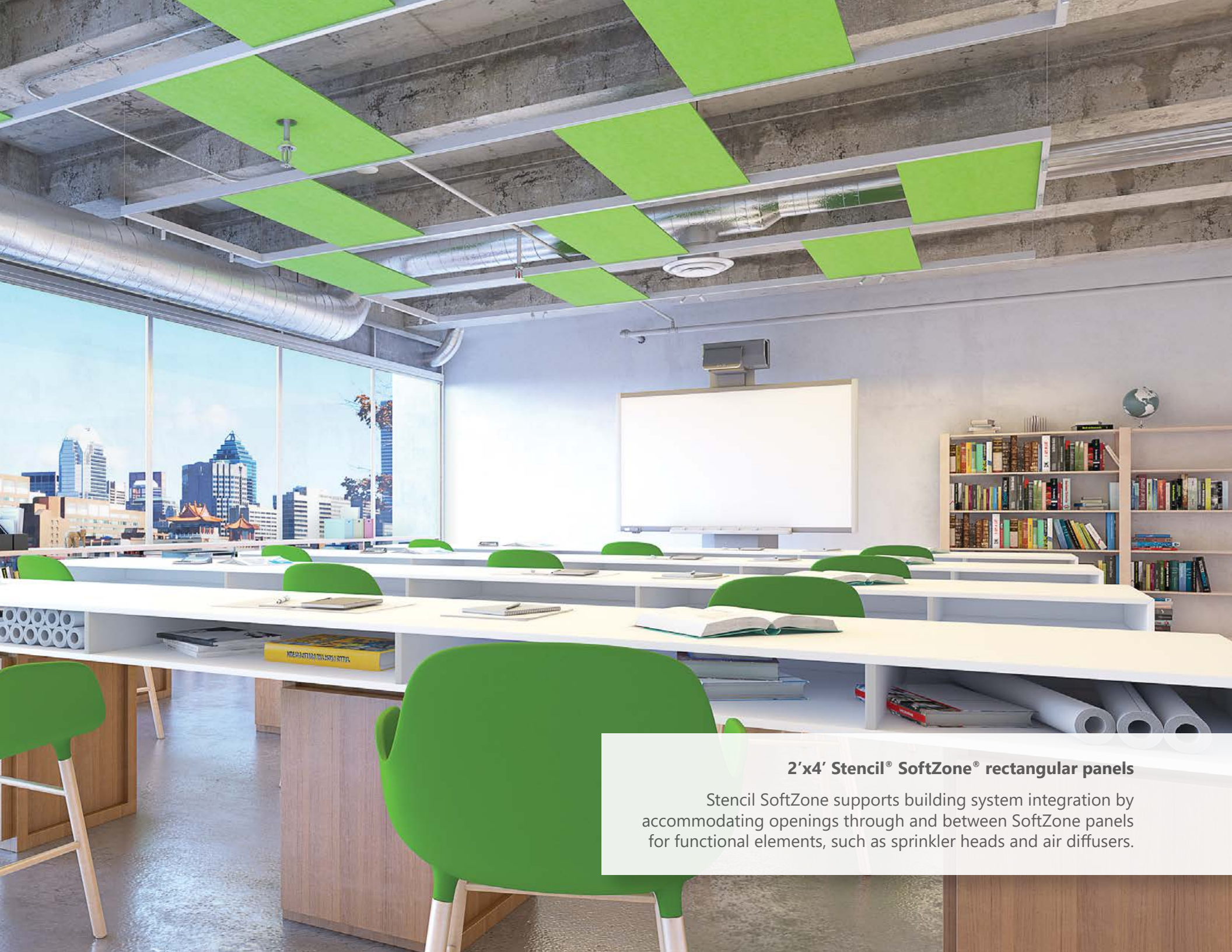

2'x4' Stencil® SoftZone® rectangular panels

Stencil SoftZone supports building system integration by accommodating openings through and between SoftZone panels for functional elements, such as sprinkler heads and air diffusers.



About Axis Lighting

Founded in 1991 and still family owned and managed, Axis is an important source for architectural lighting across North America and around the globe.

Over the last decade, the company has exhibited remarkable growth thanks to its commitment to Design Flexibility, Optimal Energy Efficiency and Responsive Customer Care. That leadership effort now extends to developing Innovative Lighting Technologies, such as SurroundLite™, on an ongoing basis.

On the strength of a broad and expanding product line, Axis has successfully completed lighting projects for high-profile clients including Apple, Chrysler, The Empire State Building, Google, Hyundai, Time Warner and McGill University, among many others.

Axis has the drive and the expertise to meet your needs and provide architectural lighting... your way.



We reserve the right to change specifications without notice.
Please consult our website for the most current technical information
and to locate your nearest Axis representative.

1.800.263.AXIS T 514.948.6272 F 514.948.6271

axislighting.com

© 2021 Axis Lighting Inc. **THIRD EDITION**