

# WAVE LED 1x1 T-BAR INSTALLATION INSTRUCTIONS

## PART LIST

A	Tiles	F	BX connector
B	Brackets (4)	G	knockout plate
C	Drywall kit	H	Wire nuts
D	Fixture	I	Driver wires
E	Power feed BX cable (by others)		

## MASTER/SATELLITE CONNECTION\*

**Option A:** with a distance in between the two fixtures.

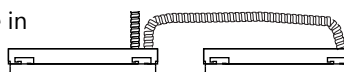

\* For easy access to the driver, refer to the website for the driver replacement instructions.

## SECTION VIEW

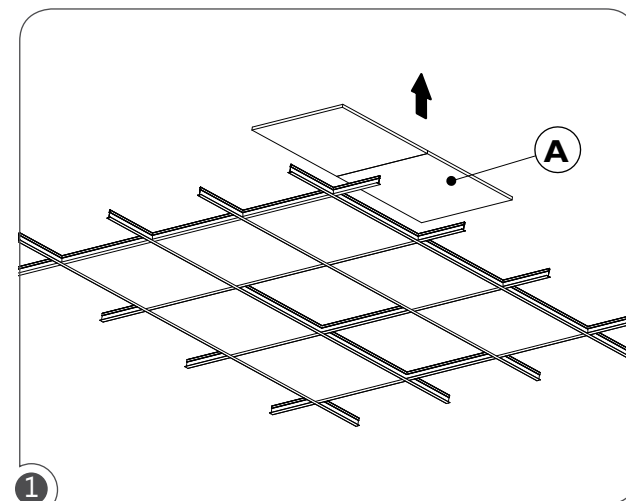
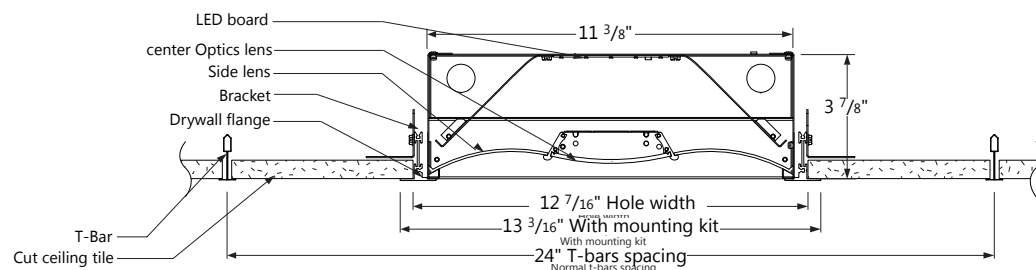

1 Remove the ceiling tiles (A) where the fixture will be installed and adjacent tiles for easy access when connecting the wires.

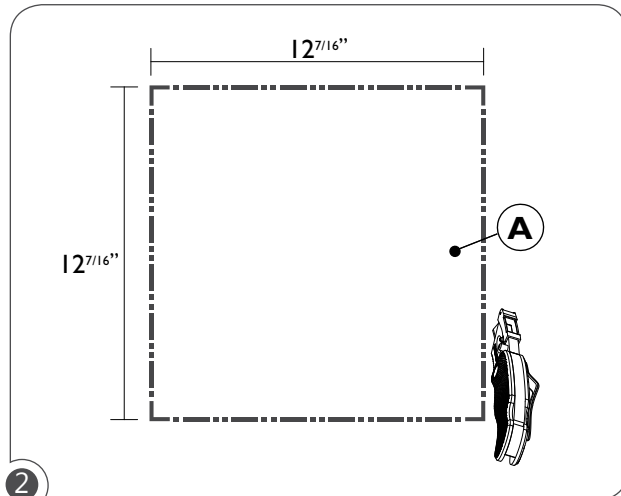

2 Cut the tile (A) with a utility knife according to the diagram and measurement located above. Make sure that the hole is centered and square.

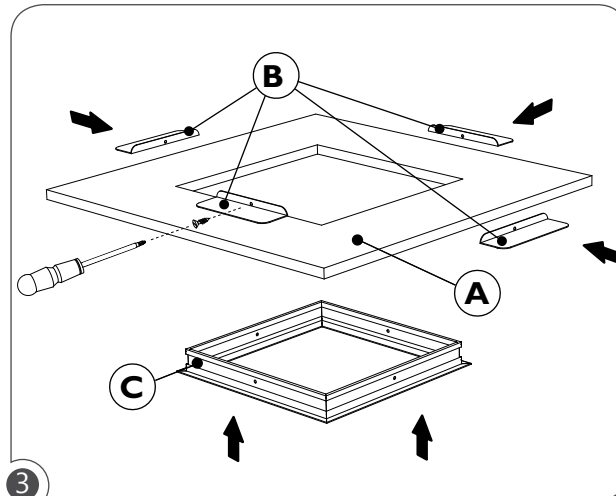

3 Insert the drywall flange into the hole and fix into place with the 4 brackets (B) and screws. Make sure that the drywall kit (C) is tight against the tile (A).

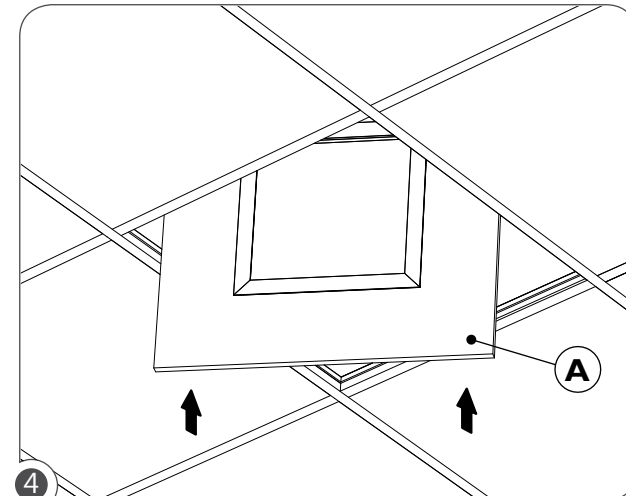

4 Insert the tile (A) into the Tbar grid.

FILENAME:LED.WAVE.11.TB.INST.indd April 7, 2014

ÉCLAIRAGE  
**axis**  
LIGHTING

1.800.263.AXIS  
[T] 514.948.6272  
[F] 514.948.6271  
www.axislighting.com



**WARNING:** RISK OF FIRE AND ELECTRICAL SHOCK. FIXTURE MUST BE INSTALLED BY A QUALIFIED ELECTRICIAN ONLY IN ACCORDANCE WITH NATIONAL, LOCAL BUILDING AND ELECTRICAL CODES. DISCONNECT POWER AT ELECTRICAL PANEL BEFORE SERVICING.



Product design and development is an ongoing process at Axis Lighting. We reserve the right to change specifications. Contact Axis for the latest product information.

© 2010 Axis Lighting Inc.

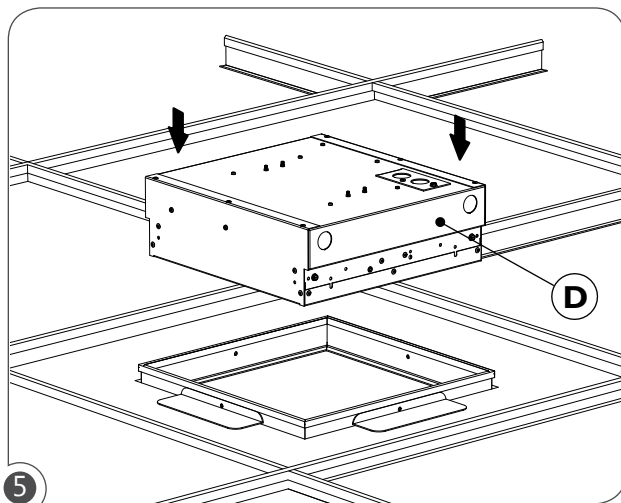

5 Insert the fixture (D) into the frame. Ensure that the fixture is correctly oriented in relation to other fixtures.

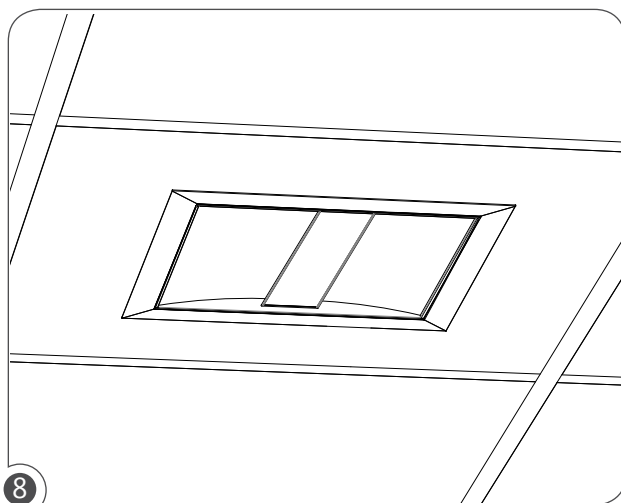

8 Test the fixture to ensure proper connections. Re-install the remaining tile to close the ceiling.

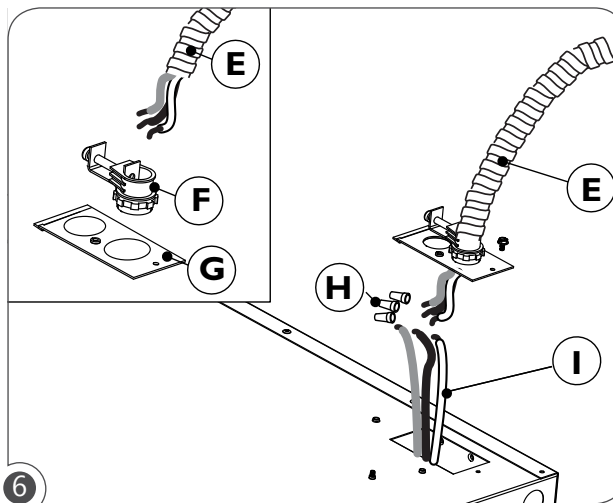

6 Remove knockout plate (G) and install BX connector (F) through the knockout plate (G). Insert BX cable (E) into BX connector (F). Fasten BX cable (E) to BX connector (F) by tightening screw. Connect wires from BX cable (E) to wires on driver (I) by using wire nuts (H). Ensure connections comply with local and national electrical codes.

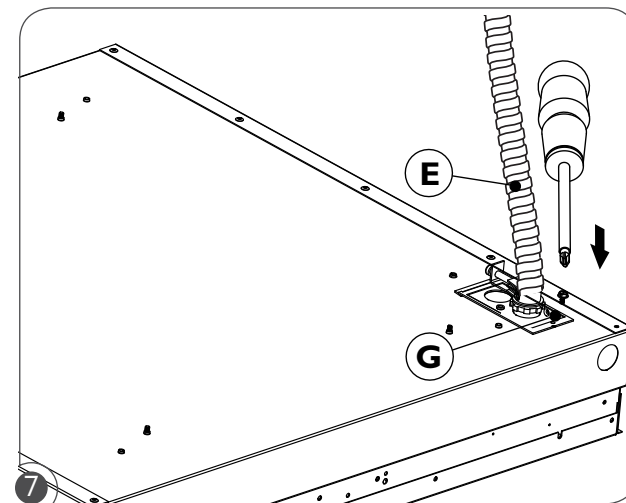

7 Push connected wires and wire nuts into fixture. Reinstall knockout plate (G) onto fixture by hooking tab into hole, and refastening screw to knockout plate and housing.



**WARNING:** RISK OF FIRE AND ELECTRICAL SHOCK. FIXTURE MUST BE INSTALLED BY A QUALIFIED ELECTRICIAN ONLY IN ACCORDANCE WITH NATIONAL, LOCAL BUILDING AND ELECTRICAL CODES. DISCONNECT POWER AT ELECTRICAL PANEL BEFORE SERVICING.

