

● POWER FEED

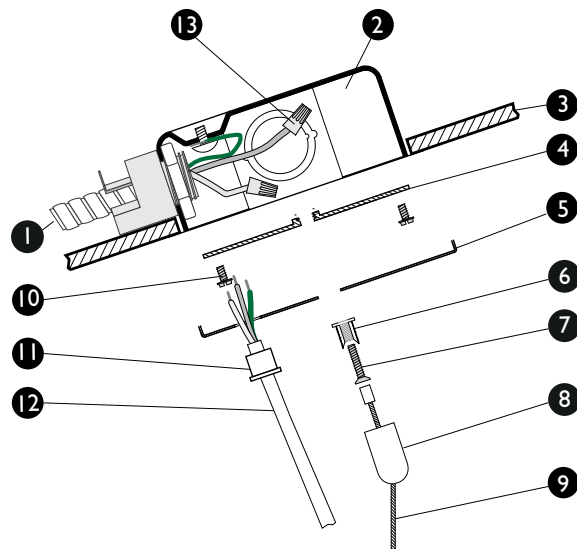

● NON POWER SUSPENSION

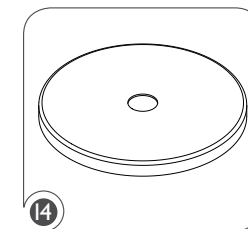
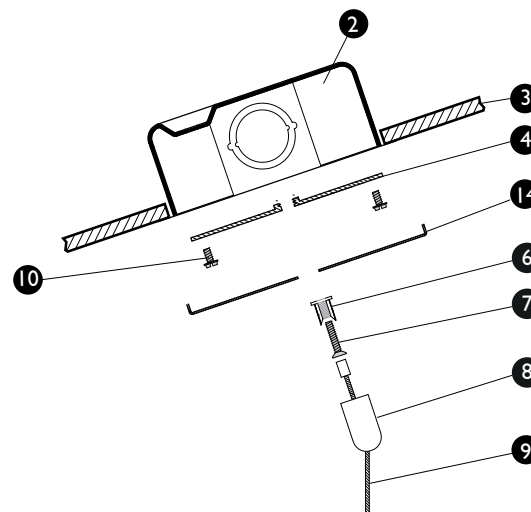

● PARTS LIST

- ① Armored cable & connector (by others)
- ② 4" octagon junction box (by others)
- ③ Ceiling surface material (by others)
- ④ Junction box crossbar
- ⑤ 4 1/4" canopy - power feed
- ⑥ Coupler cap
- ⑦ Coupler screw
- ⑧ Swivel coupler housing
- ⑨ Aircraft cable
- ⑩ Junction box crossbar screws
- ⑪ Plastic grommet
- ⑫ Power cord
- ⑬ Wire Nuts
- ⑭ 4 1/4" canopy - non power feed

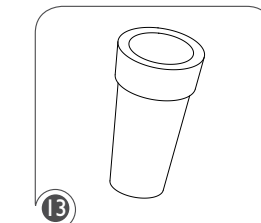
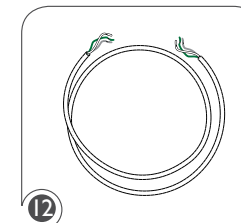
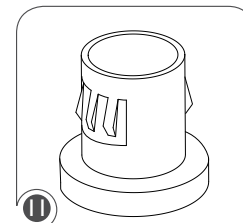
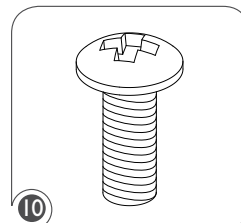
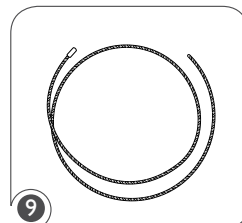
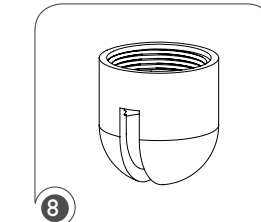
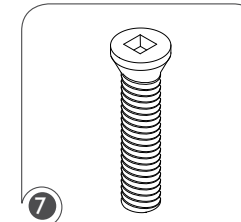
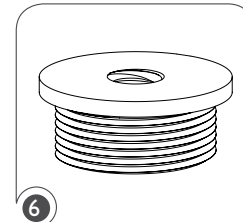
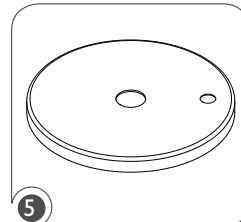
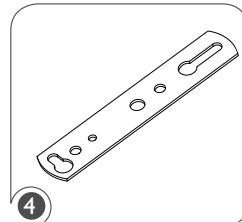

SA - C PENDANT FIXTURES - SLOPED CEILING MOUNTING GUIDE

SLOPE HEIGHT CEILING - STEM JUNCTION BOX

● POWER FEED

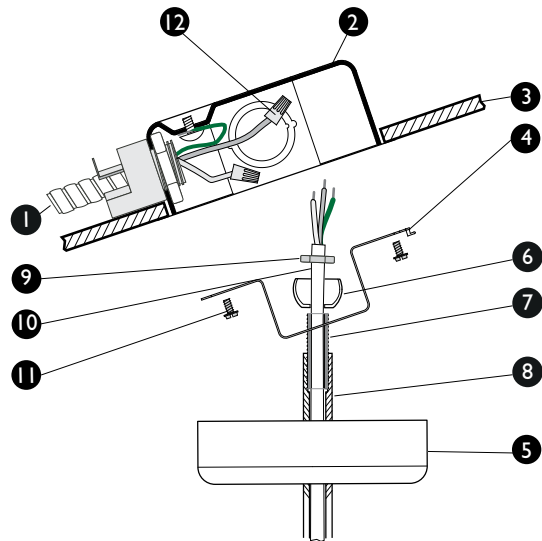

● NON POWER SUSPENSION

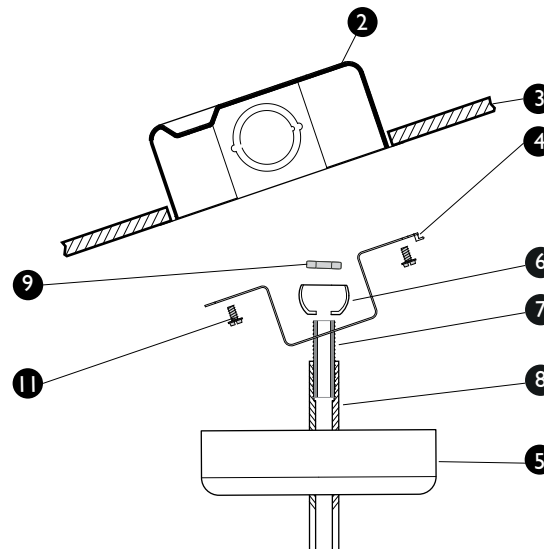

● PARTS LIST

- ① Armored cable & connector (by others)
- ② 4" octagon junction box (by others)
- ③ Ceiling surface material (by others)
- ④ Junction box crossbar
- ⑤ 4 1/4" Canopy - stem
- ⑥ Stem swivel ball
- ⑦ Stem 3/8" threaded nipple
- ⑧ Stem
- ⑨ Stem swivel nut
- ⑩ Power cord
- ⑪ Crossbar screw
- ⑫ Wire nut

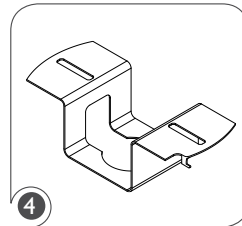

Junction box crossbar

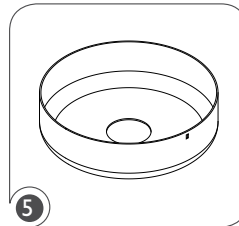

4 1/4" canopy - stem

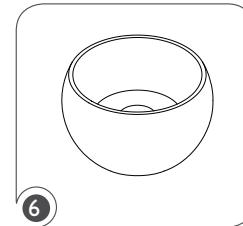

Stem swivel ball

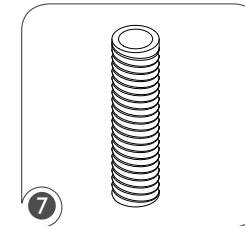

Stem 3/8" threaded nipple

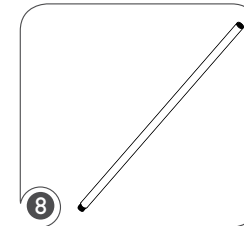

Stem

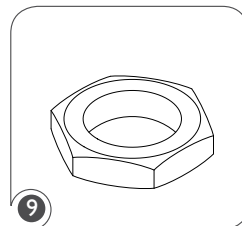

Stem swivel nut

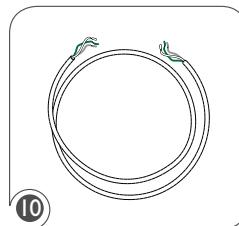

Power cord

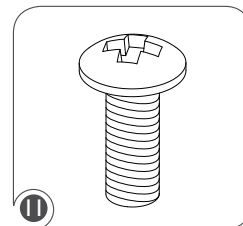

Crossbar screw

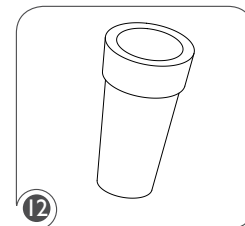

Wire nut

FILE NAME: PENDANT.SLOPED.MOUNT.GUIDE February 28, 2012

ÉCLAIRAGE
axis
LIGHTING

1.800.263.AXIS
[T] 514.948.6272
[F] 514.948.6271
www.axislighting.com

WARNING: RISK OF FIRE AND ELECTRICAL SHOCK. FIXTURE MUST BE INSTALLED BY A QUALIFIED ELECTRICIAN ONLY IN ACCORDANCE WITH NATIONAL, LOCAL BUILDING AND ELECTRICAL CODES. DISCONNECT POWER AT ELECTRICAL PANEL BEFORE SERVICING.



Product design and development is an ongoing process at Axis Lighting. We reserve the right to change specifications. Contact Axis for the latest product information.

© 2010 Axis Lighting Inc.