

# SkyePlane Regressed 2x2

Recessed T-Bar & Drywall

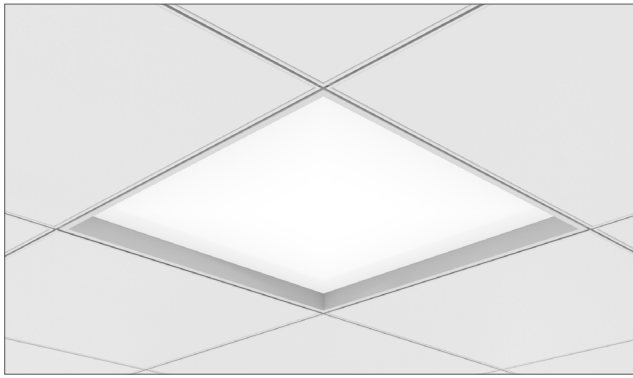

**Project** \_\_\_\_\_

**Type** \_\_\_\_\_

**Notes** \_\_\_\_\_

## PERFORMANCE AT 3500K

NOMINAL LUMEN OUTPUT	INPUT WATTS	EFFICACY
3500 lm	33.06 W*	106 lm/W

\* Based on a 1x1 foot luminaire using one driver

SIDE VIEW A

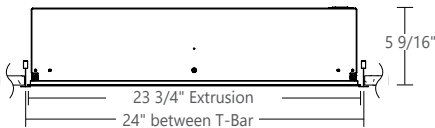

SIDE VIEW B

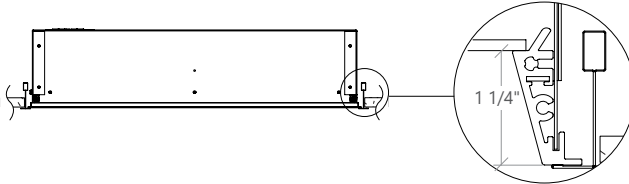

Axitune  
Tunable White



PoE



BIOS  
ILLUMINATION



## Ordering Guide

SKPA	22					SO	RE
PRODUCT ID	SIZE	TOTAL NOM. LUMENS		CRI	COLOR TEMP. (choose one)	SHIELDING	SHIELDING POSITION
SKPA SkyePlane Regressed	22 2'X2'	2100	2100 lm - Min	80	3000 K	SO spotless lens	RE regressed
		3500	3500 lm - Max at 90 CRI	90	3500 K		
		3900	3900 lm - Max at 80 CRI		4000 K		
					B30 3000 K - BIOS*		
					B35 3500 K - BIOS*		
					B40 4000 K - BIOS*		
					BTW2750 2700-5000 K - Tunable White		
					BTW2765 2700-6500 K - Tunable White		
					BTW3527 3500-2700 K - Tunable BIOS		
					BTW4027 4000-2700 K - Tunable BIOS		

Outputs between listed min and max are available.  
Consult factory for outputs outside of the listed range.  
Consult factory for max output with BIOS

\* Not available with BIOS.

[Consult Axitune technical sheet for more information on color technology.](#)  
[\\*Consult BIOS guide for more information on BIOS technology](#)

W					
DOOR FINISH	VOLTAGE	DRIVER	CIRCUITS	MOUNTING/SUSPENSION	BATTERY (OPTIONAL)
W white	120 120 V 277 277 V 347 347 V UNV universal DC low voltage*	DP dimming (0-10V) 1% LT Lutron BI bi-level dimming O(##) other** DPB(STC) dimming (0-10V) 1% with BIOS* DPB(DYN) Bio-dimming™ 100%-81% with BIOS* TW(##) tunable white drivers* POE(##) POE drivers*	1 1 circuit +E(##) emergency section* +NL(##) night light section* +GTD(##) generator transfer device*	TB9 t-bar 9/16" TB15 t-bar 15/16" ST screw slot t-bar TG9 regular 9/16" TG15 regular 15/16" DF drywall flange	B(##) battery pack
	* Only available with POE drivers.	*See page 2 to specify system **Please consult factory; see page 2	* Specify quantity		Please consult factory

OTHER (OPTIONAL)	IC CONTROL (OPTIONAL)	CUSTOM (OPTIONAL)
FW flex whip (6' std)* CP chicago plenum	DS(##) daylight sensor OS(##) occupancy sensor DOS(##) daylight & occupancy sensor EN(##) enlightened integral* ENR(##) enlightened remote* WC(##) wireless control dimming	C custom
* Other lengths available; please consult factory.	*Please consult factory <a href="#">See integrated controls guide for more details.</a> Consult factory for Tunable White. Not available with DPB (DYN) driver for BIOS with Dynamic Spectrum	Please specify

**SPECIFY DRIVER NAME (if needed)**

**SPECIFY BATTERY NAME (if needed)**

### ELECTRICAL

<b>Lutron driver</b>	LDE1 - Hi-lume 1% EcoSystem with Soft-on, Fade-to-Black
<b>Other drivers**</b>	DALI - Digital Addressable Lighting Interface DMX - Digital Multiplex Xitanium SR - For wireless sensor
<b>BIOS DPB drivers*</b>	STC - BIOS control 0-10V with static spectrum and BIOS SkyBlue enabled from 100% to 1%. DYN - BIOS control 0-10V with dynamic spectrum and BIOS SkyBlue® with Bio-Dimming™, which changes spectral qualities by removing the SkyBlue component when dimming from 100% to 81%, while light output remains relatively constant; bio-dimming reduces CCT to 2700K. Dimming from 80% to 1% will then reduce light output.
<b>Tunable White TW drivers*</b>	DALIDT6 - DALI Type 6 (Two DALI Addresses) DALIDT8 - DALI Type 8 (One DALI Address)
<b>Power over Ethernet POE drivers*</b>	MOLEX IGOR SMARTENGINE O - Other (Consult factory)
<b>Emergency</b>	Integral emergency battery pack or emergency circuit optional.
<b>Input Voltage</b>	120V, 277V, 347V, UNV, DC.
<b>Flex Whip</b>	Shipped in a separate box for contractors to install

\*Choose driver from available options.

**i** Incorporating these components may have limitations or affect the length of the luminaire. Please contact factory for more details.

### LED SYSTEM

<b>CRI</b>	Minimum 80 or 90 color rendering index.
<b>CRI BIOS</b>	Minimum 80 color rendering index with R9>75 for all CCTs.
<b>CCT Single Color</b>	Choice of 2700K, 3000K, 3500K and 4000K color temperature with a great color consistency (within 3-step MacAdam ellipse). Both within fixture and fixture to fixture.
<b>CCT BIOS</b>	BIOS Static (STC) Choice of 3000K, 3500K and 4000K. BIOS SkyBlue® Dynamic (DYN) Choice of 3000K, 3500K, and 4000K with Bio-Dimming™ BIOS Tunable White (BTW) Choice of 4000-2700K and 3500-2700K; does not use a bio-dimmer, it uses TW drivers, which allow independent control of CCT and intensity; e.g., BTW4027 provides combined SkyBlue + white light at 4000K, SkyBlue is removed at 2700K. Light output can be adjusted for each CCT. <a href="#">Consult BIOS guide for more information on BIOS technology.</a>
<b>CCT Axitune Systems</b>	<a href="#">Consult Axitune technical sheet for more information on color technology.</a>
<b>LED life</b>	Minimum 50,000h with 85% of lumen maintenance in 25°C ambient temperature, in compliance with IES LM-80 testing measurements.
<b>Thermal Management</b>	Aluminum housing acting as the heat sink to maximize life.
<b>Environment</b>	Dry and damp rated for indoor use only in operating ambient temperatures of 0-40°C (32-104°F).

### ● SPECIFICATIONS

#### CONSTRUCTION

<b>Housing</b>	Die formed cold rolled sheet steel (20 gauge).
<b>Door frame</b>	Extruded aluminum.
<b>Lens</b>	0.125" PMMA satin blend.
<b>Reflectors</b>	High reflectance post painted.
<b>Drywall Flange Kit</b>	Extruded aluminum (0.060" nominal).
<b>Luminaire support</b>	Integrated Hold-Down clip

### ● STANDARD AND END MOUNT POWER FEED

Knockouts for BX cable connection are provided both on the top and on the ends of the luminaire. This allows for an end mount power feed solution if it is required. (BX CABLE BY OTHER)

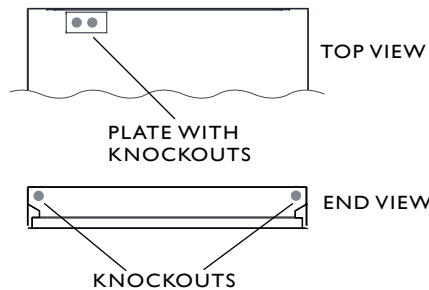

### ● WHITE FINISH

Aluminum paint and powder coated

### ● WARRANTY

Limited 5-year warranty is available. Warranty is valid provided luminaires are installed and used according to specifications. For full terms and conditions, please consult warranty section at [axislighting.com](http://axislighting.com).

### ● APPROVALS

Certified to UL and CSA standards   
 Chicago Plenum Certified (CCEA)  
 Meets NYC requirements  
 Suitable for damp locations.  
 IC Rated (Insulated ceiling)

### ● WEIGHT

**Drywall with Kit** 17.9 lbs / 8.1 kg

### ● CEILING SYSTEM

#### T-BAR STYLE MOUNTING

(TB9)

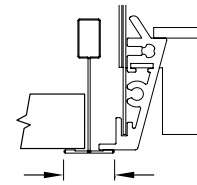

9/16" T-BAR

(ST)

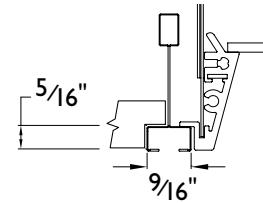

SCREW SLOT

(TG9)

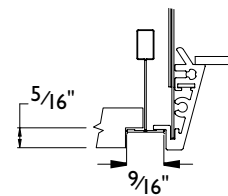

9/16" TEGULAR

(TB15)

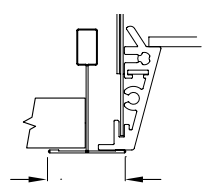

15/16" T-BAR

(TG15)

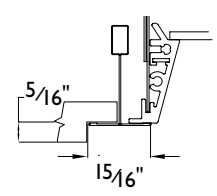

15/16" TEGULAR

#### DRYWALL WITH FLANGE KIT (DF)

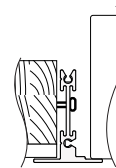

WITH WOOD FRAME

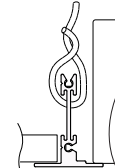

WITHOUT WOOD FRAME

**DRYWALL MOUNTING KIT** - ACCESS FROM ABOVE  
 - AVAILABLE IN TILE INSTALLATION ONLY

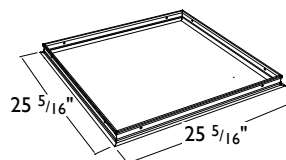

#### FIXTURE DIMENSIONS

23 3/4" x 23 3/4"

#### CUT HOLE DIMENSIONS

24 9/16" x 24 9/16"

**i** Installation sheets for all mounting options are available at: [www.axislighting.com](http://www.axislighting.com)

● PHOTOMETRIC DATA

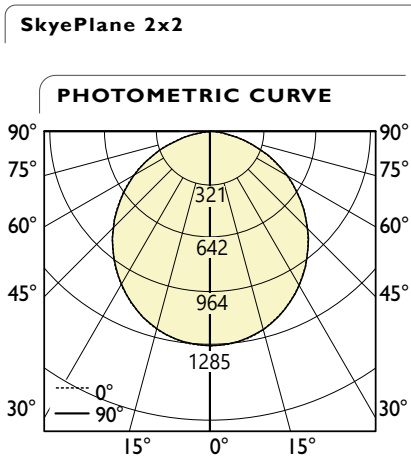

CANDELA DISTRIBUTION					
Vertical Angle	Horizontal Angles				
	0	22.5	45	67.5	90
0	1285	1285	1285	1285	1285
5	1279	1278	1279	1278	1278
15	1227	1227	1229	1228	1227
25	1126	1127	1129	1129	1127
35	989	989	989	991	990
45	821	819	820	822	822
55	630	628	628	630	632
65	421	419	419	422	424
75	207	205	208	208	211
85	35	35	36	37	37
90	1	1	1	1	1

ZONAL LUMENS	
Zone	Lumens
0	
0-10	121
10-20	347
20-30	521
30-40	620
40-50	635
50-60	565
60-70	420
70-80	225
80-90	50
90	

LUMINANCE DATA (cd/m²)			
Vertical Angle	Horizontal Angles		
	0	45	90
45	3449	3446	3455
55	3262	3251	3273
65	2958	2948	2978
75	2381	2382	2418
85	1199	1236	1270

Total Lumens: 3504 lm  
Input Watts: 33.06 W  
Efficacy: 106 lm/W

80 CRI shown. For 90 CRI, divide wattage by 0.8 and multiply efficacy by 0.8.

IES FILE: SKPL-22-3500-80-35-SO-RE-W-120-D

TESTED ACCORDING TO IES LM-79-2008

**i** All IES files are available for download at: [www.axislighting.com](http://www.axislighting.com)