

# Beam 3 | Recessed Asymmetric Mount

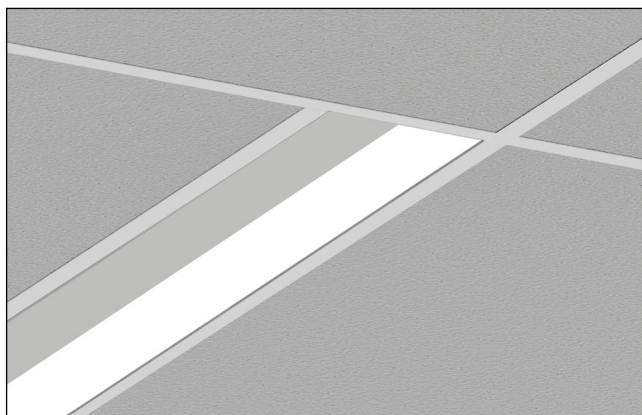

Project \_\_\_\_\_

Type \_\_\_\_\_

Notes \_\_\_\_\_

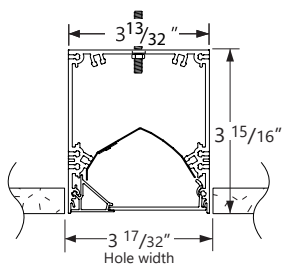

## PERFORMANCE PER LINEAR FOOT AT 4000K

NOMINAL LUMEN OUTPUT	INPUT WATTS*	EFFICACY
500 lm/ft	5.5 W/ft	90 lm/W
600 lm/ft	6.6 W/ft	90 lm/W
700 lm/ft	7.7 W/ft	90 lm/W

\* Based on a 4 foot luminaire using one driver  
Please consult factory for custom lumen output and wattage.



\* Check the latest update on the DLC website for complete information. Not all versions may be DLC qualified.

See page 3 for DLC Approved Options



## Ordering Guide

BMRLED		ASO	
PRODUCT ID	NOM. LUMENS/FT	SHIELDING	LENGTH
<b>BMRLED</b> Recessed LED	<b>400</b> 400 lm/ft - Minimum	<b>ASO</b> asymmetric with SO lens	<b>2</b> 2'
	<b>1000</b> 1000 lm/ft - Maximum		<b>3</b> 3'
			<b>4</b> 4'
			<b>5</b> 5'
			<b>6</b> 6'
			<b>8</b> 8'
			<b>12</b> 12'
			<b>S(L)</b> system run
Outputs between listed min and max are available. Consult factory for outputs outside of the listed range.		See page 2-3 for more details	

LED DOWNLIGHT INSERT	FINISH	VOLTAGE	DRIVER	CIRCUITS	MOUNTING
<b>M16(#)</b> MR halogen lamp - Line voltage (by other)*	<b>AP</b> aluminum paint	<b>120</b> 120 V	<b>DP</b> dimming (0-10V) 1%	<b>1</b> 1 circuit	<b>TB9</b> t-bar 9/16"
<b>M16LED(#)</b> MR16 LED lamp - Line voltage (by other)*	<b>W</b> white	<b>277</b> 277 V	<b>LT</b> Lutron *	<b>2</b> 2 circuits	<b>TB15</b> t-bar 15/16"
<b>M16LEDB(#)</b> MR16 LED lamp - Dimmable (provided)**	<b>BLK</b> black	<b>347</b> 347 V	<b>BI</b> bi-level dimming	<b>+E(#)</b> emergency circuit *	<b>ST</b> screw slot t-bar
	<b>C</b> custom	<b>UNV</b> universal	<b>O</b> other **	<b>+NL(#)</b> night light circuit *	<b>TG9</b> regular 9/16"
		<b>DC</b> low voltage*	<b>POE(#)</b> POE drivers*	<b>+GTD(#)</b> generator transfer device *	<b>TG15</b> regular 15/16"
				<b>+M</b> MR	<b>DF</b> drywall flange
					<b>D</b> drywall flangeless
					<b>DB</b> slip-through bracket
					<b>DS</b> drywall spackle flange
*Specify quantity; Line wattage only; Separate circuits included.		* Only available with POE drivers.		* Specify quantity	
**Consult factory; See page 3 for more details; M16 constant current for 0-10V & DALI only. Available in 3000K or 4000K		* Specify system ** Please consult factory; see page 2 <a href="#">Consult Axitune spec sheet for Axis color driver options</a>			

BATTERY (OPTIONAL)	OTHER (OPTIONAL)	IC CONTROLS (OPTIONAL)	CUSTOM (OPTIONAL)
<b>B(#)</b> battery pack 4' sections	<b>F</b> fuse *	<b>DS(#)</b> daylight sensor	<b>C</b> custom
	<b>EF</b> end feed	<b>OS(#)</b> occupancy sensor	
	<b>FW(#)</b> flex whip (6' std)	<b>DOS(#)</b> daylight & occupancy sensor	
	<b>CP</b> Chicago plenum	<b>EN(#)</b> Enlighted integral *	
		<b>ENR(#)</b> Enlighted remote **	
		<b>WC(#)</b> wireless control dimming	
Not available with 347V Please consult factory	*Requires 120V or 277V	* For flush option only; Please consult factory ** Please consult factory. Specify quantity. Requires 8" blank. See integrated controls guide for more details.	Please specify

# Beam 3 | Recessed Asymmetric Mount

## ● CONSTRUCTION

<b>Housing</b>	Extruded aluminum (0.075" nominal) Up to 70% recycled content
<b>End Cap</b>	Sheet steel (18 gauge)
<b>Interior Brackets</b>	Die formed sheet steel (18 gauge)
<b>Reflectors</b>	White powder coated sheet steel (22 gauge)
<b>Blank</b>	Extruded aluminum (0.075" nominal)
<b>Lens</b>	Spotless acrylic lens
<b>T-Bar Bracket</b>	Die formed sheet steel (16 gauge)
<b>Screw Slot T-Bar Bracket</b>	Die formed sheet steel (16 gauge)
<b>Slip-Through Bracket</b>	Die formed sheet steel (18 gauge)
<b>Spackle Flange</b>	Die formed perforated sheet steel (20 gauge)
<b>Flange</b>	Extruded aluminum (0.075" nominal) visible flange width: 9/16"

## ● ELECTRICAL

<b>Lutron driver*</b>	LDE1 - Hi-lume 1% EcoSystem with Soft-on, Fade-to-Black LTEA - Hi-lume 1% 2-wire (120V forward phase only) *Consult factory
<b>Other drivers**</b>	DALI - Digital Addressable Lighting Interface DMX - Digital Multiplex Xitanium SR - For wireless sensor
<b>Power over Ethernet POE drivers*</b>	MOLEX IGOR O - Other (Consult factory) *Consult factory
<b>Emergency</b>	Integral emergency battery pack or emergency circuit optional.
<b>Input Voltage</b>	120V, 277V, 347V, UNV.
<b>Flex Whip</b>	Shipped in a separate box for contractors to install

**i** Incorporating these components may have limitations or affect the length of the luminaire. Please contact factory for more details.

## ● SYSTEM (S#)

BEAM 3 LED linear systems, with the use of a strong profile, allow for a nearly hair thin connection system of continuous runs. Lengths of 4', 8', 12' as well as custom lengths are available. Runs of BEAM 3 LED that are greater than 12' in length are designated as systems (S#). This means that the run is comprised of a combination 4', 8' and/or 12' sections to be assembled on site using our joining system. For more information on systems and joining, please refer to the BEAM 3 LED installation sheets available for download at [www.axislighting.com](http://www.axislighting.com).

## ● APPROVALS

Certified to UL and CSA standards   
Meets NYC requirements  
Meets CCEC requirements (Chicago plenum)  
Suitable for damp locations  
IC Rated (Insulated ceiling)

## ● WEIGHT

<b>Recessed Asymmetric 4 ft</b>	12.3 lbs / 5.0 kg
<b>Recessed Asymmetric 8 ft</b>	24.6 lbs / 10.1 kg
<b>Recessed Asymmetric 12 ft</b>	36.9 lbs / 15.1 kg

## ● OPTICS

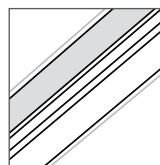

ASO asymmetric with SO lens

**ASYMMETRIC WITH SPOTLESS LENS**  
PMMA Acrylic lay-in lens spotless: 85% trans.

## ● JOINERS

In order to allow very long runs of BEAM 3 LED luminaires, Axis has developed a number of different joining systems. Special care has been taken to maximize the performance of the joiner for each BEAM option.

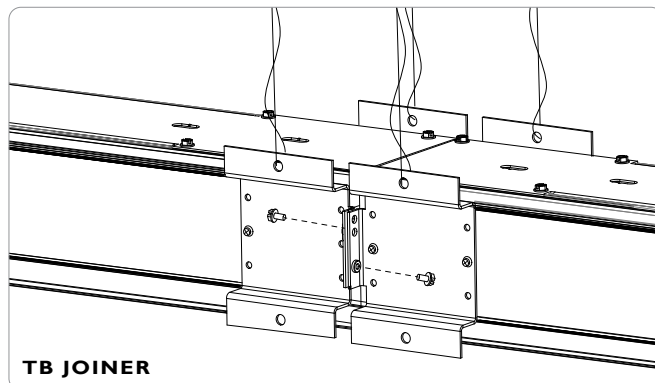

TB JOINER

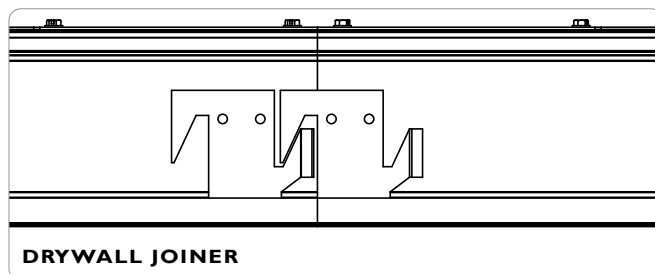

DRYWALL JOINER

**NOTE:** Hang each system segment individually. Do not assemble system prior to hanging.

## ● FINISHES

Powder coated and custom finishes are also available.

## ● LED SYSTEM

<b>CRI</b>	Minimum 80 or 90 color rendering index
<b>CCT</b>	Choice of 2700K, 3000K, 3500K and 4000K color temperature with a great color consistency (within 3.5-step MacAdam ellipse).
<b>LED life</b>	Minimum 50,000h with 70% of lumen maintenance in 25°C ambient temperature, in compliance with IES LM-80 testing measurements.
<b>Thermal management</b>	Aluminium housing acting as the heat sink to maximize life.

# Beam 3 | Recessed Asymmetric Mount

## CORNERS

**Unlit Corners** - BEAM 3 LED features a multitude of layout patterns with the use of a number of corners, 90° corner, T or X junctions.

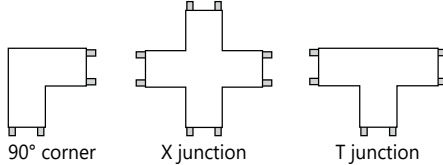
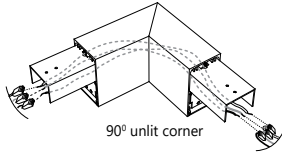

**i** For custom corner angles, please consult factory. Specifications sheets for all corners are available at: [www.axislighting.com](http://www.axislighting.com)

## LIGHT WASH

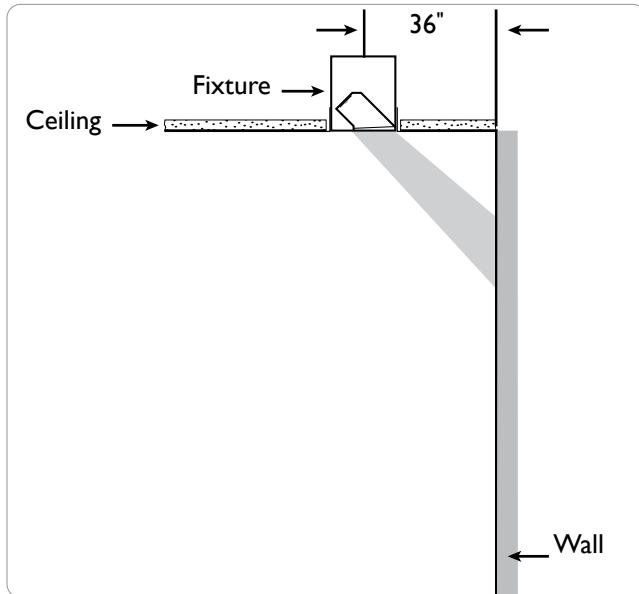

**NOTE:** Recommended distance from the wall - 3 to 4ft.

## OTHER MOUNTING OPTIONS

BEAM 3 LED is also available with pendant, recessed, surface, wall, wall vertical and recessed vertical mounted options.

**i** Specification sheets and installation sheets for all mountings for BEAM 3 LED luminaires are available for download at [www.axislighting.com](http://www.axislighting.com)

## DLC Approved Options



\*Check the latest update on the DLC website for complete information. Not all versions may be DLC qualified.

OUTPUT	CRI	COLOR TEMP.	SHIELDING	LENGTH	FINISH	VOLTAGE	DRIVER	CIRCUITS
400 lm/ft	80	3000 K	FL	4'	white	universal	DP	any except
650 lm/ft		3500 K		5'				LDI and M
850 lm/ft		4000 K		6'				
				7'				
				8'				
				9'				
				10'				
				11'				
				12'				

## WARRANTY

Axis Lighting will warrant defective LEDs, boards, and drivers for 5 years from date of purchase. Warranty is valid if luminaire is installed and used according to specifications. If defective, Axis will send replacement boards or drivers at no cost along with detailed replacement instructions and instructions on how to return defective components to Axis.

## MR16 LED LAMPS

**Blank** Extruded aluminum (0.075" nominal)

**MR16 Halogens** Adjustable halogen lamp 35W / 50W (by others)

**MR16 LED** Adjustable LED lamp (provided)

**MR16 LEDB** Constant current LED lamp (provided)- Dimmable by control system for 0-10V & DALI only

**Quantity** For every 4' section, there may be up to a maximum of 4 x MR16 LED lamps.

**Spacing** Each MR16 is placed centered on a blank section 9" in length. Within a given section length, a series of downlights will be spaced evenly on a longer blank section. Custom spacing available on special request.

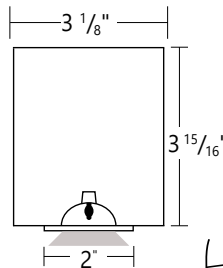

**Between sections**

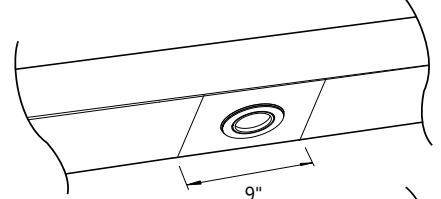

**At luminaire ends**

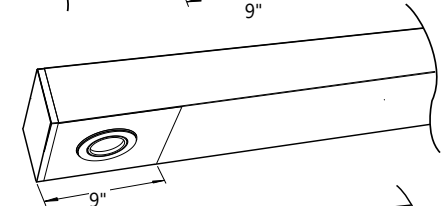

**Several in a long blank section**

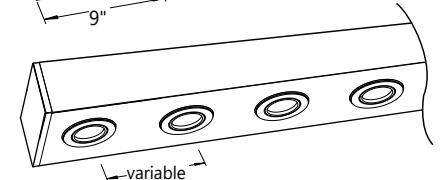

**Base Type** GU 5.3  
**Beam Angle** 40 nominal degrees  
**Input Watts** 6W  
**Nominal Lumens** 300 lumens  
**Efficacy** 50 lumens per watt  
**Color Rendering Index (CRI)** 85  
**Center Beam Candle Power (CBCP)** 584 candelas  
**Life** 25,000 hours at L<sub>70</sub>  
**Correlated color temperature (CCT)** 3000K, 4000K  
**Adjustability** 15° tilt

**i** More options are available upon request. Please consult factory.

# Beam 3 | Recessed Asymmetric Mount

## ● TB CEILING MOUNTING OPTIONS

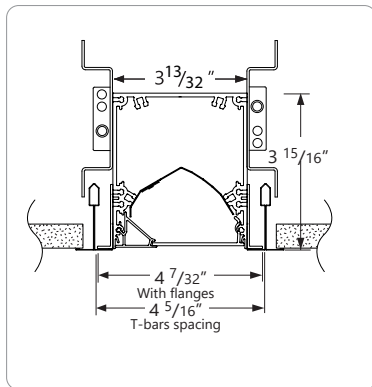

**TB15** 15/16" T-BAR

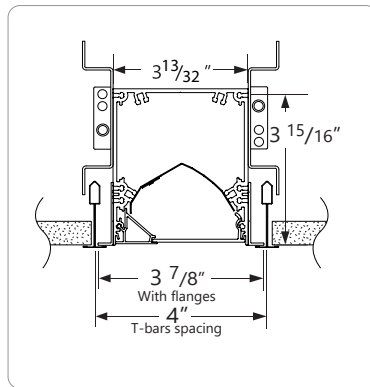

**TB9** 9/16" T-BAR

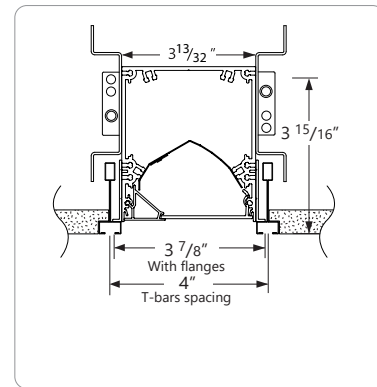

**ST** SCREW SLOT T-BAR

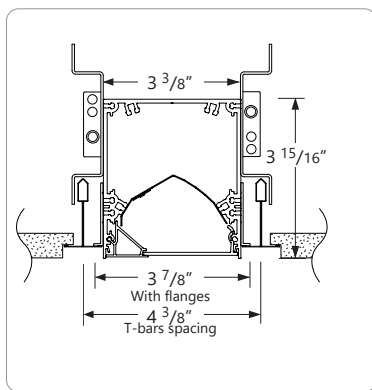

**TG15** 15/16" TEGULAR

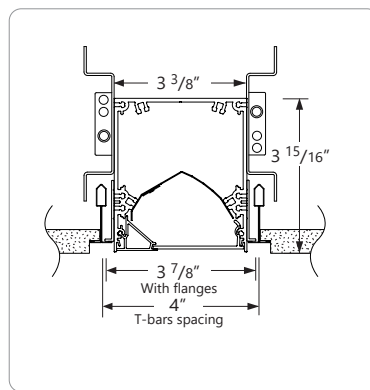

**TG9** 9/16" T-TEGULAR

## ● DRYWALL CEILING MOUNTING OPTIONS

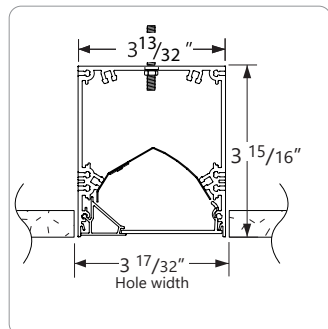

**D** FLANGELESS WITH  
1/4-20 STUD MOUNTING

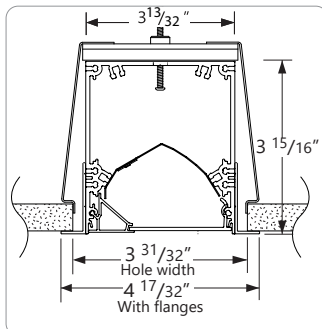

**DB** VISIBLE FLANGES WITH  
SLIP-THROUGH BRACKET

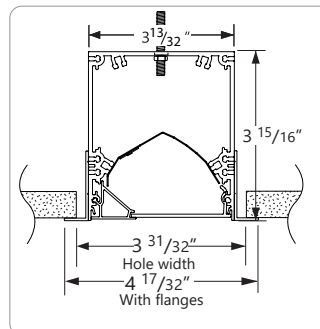

**DF** VISIBLE FLANGES WITH  
1/4-20 STUD MOUNTING

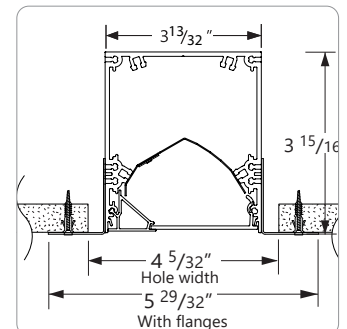

**DS** SPACKLE FLANGES

## ● OTHER MOUNTING OPTIONS

BEAM 3 LED is also available with pendant, surface, wall and recessed wall mounted options.

**i** Specification sheets and installation sheets for all mounting for BEAM luminaires are available for download at [www.axislighting.com](http://www.axislighting.com)

Beam 3

Recessed Asymmetric Mount

● PHOTOMETRIC DATA

500 lm/ft  
With ASO lens

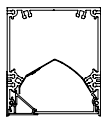

PHOTOMETRIC CURVE

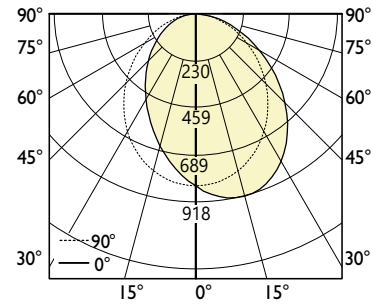

Luminaire Lumens: 520 lm/ft  
Input Watts: 4.87 W/ft  
Efficacy: 107 lm/W

IES FILE: TB3LED-500-80-30-ASO-4.IES

TESTED ACCORDING TO IES LM-79-2008

CANDELA DISTRIBUTION					
Vertical Angle	Horizontal Angles				
	0	22.5	45	67.5	90
0	837	837	837	837	837
5	883	878	867	851	832
15	918	910	884	842	792
25	878	869	839	785	714
35	770	764	737	682	608
45	616	613	596	550	484
55	446	446	436	405	355
65	282	284	280	263	231
75	143	145	145	138	122
85	31	32	36	37	35
90	1	1	1	1	1

ZONAL LUMENS	
Zone	Lumens
0	
0-10	79
10-20	223
20-30	328
30-40	377
40-50	369
50-60	313
60-70	226
70-80	129
80-90	38
90	

LUMINANCE DATA (cd/m²)			
Vertical Angle	Horizontal Angles		
	0	45	90
45	12199	11791	9579
55	10883	10649	8662
65	9352	9286	7643
75	7756	7856	6626
85	4899	5722	5667

**i** All IES files for other lamping are available for download at: [www.axislighting.com](http://www.axislighting.com)