

Beam 2 | Recessed Vertical Mount

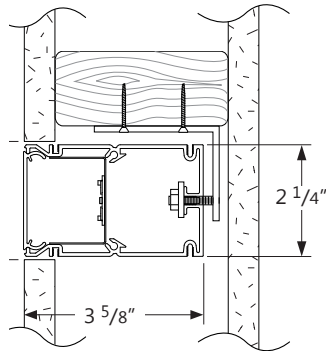
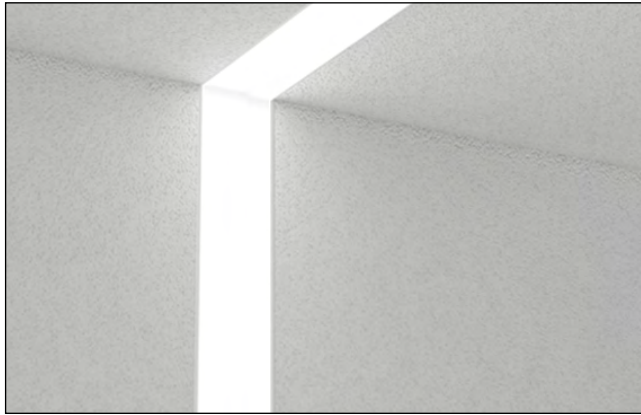

Project _____

Type _____

Notes _____

PERFORMANCE PER LINEAR FOOT AT 4000K

NOMINAL LUMEN OUTPUT	INPUT WATTS*	EFFICACY
400 lm/ft	3.6 W/ft	111 lm/W
500 lm/ft	4.7 W/ft	106 lm/W
750 lm/ft	7.5 W/ft	100 lm/W
1000 lm/ft	10.4 W/ft	96 lm/W

* Based on a 4 foot luminaire using one driver
Please consult factory for custom lumen output and wattage.



Ordering Guide

BRVLED													
PRODUCT ID		NOM. LUMENS/FT		CRI		COLOR TEMP. (choose one)				SHIELDING		LENGTH (FT)	
BRVLED	Recessed Vertical LED	400	400 lm/ft - min	80	80 CRI	27	2700 K	TW2750 2700-5000 K - Tunable White		SO	spotless lens	2	2'
		750	750 lm/ft - max	90	90 CRI*	30	3000 K	TW2765 2700-6500 K - Tunable White				3	3'
						35	3500 K	BTW3527 3500-2700 K - Tunable BIOS				4	4'
						40	4000 K	BTW4027 4000-2700 K - Tunable BIOS				5	5'
						B30	3000 K - BIOS*					6	6'
						B35	3500 K - BIOS*					8	8'
						B40	4000 K - BIOS*					12	12'
Outputs between listed min and max are available. Consult factory for outputs outside of the listed range. Consult factory for max output with BIOS. * 1000lm/ft with louver				* Not available with BIOS.		Consult Axitune technical sheet for more information of color technology. *Consult BIOS guide for more information on BIOS technology				*Default lens for Tunable white and BIOS. Consult factory for other lens.			

FINISH	VOLTAGE		DRIVER		CIRCUITS		MOUNTING		BATTERY (OPTIONAL)	
W white	120	120 V	DP	dimming (0-10V) 1%	1	1 circuit	DF	drywall flange	B(#)	battery pack (integral)
C custom	277	277 V	LT(#)	Lutron*	2	2 circuits	DS	drywall spackle flange		
	347	347 V	BI	bi-level dimming	+E(#)	emergency circuit*	D	drywall flangeless		
	UNV	universal	O(#)	other**	+NL(#)	night light circuit*				
	DC	low voltage*	DPB(STC)	dimming (0-10V) 1% with BIOS*	+GTD(#)	generator transfer device*				
			DPB(DYN)	Bio-dimming™ 100%-81% with BIOS*						
			TW(#)	tunable white drivers*						
			POE(#)	POE drivers*						
		* Only available with POE drivers.	*See page 2 to specify system. **Please consult factory, see page 2		*Specify quantity				Not available with 347V Please consult factory	

OTHER (OPTIONAL)		CUSTOM (OPTIONAL)	
EF	end feed	C	custom
FW(#)	flex whip (6' std)		
		Please specify	

Beam 2 | Recessed Vertical Mount

● CONSTRUCTION

Housing	Extruded aluminum (0.075" nominal) up to 70% recycled content
T-Bar Bracket	Die formed sheet steel (16 gauge)
Screw Slot T-Bar Bracket	Die formed sheet steel (16 gauge)
Slip-Through Bracket	Die formed sheet steel (18 gauge)
Spackle Flange	Die formed perforated sheet steel (20 gauge)
Flange	Extruded aluminum (0.075" nominal) visible flange width: 9/16"
Interior Brackets	Die formed sheet steel (18 gauge)
Reflectors	White powder coated sheet steel (22 gauge)
Blank	Extruded aluminum (0.075" nominal)
Lens	Spotless frosted acrylic lens

● ELECTRICAL

Lutron driver*	LDE1 - Hi-lume 1% EcoSystem with Soft-on, Fade-to-Black LTEA - Hi-lume 1% 2-wire (120V forward phase only) <small>*Consult factory</small>
Other drivers**	DALI - Digital Addressable Lighting Interface DMX - Digital Multiplex Xitanium SR - For wireless sensor
BIOS DPB drivers*	STC - BIOS control 0-10V with static spectrum and BIOS SkyBlue enabled from 100% to 1%. DYN - BIOS control 0-10V with dynamic spectrum and BIOS SkyBlue® with Bio-Dimming™, which changes spectral qualities by removing the SkyBlue component when dimming from 100% to 81%, while light output remains relatively constant; bio-dimming reduces CCT to 2700K. Dimming from 80% to 1% will then reduce light output.
Tunable White TW drivers*	DALIDT6 - DALI Type 6 (Two DALI Addresses) DALIDT8 - DALI Type 8 (One DALI Address) LTTW - Lutron T-Series Tunable White
Power over Ethernet POE drivers*	MOLEX IGOR SMARTENGINE O - Other (Consult factory)
Emergency	Integral emergency battery pack or emergency circuit optional.
Input Voltage	120V, 277V, 347V, UNV, DC.
Flex Whip	Shipped in a separate box for contractors to install

*Choose driver from available options.

i Incorporating these components may have limitations or affect the length of the luminaire. Please contact factory for more details.

● LED SYSTEM

CRI	Minimum 80 or 90 color rendering index.
CRI BIOS	Minimum 80 color rendering index with R9>75 for all CCTs.
CCT Single Color	Choice of 2700K, 3000K, 3500K and 4000K color temperature with a great color consistency (within 3-step MacAdam ellipse). Both within fixture and fixture to fixture.
CCT BIOS	BIOS Static (STC) Choice of 3000K, 3500K and 4000K. BIOS SkyBlue® Dynamic (DYN) Choice of 3000K, 3500K, and 4000K with Bio-Dimming™ BIOS Tunable White (BTW) Choice of 4000-2700K and 3500-2700K; does not use a bio-dimmer, it uses TW drivers, which allow independent control of CCT and intensity; e.g., BTW4027 provides combined SkyBlue + white light at 4000K, SkyBlue is removed at 2700K. Light output can be adjusted for each CCT. Consult BIOS guide for more information on BIOS technology.
CCT Axitune Systems	Consult Axitune technical sheet for more information on color technology.
LED life	Minimum 50,000h with 85% of lumen maintenance in 25°C ambient temperature, in compliance with IES LM-80 testing measurements.
Thermal Management	Aluminum housing acting as the heat sink to maximize life.
Environment	Dry and damp rated in operating ambient temperatures of 0-40°C (32-104°F).

Beam 2 | Recessed Vertical Mount

● SYSTEM (S#)

BEAM 2 LED linear systems, with the use of a strong profile, allow for a nearly hair thin connection system of continuous runs. Lengths of 4', 8', 12' as well as custom lengths are available. Runs of BEAM 2 LED that are greater than 12' in length are designated as systems (S#). This means that the run is comprised of a combination 4', 8' and/or 12' sections to be assembled on site using our joining system. For more information on systems and joining, please refer to the BEAM 2 LED installation sheets available for download at www.axislighting.com.

● WEIGHT

Recessed Vertical LED 4 ft	10.5 lbs / 4.8 kg
Recessed Vertical LED 8 ft	21.0 lbs / 9.6 kg
Recessed Vertical LED 12 ft	31.5 lbs / 14.4 kg

● FINISHES

Powder coated and custom finishes are also available.

● OPTICS

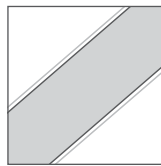

SO spotless lens
UB ultra blend lens

SPOTLESS LENS

Frosted acrylic snap-in lens with micro lens

ULTRA BLEND LENS

Frosted acrylic snap-in lens with micro lens

● APPROVALS

Certified to UL and CSA standards 
Meets NYC requirements
Suitable for damp locations
IC Rated (Insulated ceiling)

● WARRANTY

Axis Lighting will warrant defective LEDs, boards, and drivers for 5 years from date of purchase. Warranty is valid if luminaire is installed and used according to specifications. If defective, Axis will send replacement boards or drivers at no cost along with detailed replacement instructions and instructions on how to return defective components to Axis.

Beam 2 | Recessed Vertical Mount

● JOINERS

In order to allow very long runs of BEAM 2 LED luminaires, Axis has developed an effective joining system. Special care has been taken to maximize the performance of the joiner for each BEAM 2 LED option.

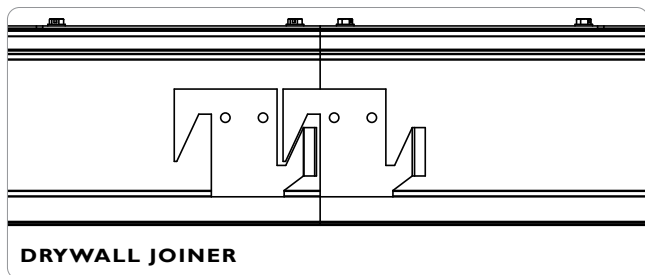

NOTE: Mount each system segment individually. Do not assemble system prior to hanging.

● CORNERS

Unlit Corners - BEAM 2 LED features a multitude of layout patterns with the use of a number of corners, 90° corner, T or X junctions.

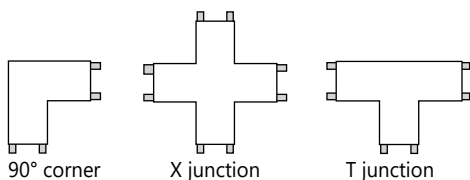
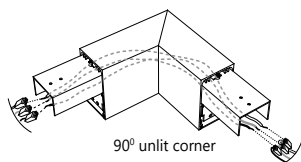

Lit Corners - Axis also offers lit 90° corners including ceiling to ceiling, wall to ceiling and ceiling to wall.

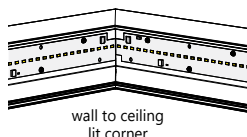

i For custom corner angles, please consult factory. Specifications sheets for all corners are available at: www.axislighting.com

● OTHER MOUNTING OPTIONS

BEAM 2 LED is also available with pendant, recessed, surface, wall vertical and wall mounted options.

i Specification sheets and installation sheets for all mountings for BEAM 2 LED luminaires are available for download at www.axislighting.com

● VERTICAL RECESSED MOUNTING OPTIONS

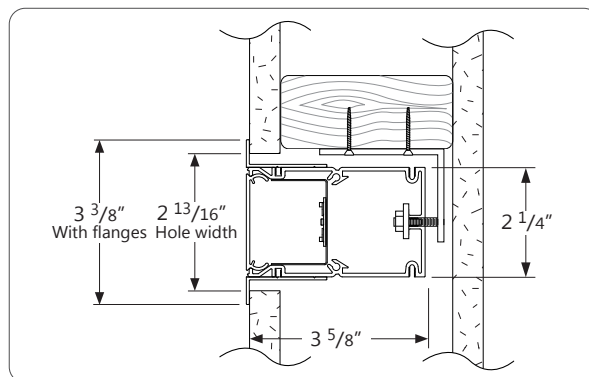

DF DRYWALL FLANGED

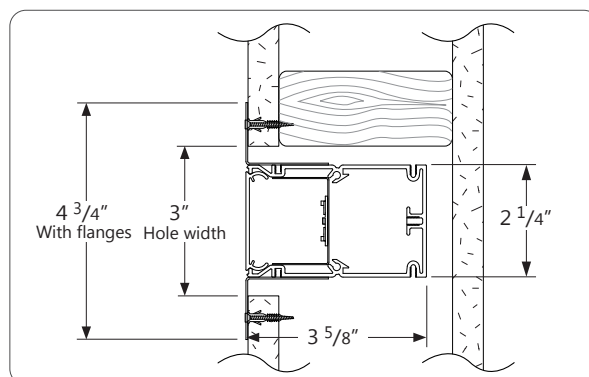

DS DRYWALL SPACKLE FLANGE

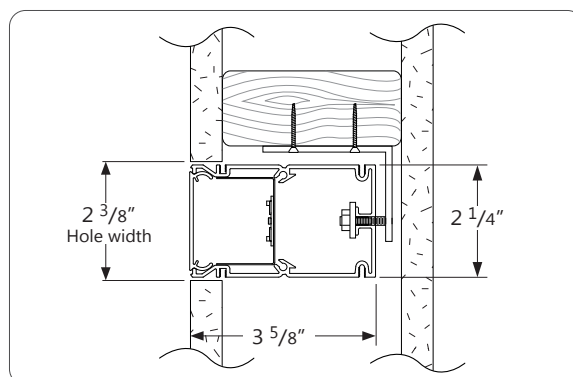

D DRYWALL FLANGELESS

Beam 2 | Recessed Vertical Mount

● PHOTOMETRIC DATA

400 lm/ft

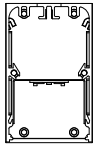

PHOTOMETRIC CURVE

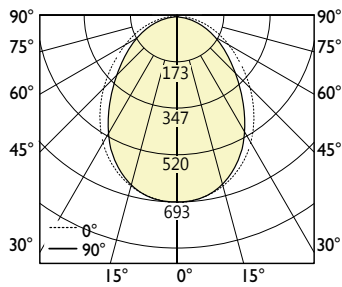

Luminaire Lumens: 400 lm/ft
Input Watts: 3.6 W/ft
Efficacy: 111 lm/W

IES FILE: BRVLED-400-80-40-SO.IES
 TESTED ACCORDING TO IES LM-79-2008

CANDELA DISTRIBUTION

Vertical Angle	Horizontal Angles				
	0	22.5	45	67.5	90
0	691	691	691	691	691
5	684	687	684	689	691
15	653	656	651	649	651
25	591	589	576	567	563
35	499	492	469	448	440
45	387	377	348	324	315
55	269	260	236	216	208
65	164	157	143	129	124
75	77	76	68	61	59
85	17	15	16	15	15
90	0	0	0	0	0

ZONAL LUMENS

Zone	Lumens
0	
0-10	65
10-20	184
20-30	265
30-40	293
40-50	270
50-60	213
60-70	143
70-80	73
80-90	18
90	

LUMINANCE DATA (cd/m²)

Vertical Angle	Horizontal Angles		
	0	45	90
45	8552	7697	6960
55	7344	6435	5672
65	6069	5280	4589
75	4673	4109	3545
85	3110	2871	2632

500 lm/ft

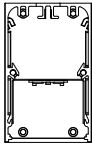

PHOTOMETRIC CURVE

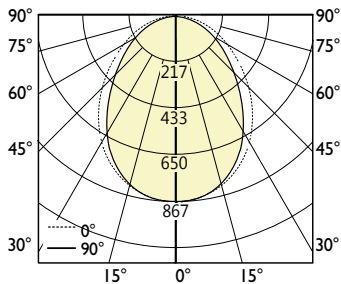

Luminaire Lumens: 500 lm/ft
Input Watts: 4.7 W/ft
Efficacy: 106 lm/W

IES FILE: BRVLED-500-80-40-SO.IES
 TESTED ACCORDING TO IES LM-79-2008

CANDELA DISTRIBUTION

Vertical Angle	Horizontal Angles				
	0	22.5	45	67.5	90
0	863	863	863	863	863
5	855	858	855	862	863
15	817	820	813	812	813
25	738	737	720	708	703
35	623	615	587	560	550
45	483	472	435	405	393
55	337	325	295	270	260
65	205	197	178	162	155
75	97	95	85	77	73
85	22	18	20	18	18
90	0	0	0	0	0

ZONAL LUMENS

Zone	Lumens
0	
0-10	81
10-20	229
20-30	331
30-40	367
40-50	337
50-60	266
60-70	178
70-80	92
80-90	23
90	

LUMINANCE DATA (cd/m²)

Vertical Angle	Horizontal Angles		
	0	45	90
45	10690	9620	8700
55	9180	8044	7089
65	7586	6599	5736
75	5841	5136	4431
85	3888	3589	3290

i All IES files are available for download at: www.axislighting.com

Beam 2 | Recessed Vertical Mount

● PHOTOMETRIC DATA

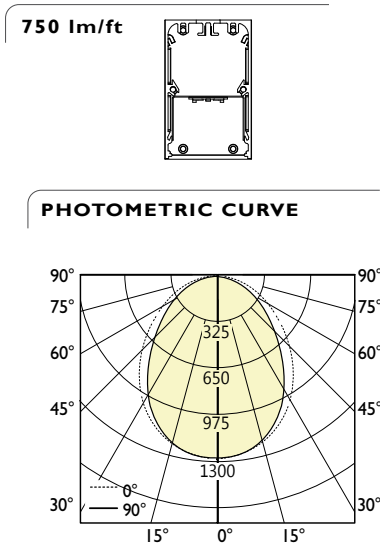

Luminaire Lumens: 750 lm/ft
Input Watts: 7.5 W/ft
Efficacy: 100 lm/W

IES FILE: BRVLED-750-80-40-SO.IES
TESTED ACCORDING TO IES LM-79-2008

CANDELA DISTRIBUTION					
Vertical Angle	Horizontal Angles				
	0	22.5	45	67.5	90
0	1295	1295	1295	1295	1295
5	1283	1288	1283	1293	1295
15	1225	1230	1220	1218	1220
25	1108	1105	1080	1063	1055
35	935	923	880	840	825
45	725	708	653	608	590
55	505	488	443	405	390
65	308	295	268	243	233
75	145	143	128	115	110
85	33	28	30	28	28
90	0	0	0	0	0

ZONAL LUMENS	
Zone	Lumens
0	
0-10	122
10-20	344
20-30	497
30-40	550
40-50	506
50-60	399
60-70	268
70-80	138
80-90	34
90	

LUMINANCE DATA (cd/m ²)			
Vertical Angle	Horizontal Angles		
	0	45	90
45	16035	14432	13050
55	13770	12066	10634
65	11380	9899	8604
75	8762	7704	6647
85	5832	5383	4935

i All IES files are available for download at: www.axislighting.com