

Pixel 2x2



Pixel 1x4



Pixel 1x8

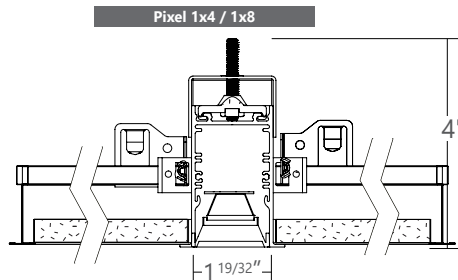
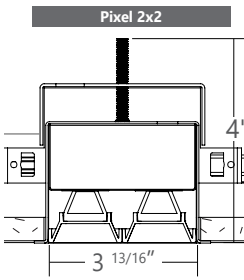

Please provide configuration drawings

Project \_\_\_\_\_

Type \_\_\_\_\_

Notes \_\_\_\_\_

Pixel 2x2

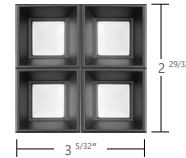

Pixel 1x4



1 module contains 4 MikroLite® 1.5 cells

Pixel 1x8

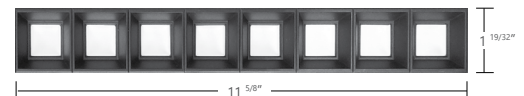

1 module contains 8 MikroLite® 1.5 cells



### Ordering Guide

Pixel lumen are based on module

PIMLR														
PRODUCT ID		MODULE SIZE		NOM. LUMENS/UNIT			MikroLite BEAM SPREAD		MikroLite CELL FINISH		CRI		COLOR TEMP	
PIMLR	Pixel Recessed Downlights for Grid Ceilings	2x2	2x2	200	200 lm - Min	2x2, 1x4	D38	38 deg	GR	gray	80	80 CRI	27	2700K
		1x4	1x4	500	500 lm - Max		D55	55 deg (standard)	W	white	90	90 CRI	30	3000K
		1x8	1x8	200	200 lm - Min	1x8	D60	60 deg	BLK	black			35	3500K
				1000	1000 lm - Max								40	4000K
				Outputs between listed min and max are available. Consult factory for outputs outside of the listed range.										

FINISH		VOLTAGE		REMOTE DRIVER		CIRCUITS		MOUNTING/SUSPENSION		CUSTOM (OPTIONAL)	
AP	aluminum paint	120	120 V	DP	dimming (0-10V) 1% - remote only	1	1 circuit	TB9	t-bar 9/16"	C	custom
W	white	277	277 V	LT	Lutron - remote only			TB15	t-bar 15/16"		
BLK	black	347	347 V	BI	bi-level dimming - remote only	ST		screw slot t-bar			
C	custom	UNV	universal	O	other - remote only**	TG9		regular 9/16"			
		DC	low voltage*	POE(#)	POE drivers*	TG15		regular 15/16"			
		* Only available with POE drivers.		Remote only. Please provide configuration drawing. (1) Specify system (2) Please consult factory; see page 2				Please specify			

## ● CONSTRUCTION

<b>Housing 1x4 and 1x2</b>	Extruded aluminium
<b>2x2</b>	Sheet metal housing
<b>Interior Brackets</b>	Die formed sheet steel (20 gauge)
<b>Micro Downlight</b>	High density composite Polycarbonate shielding and formed aluminum optical system
<b>Mixing Lenses</b>	Extruded acrylic
<b>Micro Downlight Heat Sink</b>	Extruded aluminum

## ● LED SYSTEM

<b>LED System</b>	4 or 8 cells in each module
<b>LED optical System</b>	Axis patent pending mixing chamber optic for high efficacy light control with deep square in square architectural downlight trim
<b>CRI</b>	Minimum 80 or 90 color rendering index
<b>CCT</b>	Choice of 2700K, 3000K, 3500K and 4000K color temperature with a great color consistency (within 3.0-step MacAdam ellipse).
<b>Color Tuning</b>	Cluster of 4 LED 2 on each diagonal for pure color mixing and no color over angle effects in the space
<b>LED life</b>	Minimum 50,000h with 85% of lumen maintenance in 25°C ambient temperature, in compliance with IES LM-80 testing measurements.
<b>Thermal Management</b>	Aluminum housing acting as the heat sink to maximize life. Extruded aluminum downlight heat sink

## ● ELECTRICAL

## Remote drivers

<b>Lutron driver</b>	LDE1 - EcoSystem H-Series (1%)
<b>Other drivers</b>	DALI - Digital Addressable Lighting Interface DMX - Digital Multiplex Xitanium SR - For wireless sensor

<b>Power over Ethernet POE drivers*</b> (consult factory for more information) UL2108 certified for integral or remote driver	MOLEX IGOR SMARTENGINE O - Other (Consult factory)
---	---

## All drivers are remote

<b>Emergency</b>	remote emergency battery pack or emergency circuit optional.
<b>Input Voltage</b>	120V, 277V, UNV.

## ● APPROVALS

Certified to UL and CSA standards  US  
Suitable for damp locations.

## ● WARRANTY

Limited 5-year warranty is available. Warranty is valid provided luminaires are installed and used according to specifications. For full terms and conditions, please consult warranty section at [axislighting.com](http://axislighting.com).

## ● ECO FRIENDLY PROGRAM

Pixel meets the Living Building Challenge, is Halogen free and includes PVC free wiring in compliance with requirements. Please contact Axis for supporting documentation.

## ● BEAM SPREADS

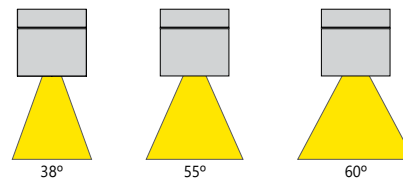

**i** Incorporating these components may have limitations or affect the length of the luminaire. Please contact factory for more details.

● TB CEILING MOUNTING OPTIONS

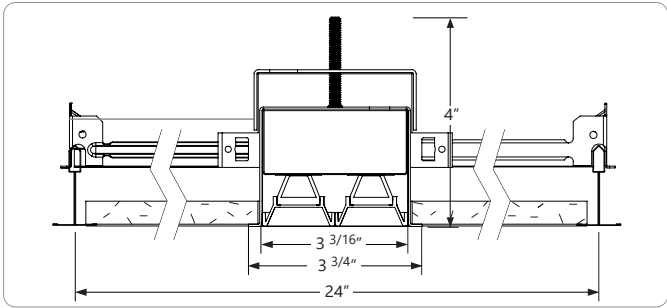

**TB15 15/16" T-BAR**

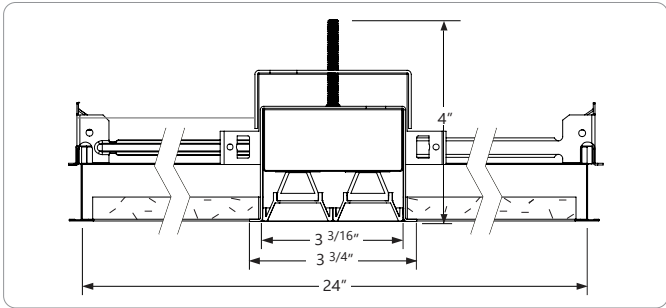

**TB9 9/16" T-BAR**

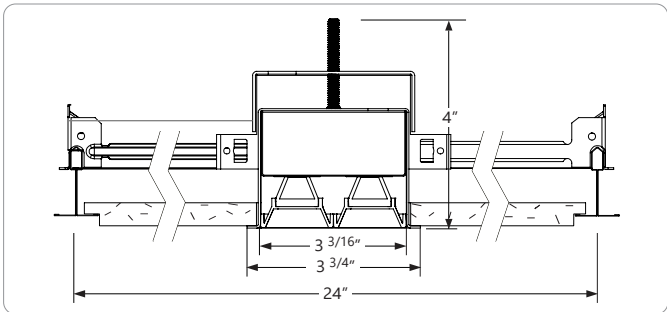

**TG15 15/16" TEGULAR**

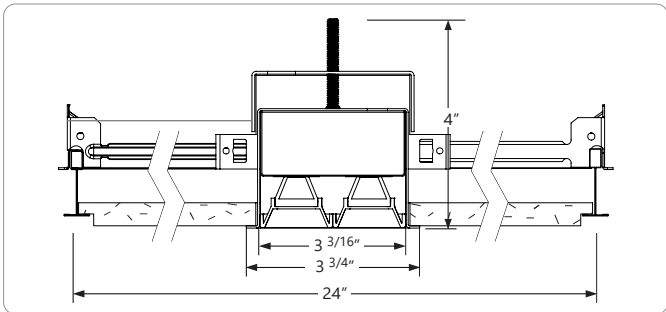

**TG9 9/16" TEGULAR**

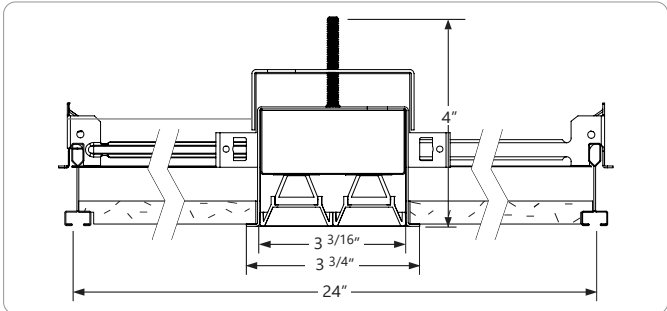

**ST SCREW SLOT T-BAR**

**i** Specification sheets and installation sheets for all mountings for MikroLite 1.5 luminaires are available for download at [www.axislighting.com](http://www.axislighting.com)

### ● PHOTOMETRIC DATA

#### MikroLite Recessed - 2x2 200 lm/unit



##### PHOTOMETRIC CURVE

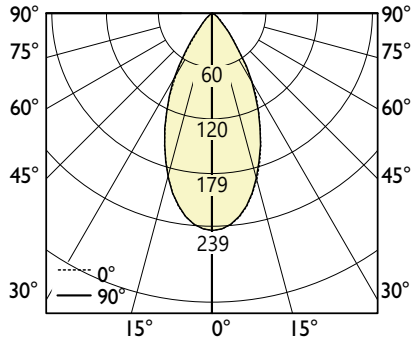

**Total Lumens: 200 lm (2x2)**  
**Input Watts: 1.8 W**  
**Efficacy: 111 lm/W**

IES FILE: PIMLR-2X2-200-80-35-W-1.IES  
 TESTED ACCORDING TO IES LM-79-2008

#### CANDELA DISTRIBUTION

Vertical Angle	Horizontal Angles				
	0	22.5	45	67.5	90
0	239	239	239	239	239
5	233	234	234	235	235
15	194	195	196	196	196
25	129	130	131	131	130
35	63	67	69	69	68
45	16	19	27	21	17
55	4	4	4	5	4
65	1	1	1	1	1
75	0	0	0	0	0
85	0	0	0	0	0
90	0	0	0	0	0

#### ZONAL LUMENS

Zone	Lumens
0	
0-10	22
10-20	54
20-30	60
30-40	42
40-50	17
50-60	4
60-70	1
70-80	0
80-90	0
90	

#### LUMINANCE DATA (cd/m²)

Vertical Angle	Horizontal Angles		
	0	45	90
45	4110	7067	4452
55	1246	1422	1321
65	242	308	239
75	0	0	0
85	0	0	0

**i** All IES files are available for download at: [www.axislighting.com](http://www.axislighting.com)

#### MikroLite Recessed - 2x2 500 lm/unit



##### PHOTOMETRIC CURVE

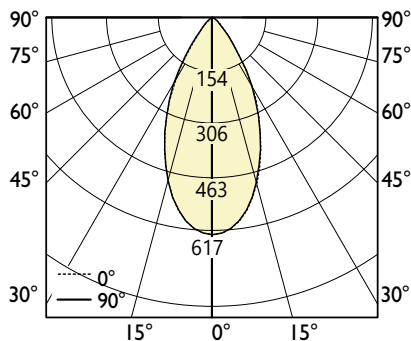

**Total Lumens: 516 lm (2x2)**  
**Input Watts: 4.7 W**  
**Efficacy: 110 lm/W**

IES FILE: PIMLR-2X2-500-80-35-W-1.IES  
 TESTED ACCORDING TO IES LM-79-2008

#### CANDELA DISTRIBUTION

Vertical Angle	Horizontal Angles				
	0	22.5	45	67.5	90
0	617	617	617	617	617
5	602	604	604	605	605
15	501	503	506	506	505
25	332	335	339	338	335
35	164	172	179	179	175
45	41	48	70	53	44
55	10	11	11	12	11
65	1	2	2	2	1
75	0	0	0	0	0
85	0	0	0	0	0
90	0	0	0	0	0

#### ZONAL LUMENS

Zone	Lumens
0	
0-10	56
10-20	140
20-30	154
30-40	109
40-50	44
50-60	11
60-70	2
70-80	0
80-90	0
90	

#### LUMINANCE DATA (cd/m²)

Vertical Angle	Horizontal Angles		
	0	45	90
45	10603	18233	11486
55	3214	3668	3409
65	625	796	616
75	0	0	0
85	0	0	0

**i** All IES files are available for download at: [www.axislighting.com](http://www.axislighting.com)