

Project _____

Type _____

Notes _____

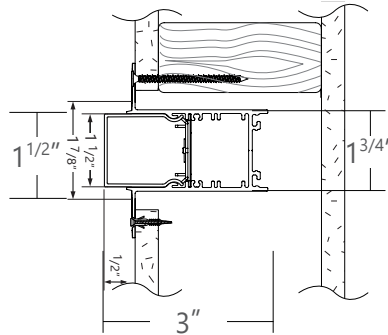

PERFORMANCE PER LINEAR FOOT AT 3500K

NOMINAL LUMEN OUTPUT	INPUT WATTS*	EFFICACY
300 lm/ft	3.25 W/ft	93 lm/W
400 lm/ft	4.4 W/ft	91 lm/W
500 lm/ft	5.55 W/ft	90 lm/W

* Based on a 4 foot flush luminaire using one driver



Ordering Guide

SCRV											
PRODUCT ID		NOM. LUMENS/FT		CRI		COLOR TEMP. (choose one)			SHIELDING		
SCRV	Recessed Vertical	300	300 lm/ft - Min	80	80 CRI	27	2700 K	TW2750	2700-5000 K - Tunable White	FL	flush*
		900	900 lm/ft - 90 CRI Max	90	90 CRI*	30	3000 K	TW2765	2700-6500 K - Tunable White	0.5M	0.5" StepLens, lum. end cap*
		1000	1000 lm/ft - 80 CRI Max			35	3500 K	BTW3527	3500-2700 K - Tunable BIOS	0.5P	0.5" StepLens, opaque end cap*
						40	4000 K	BTW4027	4000-2700 K - Tunable BIOS	2M	2" StepLens, lum. end cap*
						B30	3000 K - BIOS*			2P	2" StepLens, opaque end cap*
						B35	3500 K - BIOS*			+BL(#)	Blank (for flush option only)
						B40	4000 K - BIOS*			UB	Ultra blend lens (flush only)**
		Outputs between listed min and max are available. Consult factory for outputs outside of the listed range.		* Not available with BIOS.		Consult Axitune technical sheet for more information of color technology *Consult BIOS guide for more information on BIOS technology.			*Lens options use spotless lens ** Default lens for Tunable white and BIOS. Consult factory for other lens.		

LENGTH (FT)		FINISH		VOLTAGE		DRIVER		CIRCUITS	
#	2 ft - 12 ft continuous length	W	white	120	120 V	DP	dimming (0-10V) 1%	1	1 circuit
S(L)	System Run	BLK	black	277	277 V	LT	lutron	2	2 circuits
		C	custom	347	347 V	BI	bi-level dimming	+E(#)	emergency section*
				UNV	universal	O(#)	other**	+NL(#)	night light section*
				DC	low voltage*	DPB(STC)	dimming (0-10V) 1% with BIOS*	+GTD(#)	generator transfer device*
						DPB(DYN)	Bio-dimming™ 100%-81% with BIOS*		
						TW(#)	tunable white drivers*		
						POE(#)	POE drivers*		
SCULPT accommodates any length. Metric lengths also available, please consult factory.				* Only available with POE drivers.		*See page 2 to specify system **Please consult factory; see page 2		*Specify quantity	

MOUNTING / SUSPENSION		BATTERY (OPT.)		OTHER (OPT.)		REMOTE CONTROLS (OPT.)		CUSTOM (OPT.)	
D	drywall flangeless	B(#)	battery pack 4' sections	FW	flex whip (6' std)	DS(#)	daylight sensor*	C	custom
DB	slip-through bracket					OS(#)	occupancy sensor*		
DS	drywall spackle flange					DOS(#)	daylight & occupancy sensor*		
						EN(#)	Enlighted integral*		
						ENR(#)	Enlighted remote*		
						WC(#)	wireless control dimming		
		Not available with 347V Please consult factory		Other lengths available; please consult factory.		*Please consult factory Specify quantity. Requires 7" blank See integrated controls guide for more details. Consult factory for Tunable White. Not available with DPB (DYN) driver for BIOS with Dynamic Spectrum.		Please specify	

● ELECTRICAL

Lutron driver	LDE1 - Hi-lume 1% EcoSystem with Soft-on, Fade-to-Black
Other drivers**	DALI - Digital Addressable Lighting Interface DMX - Digital Multiplex Xitanium SR - For wireless sensor
BIOS DPB drivers*	STC - BIOS control 0-10V with static spectrum and BIOS SkyBlue enabled from 100% to 1%. DYN - BIOS control 0-10V with dynamic spectrum and BIOS SkyBlue® with Bio-Dimming™, which changes spectral qualities by removing the SkyBlue component when dimming from 100% to 81%, while light output remains relatively constant; bio-dimming reduces CCT to 2700K. Dimming from 80% to 1% will then reduce light output.
Tunable White TW drivers*	DALIDT6 - DALI Type 6 (Two DALI Addresses) DALIDT8 - DALI Type 8 (One DALI Address)
Power over Ethernet POE drivers*	MOLEX IGOR SMARTENGINE O - Other (Consult factory)
UL2108 certified for integral or remote driver	
Emergency	Integral emergency battery pack or emergency circuit optional.
Input Voltage	120V, 277V, 347V, UNV, DC.
Flex Whip	Shipped in a separate box for contractors to install

*Choose driver from available options.

i Incorporating these components may have limitations or affect the length of the luminaire. Please contact factory for more details.

● LED SYSTEM

CRI	Minimum 80 or 90 color rendering index.
CRI BIOS	Minimum 80 color rendering index with R9>75 for all CCTs.
CCT Single Color	Choice of 2700K, 3000K, 3500K and 4000K color temperature with a great color consistency (within 3-step MacAdam ellipse). Both within fixture and fixture to fixture.
CCT BIOS	BIOS Static (STC) Choice of 3000K, 3500K and 4000K. BIOS SkyBlue® Dynamic (DYN) Choice of 3000K, 3500K, and 4000K with Bio-Dimming™ BIOS Tunable White (BTW) Choice of 4000-2700K and 3500-2700K; does not use a bio-dimmer, it uses TW drivers, which allow independent control of CCT and intensity; e.g., BTW4027 provides combined SkyBlue + white light at 4000K, SkyBlue is removed at 2700K. Light output can be adjusted for each CCT. Consult BIOS guide for more information on BIOS technology.
CCT Axitune Systems	Consult Axitune technical sheet for more information on color technology.
LED life	Minimum 50,000h with 85% of lumen maintenance in 25°C ambient temperature, in compliance with IES LM-80 testing measurements.
Thermal Management	Aluminum housing acting as the heat sink to maximize life.
Environment	Dry and damp rated for indoor use only in operating ambient temperatures of 0-40°C (32-104°F).

CONSTRUCTION

Housing	Extruded aluminum (0.080" nominal) up to
End Cap	Die cast aluminum
Interior Brackets	Die formed sheet steel (20 gauge)
Lenses	Extruded acrylic (0.060" nominal) - injection moulded
Hanger	Die cast aluminum
Suspension	Sliding aircraft cable along product length
Cable Grips	Quick connecting / release

SYSTEM (S#)

SCULPT linear systems, with the use of a strong profile, allow for a nearly hair thin connection system of continuous runs. Lengths of 4', 8', 12' as well as custom lengths are available. Runs of SCULPT that are greater than 12' in length are designated as systems (S#). This means that the run is comprised of a combination of 4', 8' and/or 12' sections to be assembled on site using our joining system. For more information on systems and joining.

WEIGHT

Recessed Vertical 4 ft	8 lbs / 3.6 kg
Recessed Vertical 8 ft	16 lbs / 7.3 kg
Recessed Vertical 12 ft	24 lbs / 10.9 kg

FINISH

Powder coated and custom finishes are also available.

JOINERS

In order to allow very long runs of SCULPT luminaires, Axis has developed an effective joining system. Special care has been taken to maximize the performance of the joiner for each SCULPT option.

NOTE: Mount each system segment individually. Do not assemble system prior to mounting.

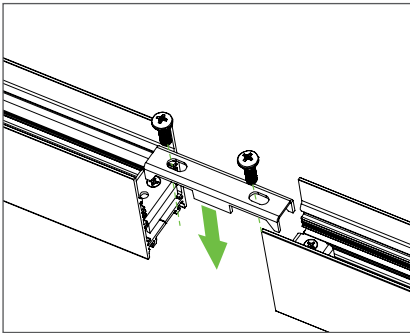

Allow a minimum of 6" between end of long runs and vertical wall

APPROVALS

Certified to UL and CSA standards
Suitable for damp locations.
IC Rated (Insulated ceiling)



WARRANTY

Limited 5-year warranty is available. Warranty is valid provided luminaires are installed and used according to specifications. For full terms and conditions, please consult warranty section at axislighting.com.

● SHIELDING - Frosted acrylic Spotless lens

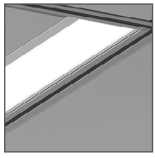

FL flush

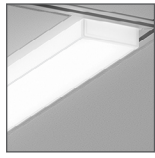

0.5M 0.5" StepLens,
lum. end cap



2M 2" StepLens,
lum. end cap

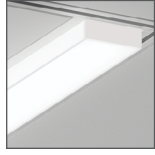

0.5P 0.5" StepLens,
opaque end cap

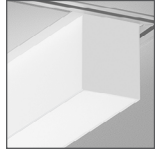

2P 2" StepLens,
opaque end cap



● CORNERS

i For custom corner, please consult factory. Specifications sheets for all corners are available at: www.axislighting.com

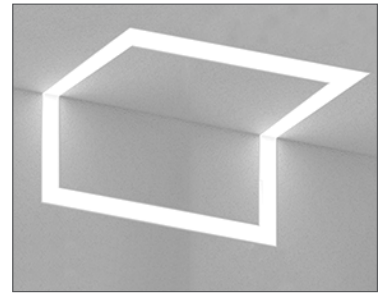

● DRYWALL CEILING MOUNTING OPTIONS - EX14005

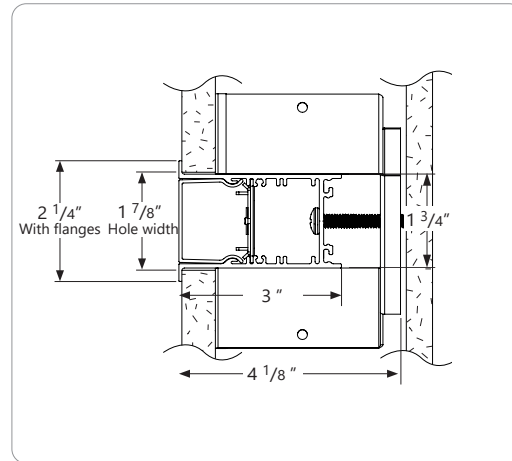
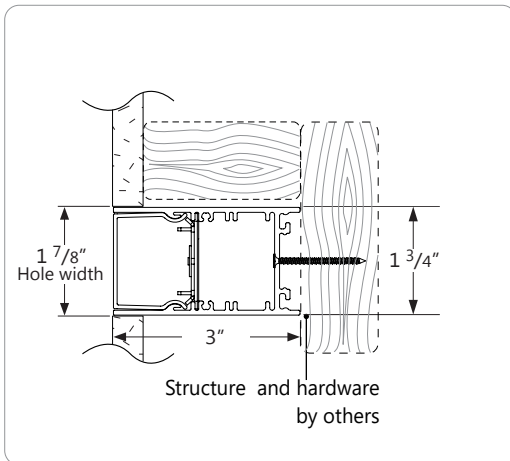

D DRYWALL FLANGELESS

DB SLIP-THROUGH BRACKET

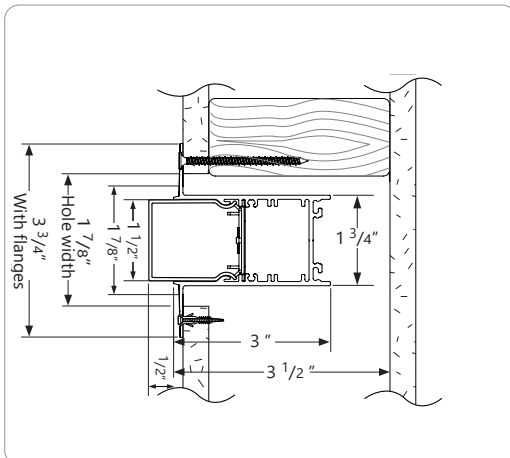

DS DRYWALL SPACKLE FLANGE

* MOUNTING HARDWARE IS NOT PROVIDED

● OTHER MOUNTING OPTIONS

SCULPT LED is also available with surface, wall and pendant mounted options.

i Specification sheets and Installation sheets for all mounting types for SCULPT luminaires are available for download at www.axislighting.com

Sculpt

RECESSED VERTICAL MOUNT

● PHOTOMETRIC DATA

500 lm/ft linear with Flush Lens

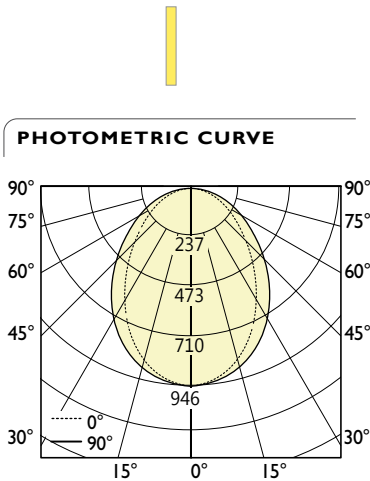

Lumen/ft down: 501 lm/ft
Total Lumens: 2004 lm (for 4ft)
Input Watts: 22.2 W
Efficacy: 90 lm/W

80 CRI shown. For 90 CRI, divide wattage by 0.8 and multiply efficacy by 0.8.
IES FILE:SCRV-500-80-35-F-4-W-UNV-D-1.IES

TESTED ACCORDING TO IES LM-79-2008

CANDELA DISTRIBUTION

Vertical Angle	Horizontal Angles				
	0	22.5	45	67.5	90
0	943	943	943	943	943
5	932	938	934	938	940
15	884	887	872	860	859
25	788	780	750	723	715
35	656	641	599	559	544
45	508	491	446	408	392
55	361	346	310	279	266
65	227	216	193	174	167
75	110	105	96	88	86
85	21	21	23	24	23
90	0	1	3	4	4

ZONAL LUMENS

Zone	Lumens
0	
0-10	89
10-20	245
20-30	345
30-40	375
40-50	346
50-60	280
60-70	194
70-80	103
80-90	27
90	1

LUMINANCE DATA (cd/m²)

Vertical Angle	Horizontal Angles		
	0	45	90
45	14871	13045	11453
55	13026	11161	9585
65	11088	9429	8163
75	8767	7698	6843
85	4868	5504	5504

i All IES files are available for download at: www.axislighting.com