

# Geometric

## RECESSED MOUNT



Project \_\_\_\_\_

Type \_\_\_\_\_

Notes \_\_\_\_\_

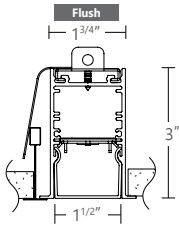

compatible with  
Armstrong ceiling system

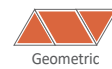

### Ordering Guide

SCRG	PRODUCT ID	NOM. LUMENS/FT	CRI	COLOR TEMP. (choose one)		SHIELDING
SCRG	Geometric Recessed	<b>300</b> 300 lm/ft - Minimum <b>900</b> 900 lm/ft - 90 CRI Maximum <b>1000</b> 1000 lm/ft - 80 CRI Maximum	<b>80</b> 80 CRI <b>90</b> 90 CRI	<b>27</b> 2700 K <b>30</b> 3000 K <b>35</b> 3500 K <b>40</b> 4000 K	<b>TW2750</b> 2700-5000 K - Tunable White <b>TW2765</b> 2700-6500 K - Tunable White	<b>FL</b> flush* <b>UB</b> Ultra blend lens (flush)**
		Outputs between listed min and max are available. Consult factory for outputs outside of the listed range.		<a href="#">Consult Axitune technical sheet for more information on color technology.</a>		*Lens options use spotless lens ** Default lens for Tunable white. Consult factory for other lens.

Geometric CEILING KIT (select one)			FINISH	VOLTAGE		DRIVER
Triangle	Parallelogram	Trapeze				
<b>TR75X2</b> 75° - 2'	<b>PP75X2</b> 75° positive - 2'	<b>TP75X2</b> 75° - 2'	<b>W</b> white	<b>120</b> 120 V	<b>DP</b> dimming (0-10V) 1% <b>LT</b> lutron	<b>BI</b> bi-level dimming <b>O(#)</b> other** <b>TW(#)</b> tunable white drivers*
<b>TR75X4*</b> 75° - 4'	<b>PN75X2</b> 75° negative - 2'	<b>TP75X4*</b> 75° - 4'	<b>BLK</b> black	<b>277</b> 277 V		
<b>TR60X2</b> 60° - 2'	<b>PP75X4*</b> 75° positive - 4'	<b>TP60X2</b> 60° - 2'	<b>C</b> custom	<b>347</b> 347 V	<b>UNV</b> universal <b>DC</b> low voltage*	<b>POE(#)</b> POE drivers*
<b>TR60X4*</b> 60° - 4'	<b>PN75X4*</b> 75° negative - 4'	<b>TP45X2</b> 45° - 2'				
<b>TR45X2</b> 45° - 2'	<b>PP60X2</b> 60° positive - 2'					
<b>TR90X2</b> 90° right - 2'	<b>PN60X2</b> 60° negative - 2'					
<b>TR90X4*</b> 90° right - 4'	<b>PP60X4*</b> 60° positive - 4'					
<b>TRP904X2</b> 90° positive right - 2'x4'	<b>PN60X4*</b> 60° negative - 4'					
<b>TRN904X2</b> 90° negative right - 2'x4'	<b>PP45X2</b> 45° positive - 2'					
	<b>PN45X2</b> 45° negative - 2'					
Available as kit; See pages 2-3 for more details; All shapes available with <b>MFTG9</b> 9/16" Silhouette grid system. *Available with <b>MFTG9</b> 9/16" Silhouette and with the <b>MFTB15</b> 15/16" Prelude grid systems.				* Only available with POE drivers.	*See page 5 to specify system **Please consult factory; see page 5	

CIRCUITS	MOUNTING	BATTERY (OPTIONAL)	OTHER (OPTIONAL)	IC CONTROL (OPTIONAL)	CUSTOM
<b>1</b> 1 circuit <b>2</b> 2 circuits <b>+E(#)</b> emergency section* <b>+NL(#)</b> night light section* <b>+GTD(#)</b> generator transfer device*	<b>MFTB15</b> MiniFlange t-bar 15/16" * <b>MFTG9</b> MiniFlange 9/16" t-tegular *	<b>B(#)</b> battery pack 4' sections	<b>FW</b> flex whip (6' std)* <b>CP</b> Chicago plenum	<b>DS(#)</b> daylight sensor* <b>OS(#)</b> occupancy sensor* <b>DOS(#)</b> daylight & occupancy sensor* <b>EN(#)</b> enlightened integral* <b>ENR(#)</b> enlightened remote** <b>WC(#)</b> wireless control dimming	<b>C</b> custom
* Specify quantity	* See page 6 for Armstrong ceiling compatibility.	Not available with 347V Please consult factory	* Other lengths available; please consult factory.	* For flush option only; Please consult factory ** Please consult factory Specify quantity. Requires 7" blank <a href="#">See integrated controls guide for more details.</a> Not available with Tunable White.	Please specify

### ● GEOMETRIC FORM OPTIONS

75°

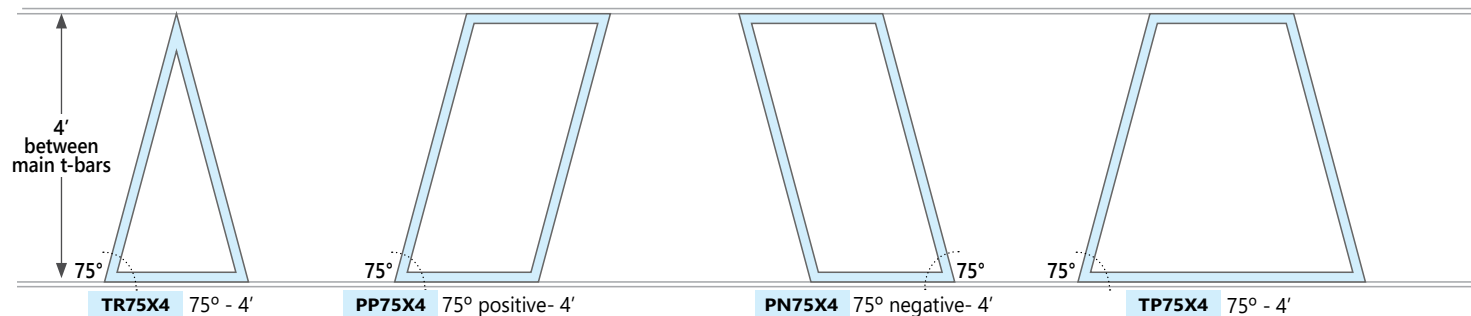
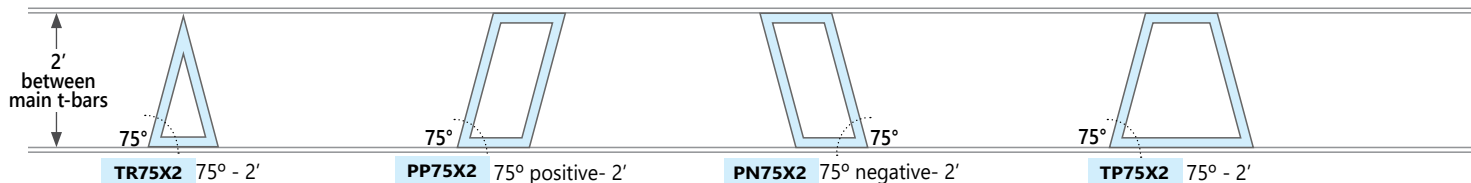

60°

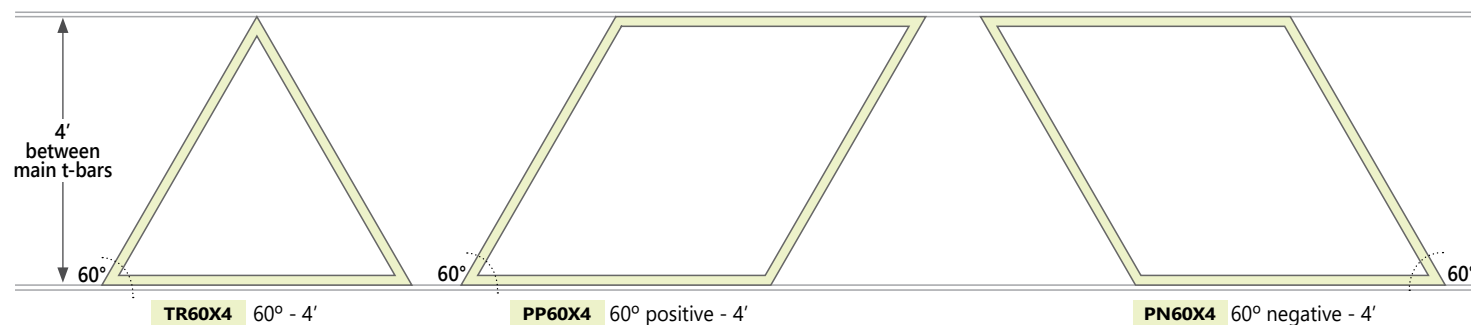
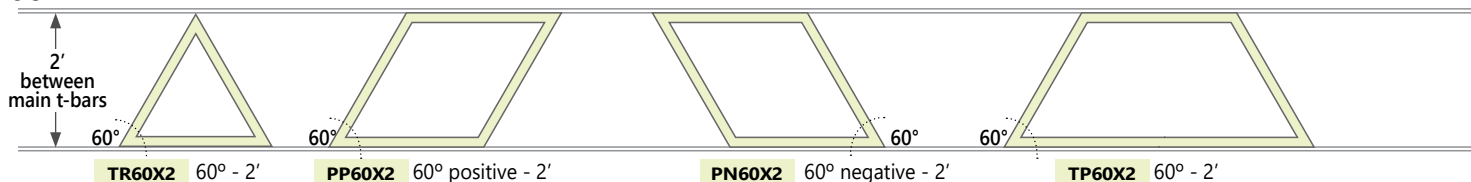

45°

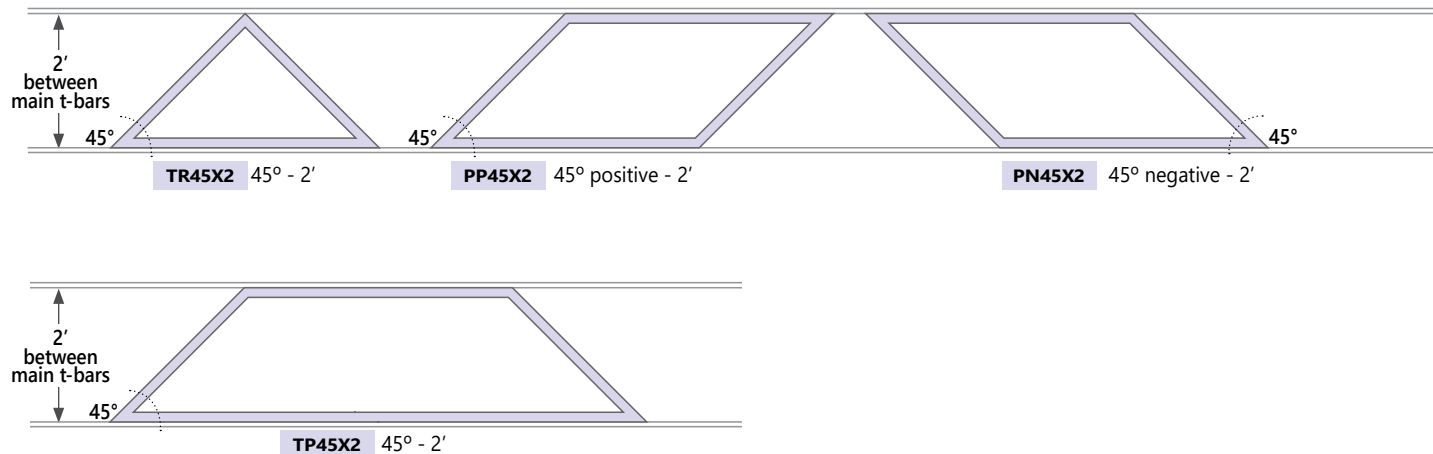

### 90° Right Triangles

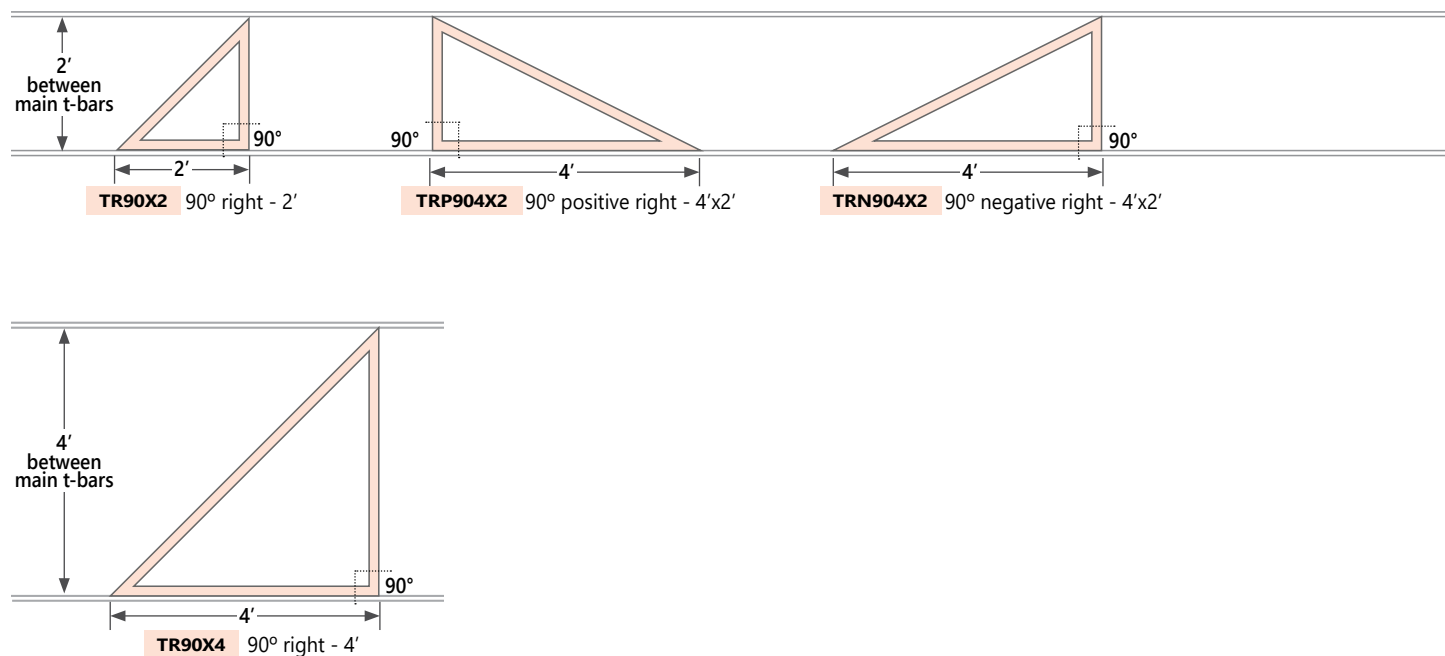

# Geometric



## Uniquely shaped lighting elements for creative ceiling designs

Enjoy freedom from traditional ceiling footprints with a recessed family of 23 precision-tooled triangles, parallelograms and trapezoids. Discover new and exciting opportunities above and beyond the norm for architectural ceilings, brought to you by industry leaders Axis Lighting and Armstrong Ceiling Solutions.

## Geometric Lighting Benefits

- Visually comfortable and esthetically pleasing traces of light.
- Seamless integration with DESIGNFlex™ by Armstrong.
- Easy installation – DESIGNFlex features pre-cut tile inserts.
- Ceiling kits include all the required lightingware and hardware.

An exclusive palette of non-rectangular recessed lighting elements compatible with Armstrong DESIGNFlex Ceiling System.

### 75°

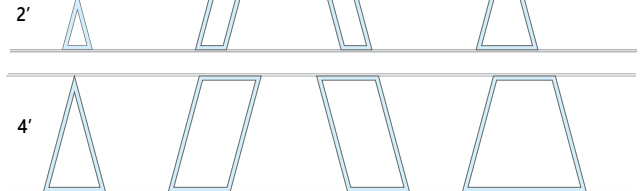

### 60°

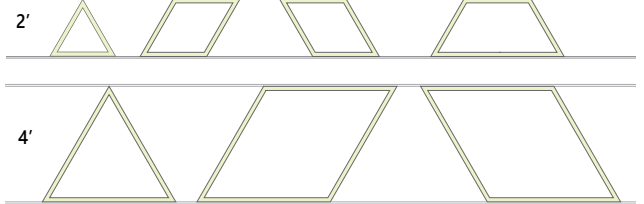

### 45°

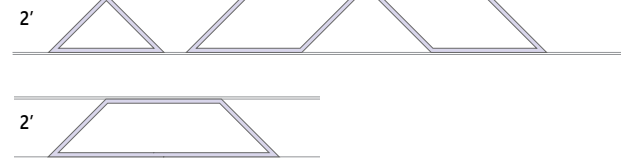

### 90° Right Triangles

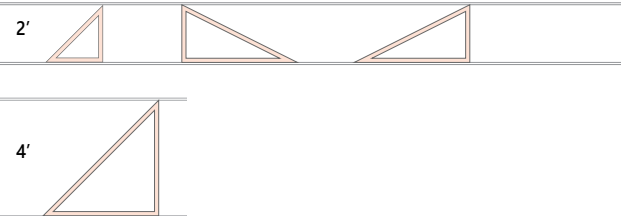

### ● CONSTRUCTION

<b>Housing</b>	Extruded aluminum (0.080" nominal) up to
<b>End Cap</b>	Die cast aluminum
<b>Interior Brackets</b>	Die formed sheet steel (20 gauge)
<b>Lenses</b>	Extruded acrylic (0.060" nominal) - injection moulded
<b>Hanger</b>	Die cast aluminum
<b>Suspension</b>	Sliding aircraft cable along product length
<b>Cable Grips</b>	Quick connecting / release

### ● ELECTRICAL

<b>Lutron driver</b>	LDE1 - Hi-lume 1% EcoSystem with Soft-on, Fade-to-Black
<b>Other drivers**</b>	DALI - Digital Addressable Lighting Interface DMX - Digital Multiplex Xitanium SR - For wireless sensor
<b>Tunable White TW drivers*</b>	DALIDT6 - DALI Type 6 (Two DALI Addresses) DALIDT8 - DALI Type 8 (One DALI Address)
<b>Power over Ethernet POE drivers*</b>	MOLEX IGOR SMARTENGINE O - Other (Consult factory)
<b>Emergency</b>	Integral emergency battery pack or emergency circuit optional.
<b>Input Voltage</b>	120V, 277V, 347V, UNV, DC.
<b>Flex Whip</b>	Shipped in a separate box for contractors to install

\*Choose driver from available options.

**i** Incorporating these components may have limitations or affect the length of the luminaire. Please contact factory for more details.

### ● APPROVALS

Certified to UL and CSA standards   
Meets CEC requirements (Chicago plenum)  
Suitable for damp locations.  
IC Rated (Insulated ceiling)

### ● LED SYSTEM

<b>CRI</b>	Minimum 80 or 90 color rendering index.
<b>CCT Single Color</b>	Choice of 2700K, 3000K, 3500K and 4000K color temperature with a great color consistency (within 3-step MacAdam ellipse). Both within fixture and fixture to fixture.
<b>CCT Axitune Systems</b>	<a href="#">Consult Axitune technical sheet for more information on color technology.</a>
<b>LED life</b>	Minimum 50,000h with 85% of lumen maintenance in 25°C ambient temperature, in compliance with IES LM-80 testing measurements.
<b>Thermal Management</b>	Aluminum housing acting as the heat sink to maximize life.
<b>Environment</b>	Dry and damp rated for indoor use only in operating ambient temperatures of 0-40°C (32-104°F).

### ● WARRANTY

Limited 5-year warranty is available. Warranty is valid provided luminaires are installed and used according to specifications. For full terms and conditions, please consult warranty section at [axislighting.com](http://axislighting.com).

### ● SHIELDING - Frosted acrylic Spotless lens

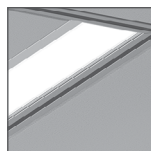

FL flush

### ● FINISH

Powder coated and custom finishes are also available.

### ● KIT AND LINEAR - WITH INTEGRATED MINIFLANGE

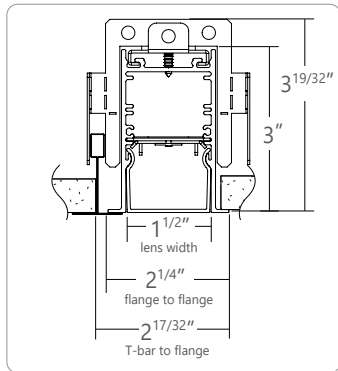

**MFTB15** MiniFlange 15/16" T-BAR

Prelude ceiling system by  
Armstrong

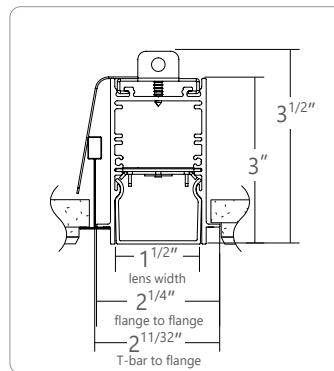

**MFTG9** MiniFlange 9/16" T-TEGULAR

Suprafine ceiling system by  
Armstrong

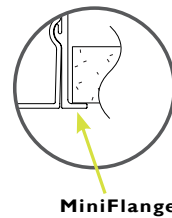

MiniFlange

### Integrated MiniFlange (patent pending)

When installed along T-bars in acoustic ceilings, the Integrated MiniFlange supports adjacent ceiling tiles. At the same time, it **eliminates the need for a second T-bar**. This feature comes standard on Sculpt Recessed.

- Fewer materials needed and less labor.
- Conceals ceiling tile cutline for a cleaner appearance.
- Simplifies drawings and trade coordination.
- Available in different T-bar profiles.

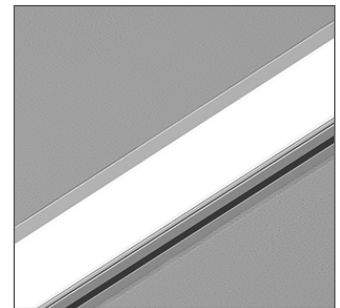

With Integrated MiniFlange