

Project _____

Type _____

Notes _____

PERFORMANCE PER LINEAR FOOT AT 3500K AND 80 CRI

NOMINAL LUMEN OUTPUT	INPUT WATTS*	EFFICACY
1000 lm/ft	8 W/ft	130 lm/W

Please consult factory for custom lumen output and wattage.



Ordering Guide

MBWVLED									
PRODUCT ID		NOM.LUMENS/FT		CRI		COLOUR TEMP. (choose one)		SHIELDING	
MBWVLED	MINI BOX Wall Vertical LED	500	500 lm/ft - Min	80	80 CRI	27 2700 K	TW2750	2700-5000 K - Tunable White	S satin lens
		1000	1000 lm/ft - Max	90	90 CRI*	30 3000 K	TW2765	2700-6500 K - Tunable White	
						35 3500 K	BTW3527	3500-2700 K - Tunable BIOS	
						40 4000 K	BTW4027	4000-2700 K - Tunable BIOS	
						B30 3000 K - BIOS*			
						B35 3500 K - BIOS*			
						B40 4000 K - BIOS*			
		Outputs between listed min and max are available. Consult factory for outputs outside of the listed range. Consult factory for max output with BIOS		* Not available with BIOS.		Consult Axitune technical sheet for more information on color technology. *Consult BIOS guide for more information on BIOS technology			
									1' increment, minimum 2'
									S(L) system run
									AP aluminum paint
									W white
									BLK black
									C custom

VOLTAGE	DRIVER	CIRCUITS	BATTERY (OPTIONAL)	IC CONTROLS (OPTIONAL)
120 120 V	DP dimming (0-10V) 1%	1 1 circuit	B(#) battery pack 4' sections	DS(#) daylight sensor
277 277 V	LT(#) Lutron*	2 2 circuits		OS(#) occupancy sensor
347 347 V	BI bi-level dimming	+E(#) emergency circuit*		DOS(#) daylight & occupancy sensor
UNV universal	O(#) other**	+NL(#) night light circuit*		EN(#) Enlighted integral*
DC low voltage*	DPB(STC) dimming (0-10V) 1% with BIOS*	+GTD(#) generator transfer device*		ENR(#) Enlighted remote**
	DPB(DYN) Bio-dimming™ 100%-81% with BIOS*			WC(#) wireless control dimming
	TW(#) tunable white drivers*			
	POE(#) POE drivers*			
* Only available with POE drivers.	*See page 2 to specify system **Please consult factory; see page 2	* Specify quantity	Specify quantity Please consult factory Not available with 347V	* For flush option only; Please consult factory ** Please consult factory Specify quantity. Requires 8" blank See integrated controls guide for more details. Consult factory for Tunable White. Not available with DPB (DYN) driver for BIOS with Dynamic Spectrum.

CUSTOM (OPTIONAL)	
C	custom
Please specify	

ELECTRICAL

Lutron driver	LDE1 - Hi-lume 1% EcoSystem with Soft-on, Fade-to Black
Other drivers**	DALI - Digital Addressable Lighting Interface DMX - Digital Multiplex Xitanium SR - For wireless sensor
BIOS DPB drivers*	STC - BIOS control 0-10V with static spectrum and BIC SkyBlue enabled from 100% to 1%. DYN - BIOS control 0-10V with dynamic spectrum and BIOS SkyBlue® with Bio-Dimming™, which changes spectral qualities by removing the SkyBlue component when dimming from 100% to 81%, while light output remains relatively constant; bio-dimming reduces CCT 2700K. Dimming from 80% to 1% will then reduce light output.
Tunable White TW drivers*	DALIDT6 - DALI Type 6 (Two DALI Addresses) DALIDT8 - DALI Type 8 (One DALI Address)
Power over Ethernet POE drivers*	MOLEX IGOR SMARTENGINE O - Other (Consult factory)
Emergency	Integral emergency battery pack or emergency circuit optional.
Input Voltage	120V, 277V, 347V, UNV, DC.
Flex Whip	Shipped in a separate box for contractors to install

*Choose driver from available options.

i Incorporating these components may have limitations or affect the length of the luminaire. Please contact factory for more details.

SYSTEMS (S#)

Runs of MINI BOX that are greater than 12ft in length are designated as systems (S#). This means that the run is comprised of a combination of sections to be assembled on site using our joining system. The run is comprised of a combination of sections to be assembled on site using our joining system, maximum 4' lens with joining end cap. For more information on systems and joining, please refer to the MINI BOX installation sheets available for download at www.axislighting.com

WEIGHT

MINI BOX Wall Vertical 4 ft	8.4 lbs / 3.9 Kg
MINI BOX Wall Vertical 8 ft	16.8 lbs / 7.7 Kg
MINI BOX Wall Vertical 12 ft	25.2 lbs / 11.6 Kg

LED SYSTEM

CRI	Minimum 80 or 90 color rendering index.
CRI BIOS	Minimum 80 color rendering index with R9>75 for all CCTs.
CCT Single Color	Choice of 2700K, 3000K, 3500K and 4000K color temperature with a great color consistency (within 3-step MacAdam ellipse). Both within fixture and fixture to fixture.
CCT BIOS	BIOS Static (STC) Choice of 3000K, 3500K and 4000K. BIOS SkyBlue® Dynamic (DYN) Choice of 3000K, 3500K, and 4000K with Bio-Dimming™ BIOS Tunable White (BTW) Choice of 4000-2700K and 3500-2700K; does not use a bio-dimmer, it uses TW drivers, which allow independent control of CCT and intensity; e.g., BTW4027 provides combined SkyBlue + white light at 4000K, SkyBlue is removed at 2700K. Light output can be adjusted for each CCT. Consult BIOS guide for more information on BIOS technology.
CCT Axitune Systems	Consult Axitune technical sheet for more information on color technology.
LED life	Minimum 50,000h with 85% of lumen maintenance in 25°C ambient temperature, in compliance with IES LM-80 testing measurements.
Thermal Management	Aluminum housing acting as the heat sink to maximize life.
Environment	Dry and damp rated for indoor use only in operating ambient temperatures of 0-40°C (32-104°F).

FINISH

Powder coated and custom finishes are also available.

WARRANTY

Limited 5-year warranty is available. Warranty is valid provided luminaires are installed and used according to specifications. For full terms and conditions, please consult warranty section at axislighting.com.

● MOUNTING - 2"X4" J-BOX

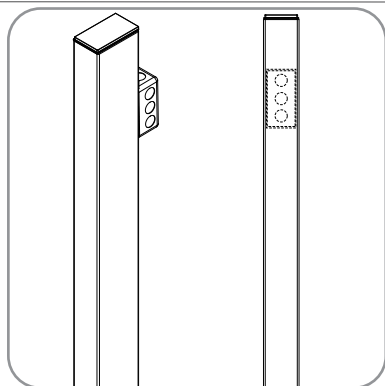

2"X4" J-BOX

● OPTICS OPTIONS

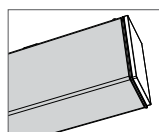

S satin lens

SATIN LENS

PMMA satin finish (0.060" nominal)

● LIGHT DISTRIBUTION



semi direct

● OTHER MOUNTING OPTIONS

MINI BOX is also available in pendant and surface mounted options.

i Specification sheets for all mounting options are available for download at www.axislighting.com

● APPROVALS

Certified to UL and CSA standards
Meets ADA requirements.
Suitable for damp locations.



● PHOTOMETRIC DATA

1000 lm/ft

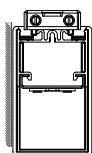

PHOTOMETRIC CURVE

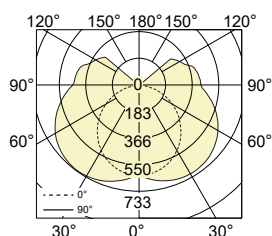

Lumen/ft down: 1000 lm/ft
Total Lumens: 4187 lm (for 4ft)
Input Watts: 32.1 W
Efficacy: 130 lm/W
IES FILE: MBWVLED-1000-80-35-S-4.IES

TESTED ACCORDING TO IES LM-79-2008

CANDELA DISTRIBUTION

Vertical Angle	Horizontal Angles				
	0	22.5	45	67.5	90
0	626	626	626	626	626
5	625	634	642	648	650
15	601	631	659	680	688
25	556	608	658	695	709
35	492	564	638	692	712
45	412	504	599	670	696
55	323	427	543	628	660
65	226	343	474	570	607
75	128	255	395	500	539
85	43	174	318	422	462
90	5	141	287	393	433
95	4	139	285	389	429
105	5	133	268	373	410
115	5	109	227	313	351
125	6	88	202	278	311

ZONAL LUMENS

Zone	Lumens
0	
0-10	61
10-20	185
20-30	301
30-40	395
40-50	455
50-60	477
60-70	458
70-80	405
80-90	333
90	
90-100	289
100-110	264
110-120	212
120-130	164
130-140	
140-150	
150-160	
160-170	
170-180	187
180	

LUMINANCE DATA (cd/m²)

Vertical Angle	Horizontal Angles		
	0	45	90
45	7800	7193	7361
55	7390	6885	7179
65	6823	6570	7014
75	5951	6257	6861
85	4589	6087	6787

i All IES files are available for download at: www.axislighting.com