

Project _____

Type _____

Notes _____

PERFORMANCE PER LINEAR FOOT AT 4000K

NOMINAL LUMEN OUTPUT	INPUT WATTS*	EFFICACY
400 lm/ft	4 W/ft	99 lm/W
500 lm/ft	4.9 W/ft	100 lm/W
630 lm/ft	6.2 W/ft	102 lm/W
750 lm/ft	7.5 W/ft	100 lm/W
900 lm/ft	7.7 W/ft	117 lm/W

* Based on a 4 foot luminaire using one driver
Please consult factory for custom lumen output and wattage.



Ordering Guide

CLKLED								SO			
PRODUCT ID		NOM. LUMENS/FT		CRI		COLOR TEMP.		SHIELDING		LENGTH (FT)	
CLKLED	Click LED	400	400 lm/ft - Minimum	80	80 CRI	27	2700 K	SO	Spotless lens	2	2' *
		900	900 lm/ft - Maximum	90	90 CRI	30	3000 K			2.5	2.5' **
						35	3500 K			3	3'
						40	4000 K			4	4' *
										5	5' **
										6	6' *
										7.5	7.5' **
										8	8' *
										S(L)	system run
		Outputs between listed min and max are available. Consult factory for outputs outside of the listed range.						Using spotless lens		* Match to 24" T-bar spacing ** Match to 30" T-bar spacing Multiple of 10' match both T-bar spacing	

FINISH	VOLTAGE	DRIVER	CIRCUITS	MOUNTING OPTIONS
W white	120 120 V	DP dimming (0-10V) 1%	1 1 circuit	TG9 tegular 9/16"
BLK black	277 277 V	LT Lutron	2 2 circuits	ST screw slot t-bar
C custom	347 347 V	BI bi-level dimming	+E(#) emergency circuit *	DS drywall spackle flange *
	UNV universal	O(#) other **	+NL(#) night light circuit *	AC Armstrong ceiling and Direct Light Covers **
	DC low voltage*	POE(#) POE drivers*	+GTD(#) generator transfer device *	
* Only available with POE drivers.		*See page 2 to specify system ** Please consult factory; see page 2	* Specify quantity	* See page 4 for more information. ** For more information, see page 3.

BATTERY (OPT.)	OTHER (OPTIONAL)	CUSTOM (OPTIONAL)
B(#) battery pack integral	FW flex whip (6' std)* CP Chicago plenum	C custom
For 2.5' or less - remote only Please consult factory Not available with 347V	* Other lengths available; please consult factory.	Please specify

CONSTRUCTION

Housing	Extruded aluminum (0.075" nominal) Up to 70% recycled content
T-Bar Bracket	Die formed sheet steel (16 gauge)
Screw Slot T-Bar Bracket	Die formed sheet steel (16 gauge)
Slip-Through Bracket	Die formed sheet steel (18 gauge)
Spackle Flange	Die formed perforated sheet steel (20 gauge)
Flange	Extruded aluminum (0.075" nominal) Visible flange width: 9/16"
Interior Brackets	Die formed sheet steel (18 gauge)
Reflectors	White powder coated sheet steel (22 gauge)
Blank	Extruded aluminum (0.075" nominal)
Lens	Spotless frosted acrylic lens

ELECTRICAL

Lutron driver	LDE1 - Hi-lume 1% EcoSystem with Soft-on, Fade-to-Black
Other drivers**	DALI - Digital Addressable Lighting Interface DMX - Digital Multiplex Xitanium SR - For wireless sensor
Power over Ethernet POE drivers*	MOLEX IGOR SMARTENGINE O - Other (Consult factory) *Consult factory
Emergency	Integral emergency battery pack or emergency circuit optional.
Input Voltage	120V, 277V, 347V, UNV.
Flex Whip	Shipped in a separate box for contractors to install

i Incorporating these components may have limitations or affect the length of the luminaire. Please contact factory for more details.

SYSTEM (S#)

Click LED linear systems, with the use of a strong profile, allow for a nearly hair thin connection system of continuous runs. Lengths of 4', 8', 12' as well as custom lengths are available. Runs of Click LED that are greater than 12' in length are designated as systems (S#). This means that the run is comprised of a combination 4', 8' and/or 12' sections to be assembled on site using our joining system. For more information on systems and joining, please refer to the Click LED installation sheets available for download at www.axislighting.com.

WARRANTY

Limited 5-year warranty is available. Warranty is valid provided luminaires are installed and used according to specifications. For full terms and conditions, please consult warranty section at axislighting.com.

OPTICS



50 Spotless Lens

SPOTLESS LENS

Frosted acrylic snap-in lens with micro lens

FINISHES

Powder coated and custom finishes are also available.

APPROVALS

Certified to UL and CSA standards 
Meets NYC requirements
Meets CCEC requirements (Chicago plenum)
Suitable for damp locations for indoor use only
IC Rated (Insulated ceiling)

WEIGHT

Recessed LED 4 ft	10.5 lbs / 4.8 kg
Recessed LED 8 ft	21.0 lbs / 9.6 kg
Recessed LED 12 ft	31.5 lbs / 14.4 kg

JOINERS

Click LED luminaires feature InstaJoiner, a unique joining system developed by Axis offering fast, single-screw tightening.

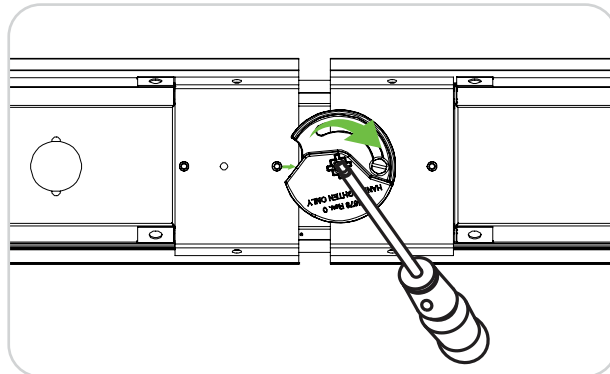

Tighten until fixtures are together and snug. **Do not overtighten joiner once fixtures are joined together.**

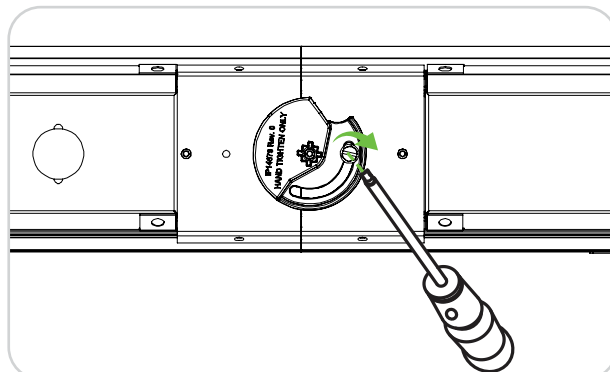

If extrusions do not close, check to make sure there are no wires pinched between extrusions. Tighten screw on the circular joiner.

MOUNTING OPTIONS

● STANDARD GRID CEILINGS

Only one Click fixture compatible with all ceiling systems listed below. Coordination is required with the ceiling specification to achieve the desired installation detail.

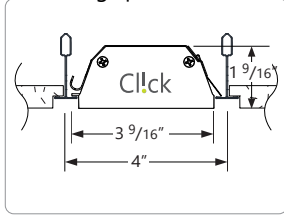

TG9 TEGULAR 9/16"

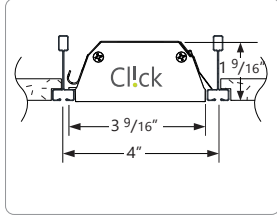

ST SCREW SLOT T-BAR

● DRYWALL SYSTEM

Drywall kit provided by Axis. See page 4.

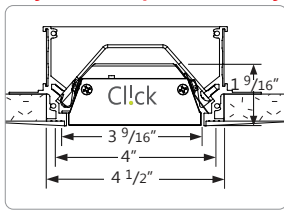

DS DRYWALL SPACKLE FLANGE

● ARMSTRONG DIRECT LIGHT COVE SYSTEMS

Drywall kit provided by Armstrong. [See ordering page.](#)

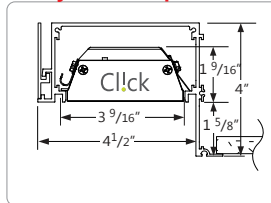

AC ARMSTRONG 4" AXIOM DIRECT LIGHT COVE

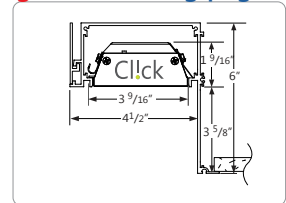

AC ARMSTRONG 6" AXIOM DIRECT LIGHT COVE

● ARMSTRONG SHALLOW CEILING SYSTEMS

Only Armstrong grid systems are available with the patented Lighting Bracket Connector for shallow grid installations of luminaires over 4' in length.

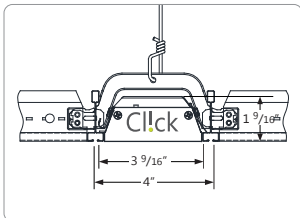

AC ARMSTRONG SILHOUETTE® GRID SYSTEM

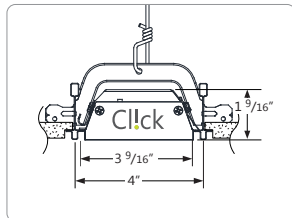

AC ARMSTRONG INTERLUDE® GRID SYSTEM

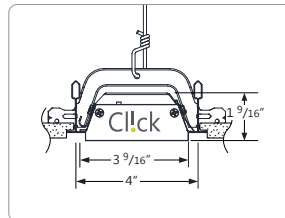

AC ARMSTRONG SUPRAFINE® GRID SYSTEM

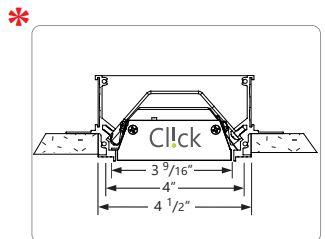

AC ARMSTRONG DRYWALL GRID SYSTEM

TECHZONE® GRID SYSTEMS



* Drywall kit provided by Armstrong. See page 4 for more details and refer to the provided link.

ATTENTION! Lighting Connector Brackets (LCB4) are supplied by others and must be installed prior the lighting fixture installation. LCB4 must be located 2' from ends and every 4' on center of all the luminaire runs.

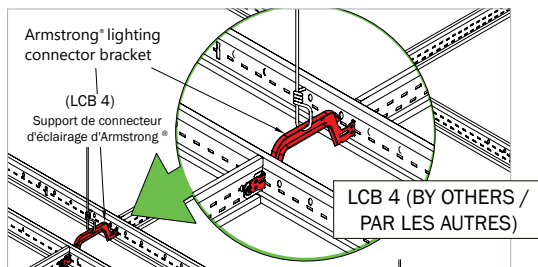

● Drywall Kit System

DS - DRYWALL SPACKLE FLANGE

Drywall Kit System is provided by Axis with drywall spackle flange (DS) mounting option.

ITEM NO.	Description
DGSLTK24	2' Linear Light Trim Kit 24" x 4"
DGSLTK30	2' – 6" Linear Light Trim Kit 30" x 4"
DGSLTK36	3' Linear Light Trim Kit 36" x 4"
DGSLTK48	4' Linear Light Trim Kit 48" x 4"
DGSLTK60	5' Linear Light Trim Kit 60" x 4"
DGSLTK72	6' Linear Light Trim Kit 72" x 4"
DGSLTK90	7' – 6" Linear Light Trim Kit 90" x 4"
DGSLTK96	8' Linear Light Trim Kit 96" x 4"

Linear Light Trim Kits designed to work with 5/8" drywall

Trim Kit Components Included

1. Aluminum Extrusions (2)
2. Connector Bracket (varies)
3. End Plates (2)
4. #8-32 x 5/16" Pan Head Machine Screws
5. #6-20 x 5/8" Pan Head Sharp Point Screws

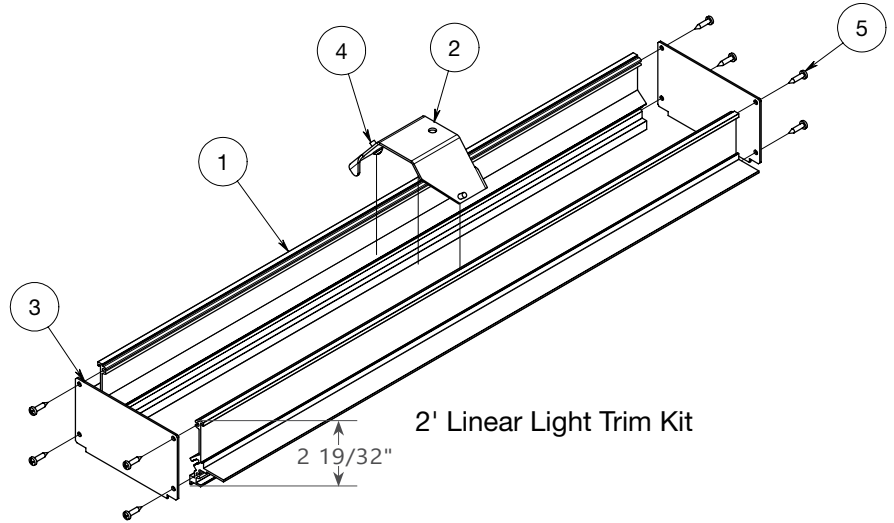

AC - ARMSTRONG CEILING AND DIRECT LIGHT COVES

With AC Drywall Grid System (AC) mounting option selected Drywall Kit supplied by Armstrong and has to be ordered separately, please follow the link for specifications and ordering.

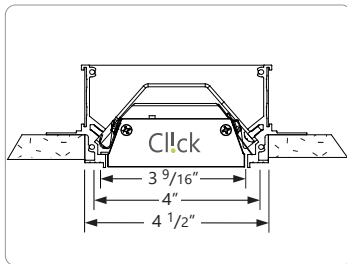

AC ARMSTRONG DRYWALL GRID SYSTEM



● PHOTOMETRIC DATA

400 lm/ft

PHOTOMETRIC CURVE

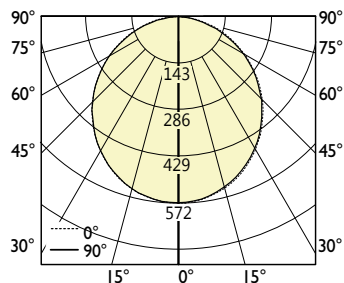

Luminaire Lumens: 400 lm/ft

Input Watts: 16 W

Efficacy: 99 lm/W

80 CRI shown. For 90 CRI, divide wattage by 0.8 and multiply efficacy by 0.8.

IES FILE: CLKLED-400-80-35-SO-4.IES

TESTED ACCORDING TO IES LM-79-2008

CANDELA DISTRIBUTION

Vertical Angle	Horizontal Angles				
	0	22.5	45	67.5	90
0	571	571	571	571	571
5	569	569	568	568	567
15	547	546	545	544	543
25	503	503	502	500	499
35	443	442	441	439	438
45	369	369	368	367	365
55	286	286	285	283	282
65	199	198	197	194	193
75	112	111	110	105	102
85	31	31	31	28	26
90	0	0	0	0	0

ZONAL LUMENS

Zone	Lumens
0	
0-10	53
10-20	153
20-30	230
30-40	275
40-50	283
50-60	254
60-70	194
70-80	115
80-90	34
90	

LUMINANCE DATA (cd/m²)

Vertical Angle	Horizontal Angles		
	0	45	90
45	4368	3652	3431
55	4133	3236	2982
65	3841	2710	2416
75	3410	1996	1625
85	2406	865	594

500 lm/ft

PHOTOMETRIC CURVE

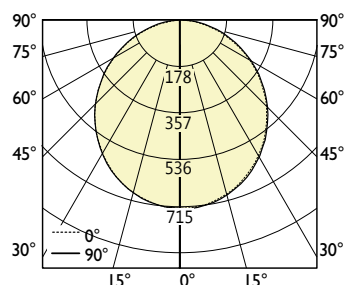

Luminaire Lumens: 500 lm/ft

Input Watts: 19.8 W

Efficacy: 100 lm/W

80 CRI shown. For 90 CRI, divide wattage by 0.8 and multiply efficacy by 0.8.

IES FILE: CLKLED-500-80-35-SO-4.IES

TESTED ACCORDING TO IES LM-79-2008

CANDELA DISTRIBUTION

Vertical Angle	Horizontal Angles				
	0	22.5	45	67.5	90
0	713	713	713	713	713
5	712	711	710	710	709
15	684	683	682	680	679
25	629	629	627	625	624
35	554	553	551	549	548
45	462	462	460	458	456
55	358	358	356	354	352
65	249	248	247	243	241
75	140	139	137	132	128
85	39	39	39	36	32
90	0	0	0	0	0

ZONAL LUMENS

Zone	Lumens
0	
0-10	67
10-20	192
20-30	288
30-40	344
40-50	354
50-60	318
60-70	243
70-80	144
80-90	42
90	

LUMINANCE DATA (cd/m²)

Vertical Angle	Horizontal Angles		
	0	45	90
45	5469	4565	4286
55	5174	4043	3722
65	4807	3398	3017
75	4263	2486	2039
85	3027	1088	731

i All IES files are available for download at: www.axislighting.com

● PHOTOMETRIC DATA

630 lm/ft

PHOTOMETRIC CURVE

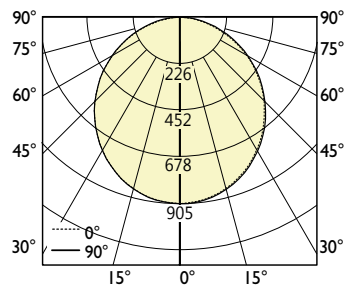

Luminaire Lumens: 630 lm/ft
Input Watts: 24.6 W
Efficacy: 102 lm/W

80 CRI shown. For 90 CRI, divide wattage by 0.8 and multiply efficacy by 0.8.
 IES FILE: CLKLED-630-80-35-SO-4.ies

TESTED ACCORDING TO IES LM-79-2008

CANDELA DISTRIBUTION

Vertical Angle	Horizontal Angles				
	0	22.5	45	67.5	90
0	904	904	904	904	904
5	901	900	900	899	898
15	866	865	864	862	860
25	797	796	795	792	791
35	702	700	698	696	694
45	585	585	582	581	577
55	453	454	451	449	446
65	315	315	313	308	305
75	177	176	174	167	162
85	50	50	50	45	41
90	0	0	0	0	0

ZONAL LUMENS

Zone	Lumens
0	
0-10	85
10-20	243
20-30	365
30-40	436
40-50	449
50-60	403
60-70	308
70-80	182
80-90	54
90	

LUMINANCE DATA (cd/m²)

Vertical Angle	Horizontal Angles		
	0	45	90
45	6925	5776	5424
55	6547	5121	4716
65	6081	4306	3818
75	5389	3158	2581
85	3881	1395	937

750 lm/ft

PHOTOMETRIC CURVE

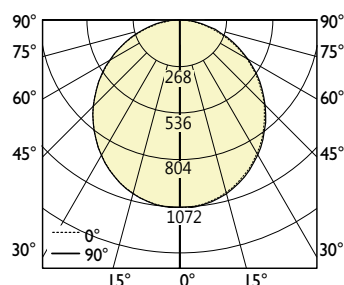

Luminaire Lumens: 750 lm/ft
Input Watts: 29.8 W
Efficacy: 100 lm/W

80 CRI shown. For 90 CRI, divide wattage by 0.8 and multiply efficacy by 0.8.
 IES FILE: CLKLED-750-80-35-SO-4.IES

TESTED ACCORDING TO IES LM-79-2008

CANDELA DISTRIBUTION

Vertical Angle	Horizontal Angles				
	0	22.5	45	67.5	90
0	1070	1070	1070	1070	1070
5	1068	1067	1066	1065	1064
15	1026	1025	1023	1021	1019
25	944	943	941	938	937
35	831	829	827	824	822
45	693	693	690	688	684
55	537	537	534	532	528
65	373	373	370	365	362
75	210	209	206	198	192
85	59	59	59	54	48
90	0	0	0	0	0

ZONAL LUMENS

Zone	Lumens
0	
0-10	101
10-20	288
20-30	433
30-40	517
40-50	532
50-60	477
60-70	366
70-80	216
80-90	64
90	

LUMINANCE DATA (cd/m²)

Vertical Angle	Horizontal Angles		
	0	45	90
45	8204	6848	6430
55	7761	6064	5583
65	7200	5091	4531
75	6394	3739	3059
85	4580	1646	1097

i All IES files are available for download at: www.axislighting.com