

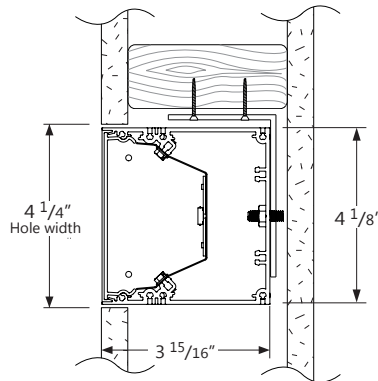

Project _____

Type _____

Notes _____



PERFORMANCE PER LINEAR FOOT AT 3500K

NOMINAL LUMEN OUTPUT	INPUT WATTS*	EFFICACY	SHIELDING
1200 lm/ft	9.7 W/ft	124 lm/W	FL
1200 lm/ft	10.4 W/ft	116 lm/W	UB

Please consult factory for custom lumen output and wattage.



* Check the latest update on the DLC website for complete information. Not all versions may be DLC qualified.
See page 2 for DLC Approved options



Ordering Guide

BBRVLED		NOM. LUMENS/FT		CRI		COLOR TEMP. (choose one)		SHIELDING	LENGTH
PRODUCT ID	Beam 4	400	400 lm/ft - Minimum	80	80 CRI	27	2700 K	FL	2 2'
	Recessed Vertical LED	1200	1200 lm/ft - Maximum	90	90 CRI*	30	3000 K	UB	3 3'
						35	3500 K		4 4'
						40	4000 K		5 5'
						B30	3000 K - BIOS*		6 6'
						B35	3500 K - BIOS*		8 8'
						B40	4000 K - BIOS*		12 12'
									S(L) system run
Outputs between listed min and max are available. Consult factory for outputs outside of the listed range. Consult factory for max output with BIOS				* Not available with BIOS.		Consult Axitune technical sheet for more information on color technology. *Consult BIOS guide for more information on BIOS technology		*Lens options use spotless lens. See page 2 for more details. ** Default lens for Tunable white and BIOS. Consult factory for other lens.	

FINISH		VOLTAGE		DRIVER		CIRCUITS		MOUNTING		BATTERY (OPTIONAL)	
W white C custom	120	120 V	DP	dimming (0-10V) 1%	1	1 circuit	DF	drywall flange	B(#)	battery pack 4' sections	
	277	277 V	LT(#)	Lutron*	2	2 circuits	DS	drywall spackle flange			
	347	347 V	BI	bi-level dimming	+E(#)	emergency circuit*	D	drywall flangeless			
	UNV	universal	O(#)	other**	+NL(#)	night light circuit*					
	DC	low voltage*	DPB(STC)	dimming (0-10V) 1% with BIOS*	+GTD(#)	generator transfer device*					
			DPB(DYN)	Bio-dimming™ 100%-81% with BIOS*							
			TW(#)	tunable white drivers*							
		POE(#)	POE drivers*								
		* Only available with POE drivers. **Please consult factory; see page 2				* Specify quantity				Not available with 347V. Please consult factory	

OTHER (OPTIONAL)		CUSTOM (OPTIONAL)	
EF end feed		C custom	
FW flex whip (6' std)*			
*Other lengths available; please consult factory.		Please specify	

● SPECIFICATIONS

CONSTRUCTION

Housing	Extruded aluminum (0.075" nominal) Up to 70% recycled content
Interior Brackets	Die formed sheet steel (18 gauge)
Reflectors	White powder coated sheet steel (22 gauge)
Blank	Extruded aluminum (0.075" nominal)
Lens	Spotless frosted acrylic lens

● ELECTRICAL

Lutron driver	LDE1 - Hi-lume 1% EcoSystem with Soft-on, Fade-to-Black
Other drivers**	DALI - Digital Addressable Lighting Interface DMX - Digital Multiplex Xitanium SR - For wireless sensor
BIOS DPB drivers*	STC - BIOS control 0-10V with static spectrum and BIOS SkyBlue enabled from 100% to 1%. DYN - BIOS control 0-10V with dynamic spectrum and BIOS SkyBlue® with Bio-Dimming™, which changes spectral qualities by removing the SkyBlue component when dimming from 100% to 81%, while light output remains relatively constant; bio-dimming reduces CCT to 2700K. Dimming from 80% to 1% will then reduce light output.
Tunable White TW drivers*	DALIT6 - DALI Type 6 (Two DALI Addresses) DALIT8 - DALI Type 8 (One DALI Address)
Power over Ethernet POE drivers*	MOLEX IGOR SMARTENGINE O - Other (Consult factory)
Emergency	Integral emergency battery pack or emergency circuit optional.
Input Voltage	120V, 277V, 347V, UNV, DC.
Flex Whip	Shipped in a separate box for contractors to install

*Choose driver from available options.

❗ Incorporating these components may have limitations or affect the length of the luminaire. Please contact factory for more details.

● FINISHES

Powder coated and custom finishes are also available.

● SYSTEM (S#)

BEAM4 LED linear systems, with the use of a strong profile, allow for a nearly hair thin connection system of continuous runs. Lengths of 4', 8', 12' as well as custom lengths are available. Runs of BEAM4 LED that are greater than 12ft in length are designated as systems (S#). This means that the run is comprised of a combination of 4', 8' and/or 12' sections to be assembled on site using our joining system. For more information on systems and joining, please refer to the BEAM4 LED installation sheets available for download at www.axislighting.com.

● DLC Approved Options



LUMEN OUTPUT	CRI	COLOR TEMP.	SHIELDING	LENGTH	VOLTAGE	DRIVER
400 lm/ft	80	3000 K	FL	4'	universal	DP
600 lm/ft		3500 K		8'		
800 lm/ft		4000 K		12'		
1000 lm/ft						

● OPTICS

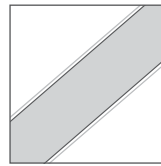

FL flush spotless lens
UB Ultra Blend Lens

SPOTLESS LENS

Frosted acrylic snap-in lens with micro lens

ULTRA BLEND LENS

Frosted acrylic snap-in micro lens suitable for Tunable White and BIOS applications.

● LED SYSTEM

CRI

Minimum 80 or 90 color rendering index.

CRI BIOS

Minimum 80 color rendering index with R9>75 for all CCTs.

CCT Single Color

Choice of 2700K, 3000K, 3500K and 4000K color temperature with a great color consistency (within 3-step MacAdam ellipse). Both within fixture and fixture to fixture.

CCT BIOS

BIOS Static (STC) Choice of 3000K, 3500K and 4000K.
BIOS SkyBlue® Dynamic (DYN) Choice of 3000K, 3500K, and 4000K with Bio-Dimming™
BIOS Tunable White (BTW) Choice of 4000-2700K and 3500-2700K; does not use a bio-dimmer, it uses TW drivers, which allow independent control of CCT and intensity; e.g., BTW4027 provides combined SkyBlue + white light at 4000K, SkyBlue is removed at 2700K. Light output can be adjusted for each CCT.

[Consult BIOS guide for more information on BIOS technology.](#)

CCT Axitune Systems

[Consult Axitune technical sheet for more information on color technology.](#)

LED life

Minimum 50,000h with 85% of lumen maintenance in 25°C ambient temperature, in compliance with IES LM-80 testing measurements.

Thermal Management

Aluminum housing acting as the heat sink to maximize life.

Environment

Dry and damp rated for indoor use only in operating ambient temperatures of 0-40°C (32-104°F).

● WEIGHT

Recessed Vertical LED 4ft	12.3 lbs / 5.0 kg
Recessed Vertical LED 8ft	24.6 lbs / 10.1 kg
Recessed Vertical LED 12ft	36.9 lbs / 15.1 kg

● WARRANTY

Limited 5-year warranty is available. Warranty is valid provided luminaires are installed and used according to specifications. For full terms and conditions, please consult warranty section at axislighting.com.

● VERTICAL RECESSED MOUNTING OPTIONS

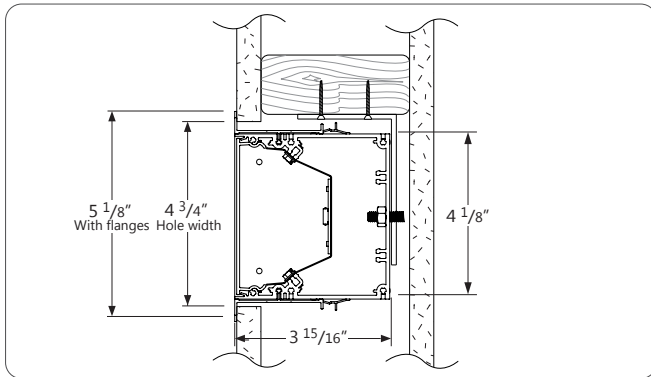

DF DRYWALL FLANGED

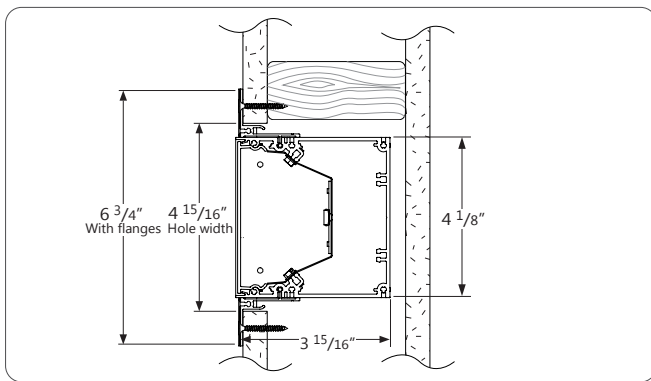

DS DRYWALL SPACKLE FLANGE

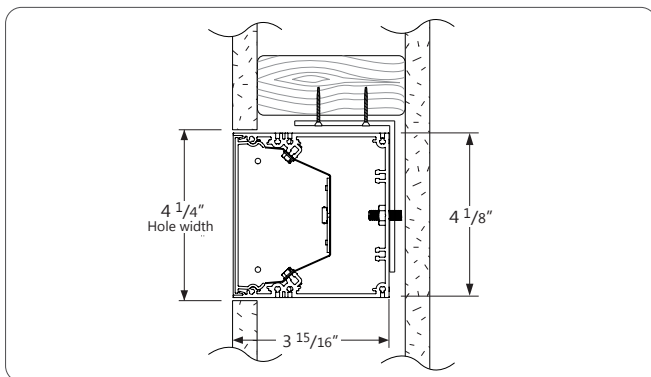

D DRYWALL FLANGELESS

● OTHER MOUNTING OPTIONS

BEAM4 LED is also available with recessed, pendant, surface and wall mounted options.

i Specification sheets and installation sheets for all mountings for BEAM4 LED luminaires are available for download at www.axislighting.com

● APPROVALS

Certified to UL and CSA standards 
Meets NYC requirements
Suitable for damp locations
IC Rated (Insulated ceiling)

● JOINERS

In order to allow very long runs of BEAM4 LED luminaires, Axis has developed a number of different joining systems. Special care has been taken to maximize the performance of the joiner for each BEAM4 LED option.

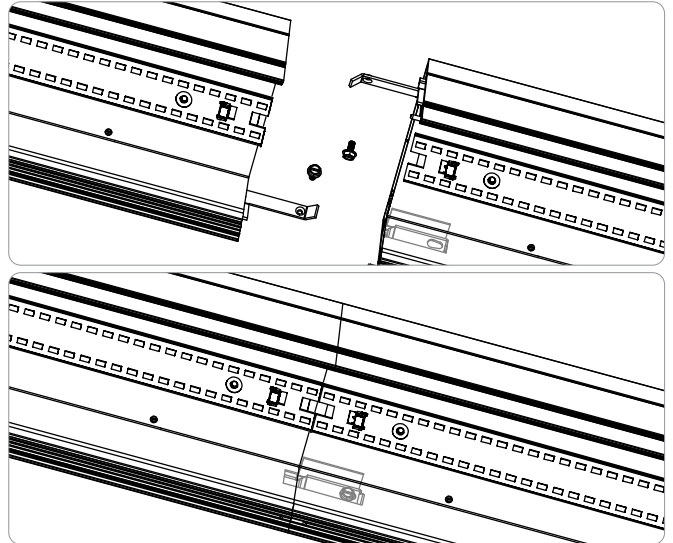

JOINER SYSTEM

NOTE: Hang each system segment individually. Do not assemble system prior to hanging.

● CORNERS

Unlit Corners - BEAM4 LED features a multitude of layout patterns with the use of a number of corners, 90° corner, T or X junctions.

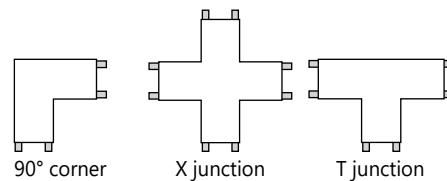
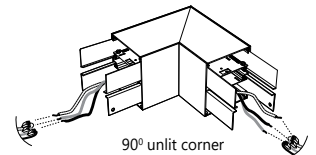

Lit Corners - Axis also offers lit 90° corners including ceiling to ceiling, wall to ceiling and ceiling to wall.

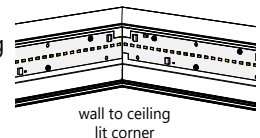

i For custom corner angles, please consult factory. Specifications sheets for all corners are available at: www.axislighting.com

● PHOTOMETRIC DATA

FL Flush lens

1200 lm/ft



PHOTOMETRIC CURVE

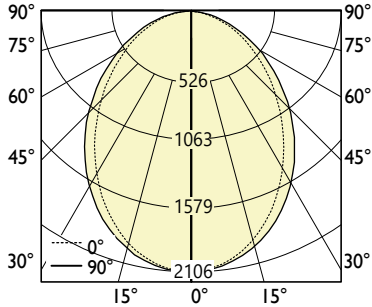

Lumen/ft: 1200 lm/ft
Total Lumens: 4800 lm (for 4ft)
Input Watts: 38.7 W
Efficacy: 124 lm/W

IES FILE: BBRVLED-1200-80-35-SO-4.IES

TESTED ACCORDING TO IES LM-79-2008

CANDELA DISTRIBUTION

Vertical Angle	Horizontal Angles				
	0	22.5	45	67.5	90
0	2106	2106	2106	2106	2106
5	2096	2093	2091	2089	2088
15	1989	1983	1969	1953	1945
25	1781	1767	1737	1702	1686
35	1495	1478	1434	1386	1364
45	1171	1155	1108	1056	1033
55	845	833	793	748	730
65	542	536	509	478	465
75	283	283	272	258	252
85	84	85	84	80	79
90	6	7	7	7	7

ZONAL LUMENS

Zone	Lumens
0	
0-10	198
10-20	551
20-30	791
30-40	884
40-50	838
50-60	692
60-70	488
70-80	275
80-90	84
90	

LUMINANCE DATA (cd/m²)

Vertical Angle	Horizontal Angles		
	0	45	90
45	13867	13117	12235
55	12338	11567	10649
65	10740	10085	9212
75	9146	8792	8142
85	8065	8042	7592

UB Ultra blend lens

1200 lm/ft



PHOTOMETRIC CURVE

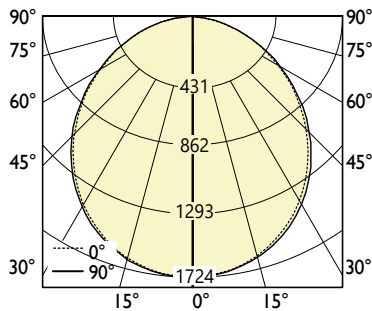

Lumen/ft: 1200 lm/ft
Total Lumens: 4800 lm (for 4ft)
Input Watts: 41.5 W
Efficacy: 116 lm/W

IES FILE: BBRVLED-1200-80-35-UB-4.IES

TESTED ACCORDING TO IES LM-79-2008

CANDELA DISTRIBUTION

Vertical Angle	Horizontal Angles				
	0	22.5	45	67.5	90
0	1724	1724	1724	1724	1724
5	1718	1719	1721	1721	1721
15	1651	1655	1659	1659	1659
25	1522	1528	1532	1532	1530
35	1338	1346	1350	1349	1347
45	1116	1125	1128	1125	1123
55	864	874	877	874	872
65	594	604	609	608	606
75	327	338	345	346	346
85	102	109	115	116	116
90	9	13	16	15	15

ZONAL LUMENS

Zone	Lumens
0	
0-10	163
10-20	464
20-30	695
30-40	827
40-50	846
50-60	754
60-70	569
70-80	335
80-90	105
90	

LUMINANCE DATA (cd/m²)

Vertical Angle	Horizontal Angles		
	0	45	90
45	13211	13360	13290
55	12607	12803	12720
65	11766	12064	12006
75	10583	11168	11183
85	9829	11021	11133

i All IES files are available for download at: www.axislighting.com