

# Beam 3

# Wall mount - Direct

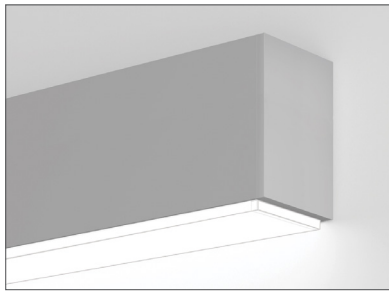

Glo Lens - down

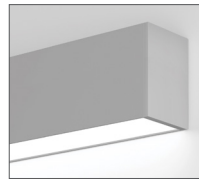

Flush spotless lens  
down

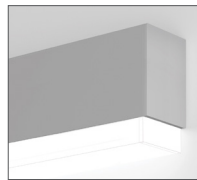

1.25" StepLens -  
down

Project \_\_\_\_\_

Type \_\_\_\_\_

Notes \_\_\_\_\_

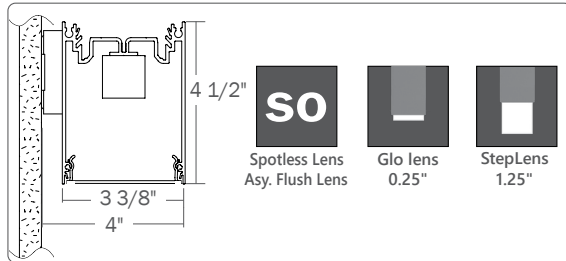

## Ordering Guide

TB3WDLED											
PRODUCT ID		NOM. LUM/FT DOWN		CRI		COLOR TEMP. (choose one)				SHIELDING	
TB3WDLED	BEAM3 - Wall Direct LED	400	400 lm/ft - Minimum	80	80 CRI*	27	2700 K	TW2750	2700-5000 K - Tunable White	SO	spotless lens
		1000	1000 lm/ft - Maximum	90	90 CRI**	30	3000 K	TW2765	2700-6500 K - Tunable White	ASO	asymmetric, flush only
		700	700 lm/ft - for TC1680 with UB lens			35	3500 K	BTW3527	3500-2700 K - Tunable BIOS	0.25G	0.25" Glo lens
						40	4000 K	BTW4027	4000-2700 K - Tunable BIOS	1.25M	1.25" StepLens, lum. end cap
						B30	3000 K - BIOS*	DW3020	3000-2000 K - Dim to Warm	UB	Ultra blend lens (Flush only)*
						B35	3500 K - BIOS*	TC1680	1650-8000 K - Color Tuning	NW	narrow, flush only
						B40	4000 K - BIOS*			GZ	graze, flush only
		Outputs between listed min and max are available. Consult factory for outputs outside of the listed range. Consult factory for max output with BIOS *For shieldings other than UB there is a fixed lumen output. Please consult factory for more information.		*Not available with color tuning ** Not available with BIOS.		<a href="#">Consult Axitune technical sheet for more information of color technology.</a> <a href="#">*Consult BIOS guide for more information on BIOS technology.</a>				Choose only one of the options above; SurroundLite not available with direct. * Default lens for Color Tuning, Tunable white and BIOS. Consult factory for other lens.	

LENGTH (FT)		MR (OPTIONAL)		FINISH		VOLTAGE		DRIVER	
2	2'	M16(#)	MR halogen lamp - Line voltage (by other)*	AP	aluminum paint	120	120 V	DP	dimming (0-10V) 1%
3	3'	M16LED(#)	MR16 LED lamp - Line voltage (by other)*	W	white	277	277 V	LT(#)	Lutron *
4	4'	M16LEDB(#)	MR16 LED lamp - Dimmable (provided)**	BLK	black	347	347 V	BI	bi-level dimming
5	5'			C	custom	UNV	universal	O(#)	other **
8	8'					DC	low voltage*	DPB(STC)	dimming (0-10V) 1% with BIOS*
12	12'							DPB(DYN)	Bio-dimming™ 100%-81% with BIOS*
S(L)	System Run							TW(#)	tunable white drivers*
								CT(#)	color tuning drivers*
								POE(#)	POE drivers*
		*Specify quantity; Line wattage only; Seperate circuits included. **Consult factory; See page 3 for more details; MR16 constant current for 0-10V & DALI only. Available in 3000K or 4000K. Available in luminaires with Axitune and BIOS but downlight will not be tunable white, color tuning, or BIOS LEDs				* Only available with POE drivers.		* See page 2 to specify system ** Please consult factory; see page 2 Consult factory for other control options.	

CIRCUITS		BATTERY (OPTIONAL)		OTHER (OPTIONAL)		IC CONTROLS (OPT.)		CUSTOM (OPT.)	
1	1 circuit	B(#)	battery pack (integral)	F	fuse *	DS(#)	daylight sensor	C	custom
2	2 circuits					OS(#)	occupancy sensor		
+E(#)	emergency circuit *					DOS(#)	daylight & occupancy sensor		
+NL(#)	night light circuit *					EN(#)	Enlighted integral *		
+GTD(#)	generator transfer device *					ENR(#)	Enlighted remote *		
+M	MR					WC(#)	wireless control dimming		
* Specify quantity		Minimum 5ft; Not available with 347V Please consult factory Not available with color tuning		* Requires 120V or 277V		* Please consult factory Specify quantity. Requires 8" blank. See integrated controls guide for more details. Not available with Color Tuning. Consult factory for Tunable White. Not available with DPB (DYN) driver for BIOS with Dynamic Spectrum.		Please specify	

## CONSTRUCTION

<b>Housing</b>	Extruded aluminum (0.075" nominal) Up to 70% recycled content
<b>End Cap</b>	Cast aluminum
<b>Interior Brackets</b>	Die formed sheet steel (20 gauge)
<b>Reflectors</b>	White powder coated sheet steel (22 gauge)
<b>Lenses</b>	Extruded acrylic (0.070" nominal)
<b>Hanger</b>	Die cast aluminum
<b>Suspension</b>	Sliding aircraft cable along product length

## ELECTRICAL

<b>Lutron driver*</b>	LDE1 - Hi-lume 1% EcoSystem with Soft-on, Fade-to-Black LTEA - Hi-lume 1% 2-wire (120V forward phase only) *Consult factory
<b>Other drivers</b>	DALI - Digital Addressable Lighting Interface DMX - Digital Multiplex LV - line voltage - Advance Mark 10 Xitanium SR - For wireless sensor
<b>BIOS DPB drivers*</b>	STC - BIOS control 0-10V with static spectrum and BIOS SkyBlue enabled from 100% to 1%. DYN - BIOS control 0-10V with dynamic spectrum and BIOS SkyBlue® with Bio-Dimming™, which changes spectral qualities by removing the SkyBlue component when dimming from 100% to 81%, while light output remains relatively constant; bio-dimming reduces CCT to 2700K. Dimming from 80% to 1% will then reduce light output.
<b>Tunable White TW drivers*</b>	DALIDT6 - DALI Type 6 (Two DALI Addresses) DALIDT8 - DALI Type 8 (One DALI Address) LTTW - Lutron T-Series Tunable White
<b>Color Tuning CT drivers*</b>	DMX - Standard (required for full color control) LTA5 - Lutron Araya 5 Ecosystem DALIDT8 - DALI Type 8 (Single DALI Address) DLM - Wattstopper DLM
<b>Power over Ethernet POE drivers*</b>	MOLEX IGOR UL2108 certified for integral or remote driver
<b>Emergency</b>	O - Other (Consult factory) Integral emergency battery pack or emergency circuit optional.
<b>Input Voltage</b>	120V, 277V, 347V, UNV, DC.

\*Choose driver from available options.

**i** Incorporating these components may have limitations or affect the length of the luminaire. Please contact factory for more details.

## WARRANTY

Axis Lighting will warrant defective LEDs, boards, and drivers for 5 years from date of purchase. Warranty is valid if luminaire is installed and used according to specifications. If defective, Axis will send replacement boards or drivers at no cost along with detailed replacement instructions and instructions on how to return defective components to Axis.

## OPTICS

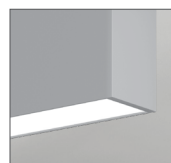

**SO** Spotless lens  
**UB** Ultra Blend Lens

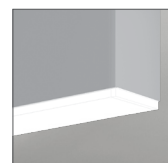

**0.25G** Glo lens

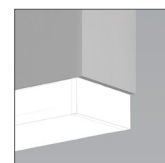

**1.5M** 1.5" StepLens

### ULTRA BLEND LENS

Frosted acrylic snap-in micro lens suitable for Tunable White and BIOS applications.

### SPOTLESS LENS

Frosted acrylic snap-in micro lens. Used for SO, ASO, NW, and GZ shielding options.

### GLO LENS

0.25" frosted acrylic drop lens. Patented design.

### STEPLENS

1.25" StepLens, illuminated end cap.

## LED SYSTEM

<b>CRI</b>	Minimum 80 or 90 color rendering index.
<b>CRI BIOS</b>	Minimum 80 color rendering index with R9>75 for all CCTs.
<b>CRI Color Tuning</b>	Minimum 90 color rendering index.
<b>CCT Single Color</b>	Choice of 2700K, 3000K, 3500K and 4000K color temperature with a great color consistency (within 3-step MacAdam ellipse). Both within fixture and fixture to fixture.
<b>CCT BIOS</b>	BIOS Static (STC) Choice of 3000K, 3500K and 4000K. BIOS SkyBlue® Dynamic (DYN) Choice of 3000K, 3500K, and 4000K with Bio-Dimming™ BIOS Tunable White (BTW) Choice of 4000-2700K and 3500-2700K; does not use a bio-dimmer, it uses TW drivers, which allow independent control of CCT and intensity; e.g., BTW4027 provides combined SkyBlue + white light at 4000K, SkyBlue is removed at 2700K. Light output can be adjusted for each CCT. <a href="#">Consult BIOS guide for more information on BIOS technology.</a>
<b>CCT Axitune Systems</b>	<a href="#">Consult Axitune technical sheet for more information on color technology.</a>
<b>LED life</b>	Minimum 50,000h with 85% of lumen maintenance in 25°C ambient temperature, in compliance with IES LM-80 testing measurements.
<b>Thermal Management</b>	Aluminum housing acting as the heat sink to maximize life.
<b>Environment</b>	Dry and damp rated in operating ambient temperatures of 0-40°C (32-104°F).

## ● MOUNTING OPTIONS

### HORIZONTAL MOUNTING DETAILS

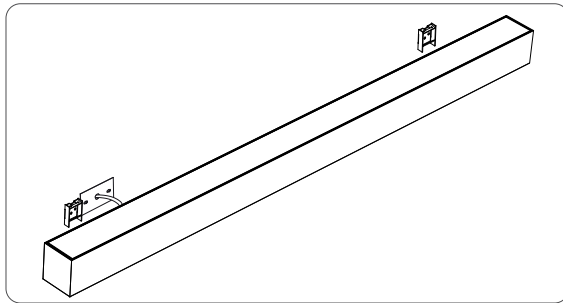

**MOUNTING BRACKETS**

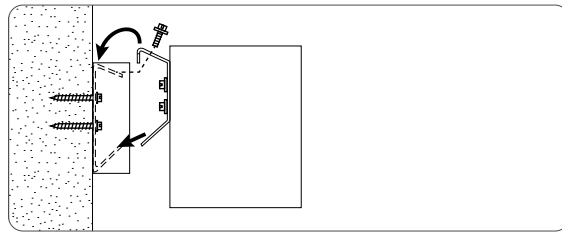

**SIDE VIEW**

## ● OTHER MOUNTING OPTIONS

BEAM3 SurroundLite is also available with pendant mounted option.

**i** Specification sheets and installation sheets for all mountings for BEAM3 SurroundLite luminaires are available for download at [www.axislighting.com](http://www.axislighting.com)

## ● WEIGHT

<b>Wall Direct LED 4 ft</b>	12.3 lbs / 5.0 kg
<b>Wall Direct LED 8 ft</b>	24.6 lbs / 10.1 kg
<b>Wall Direct LED 12 ft</b>	36.9 lbs / 15.1 kg

## ● FINISH

Aluminium paint, powder coated and custom finishes are also available.

## ● SYSTEM (S#)

BEAM 3 linear systems, with the use of a strong profile, allow for a nearly hair thin connection system of continuous runs. Lengths of 4', 8', 12' as well as custom lengths are available. Runs of BEAM 3 that are greater than 12' in length are designated as systems (S#). This means that the run is comprised of a combination of 4', 8' and/or 12' sections to be assembled on site using our joining system. System runs with SurroundLite available in 1' increments only. For more information on systems and joining, please refer to the BEAM installation sheets available for download at [www.axislighting.com](http://www.axislighting.com).

## ● MR16 LED LAMPS

<b>Blank</b>	Extruded aluminum (0.075" nominal)
<b>MR16 Halogens</b>	Adjustable halogen lamp 35W / 50W (by others)
<b>MR16 LED</b>	Adjustable LED lamp (provided)
<b>MR16 LEDB</b>	Constant current LED lamp (provided)- Dimmable by control system for 0-10V & DALI only
<b>Quantity</b>	For every 4' section, there may be up to a maximum of 4 x MR16 LED lamps.

### Spacing

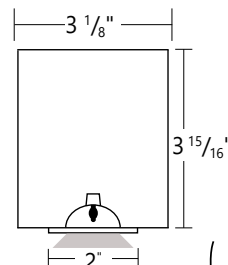

**Between sections**

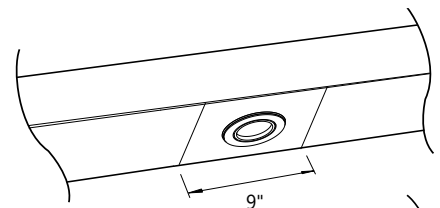

**At luminaire ends**

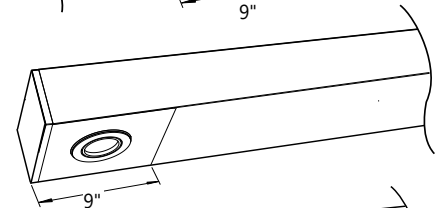

**Several in a long blank section**

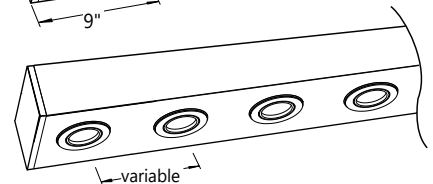

<b>Base Type</b>	GU 5.3
<b>Beam Angle</b>	40 nominal degrees
<b>Input Watts</b>	6W
<b>Nominal Lumens</b>	300 lumens
<b>Efficacy</b>	50 lumens per watt
<b>Color Rendering Index (CRI)</b>	85
<b>Center Beam Candle Power (CBCP)</b>	584 candelas
<b>Life</b>	25,000 hours at L <sub>70</sub>
<b>Correlated color temperature (CCT)</b>	3000K, 4000K
<b>Adjustability</b>	15° tilt

**i** More options are available upon request. Please consult factory.

## ● APPROVALS

Certified to UL and CSA standards  
Meets NYC requirements  
Meets ADA requirements.  
Suitable for damp locations.



## ● JOINERS

BEAM3 SurroundLite luminaires feature the joining mechanism shown below. This mechanism joins and aligns multiple luminaires to create long continuous runs of light.

**NOTE:** Mount each system segment individually.

**Do not assemble system prior to mounting.**

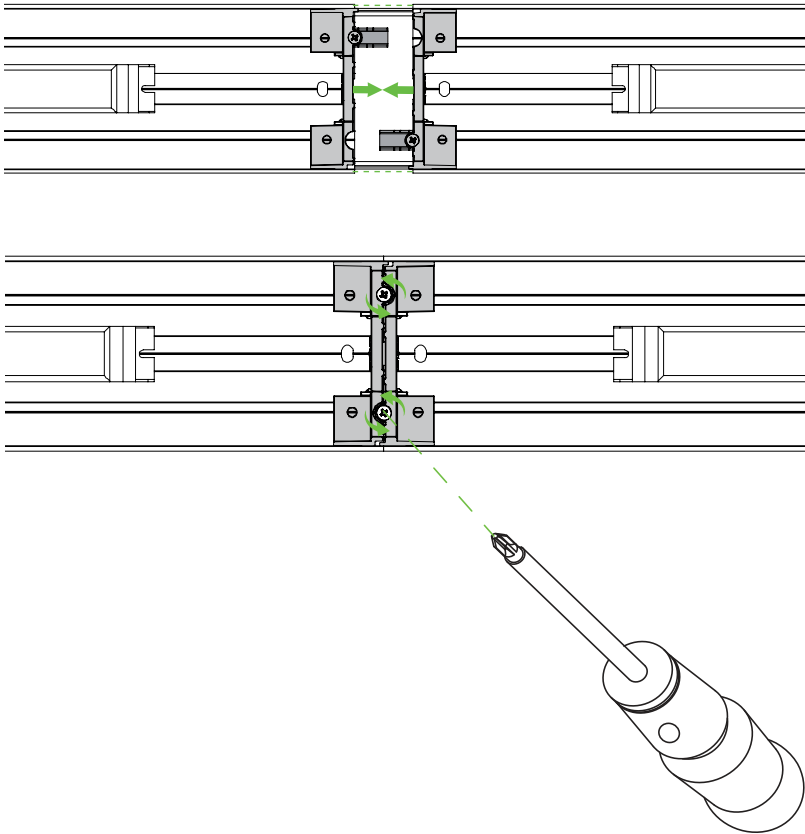

## ● SECTION VIEWS

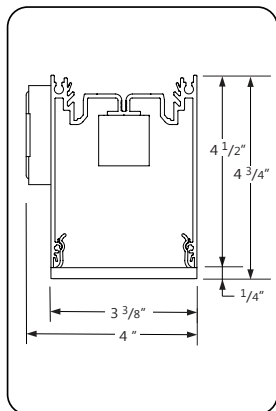

**0.25G** 0.25" Glo lens - Direct

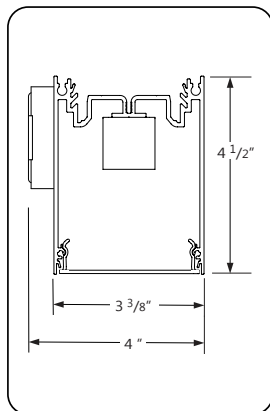

**SO** Spotless lens - Direct

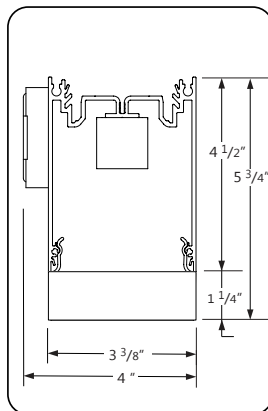

**1.25M** 1.25" StepLens - Direct

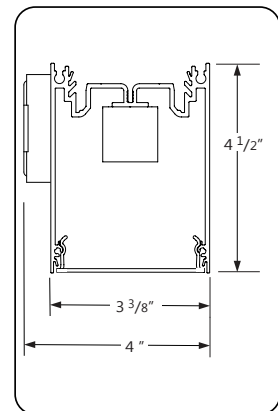

**ASO** Asy. flush lens - Direct

## ● PHOTOMETRIC DATA

0.25G 0.25" Glo lens

Uplight  
0 lm/ft  
Downlight  
500 lm/ft



### PHOTOMETRIC CURVE

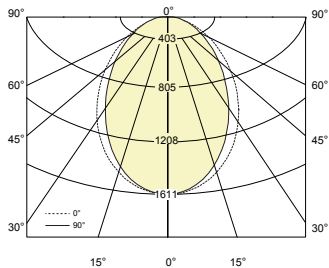

Lumen/ft up: 0 lm/ft  
Lumen/ft down: 585 lm/ft  
Total Lumens: 2338 lm (for 4ft)  
Input Watts: 19.6 W  
Efficacy: 119 lm/W  
IES FILE: TB3DLED-0-500-80-35-0.25G-4.IES

TESTED ACCORDING TO IES LM-79-2008

### CANDELA DISTRIBUTION

Vertical Angle	Horizontal Angles				
	0	22.5	45	67.5	90
0	1045	1045	1045	1045	1045
5	1038	1038	1036	1035	1035
15	982	978	967	957	952
25	875	865	841	817	807
35	729	715	681	648	634
45	564	550	515	482	468
55	400	391	364	338	328
65	254	250	235	221	215
75	130	132	132	129	127
85	38	45	54	59	61
90	4	14	25	33	36

### ZONAL LUMENS

Zone	Lumens
0	
0-10	98
10-20	272
20-30	387
30-40	426
40-50	398
50-60	326
60-70	234
70-80	139
80-90	58
90	

### LUMINANCE DATA (cd/m²)

Vertical Angle	Horizontal Angles		
	0	45	90
45	7602	6951	6317
55	6649	6050	5446
65	5721	5304	4846
75	4787	4849	4697
85	4130	5880	6651

## ● PHOTOMETRIC DATA - ASYMMETRIC DIRECT

ASO Asy. Flush Lens - Down

Downlight  
1000 lm/ft

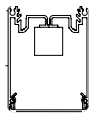

### PHOTOMETRIC CURVE

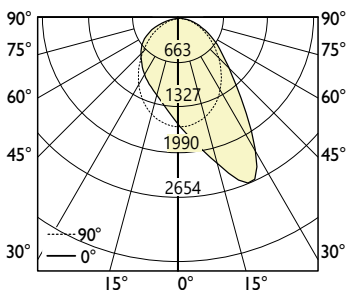

Lumen/ft down: 1065 lm/ft  
Total Lumens: 4259 lm/4ft)  
Input Watts: 37.73 W  
Efficacy: 113 lm/W  
IES FILE: TB3DLED-1000-80-35-ASO-4.IES

TESTED ACCORDING TO IES LM-79-2008

### CANDELA DISTRIBUTION

Vertical Angle	Horizontal Angles				
	0	22.5	45	67.5	90
0	1699	1699	1699	1699	1699
5	1683	1765	1844	1897	1936
15	1583	1847	2127	2340	2439
25	1391	1839	2351	2578	2553
35	1139	1705	2108	1790	1597
45	868	1384	1406	1068	961
55	609	943	850	663	610
65	381	547	480	389	356
75	186	246	215	177	159
85	37	47	41	34	28
90	2	1	1	1	2

### ZONAL LUMENS

Zone	Lumens
0	
0-10	162
10-20	481
20-30	751
30-40	829
40-50	748
50-60	599
60-70	416
70-80	219
80-90	55
90	0

### LUMINANCE DATA (cd/m²)

Vertical Angle	Horizontal Angles		
	0	45	90
45	12569	20360	13917
55	10877	15171	10892
65	9224	11630	8628
75	7348	8494	6301
85	4347	4825	3330

**i** All IES files are available for download at: [www.axislighting.com](http://www.axislighting.com)

## ● PHOTOMETRIC DATA - GRAZE DIRECT

1000 lm/ft

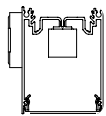

### PHOTOMETRIC CURVE

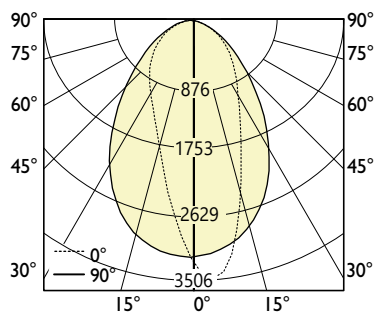

**Luminaire Lumens: 4246 lm**  
**Input Watts: 37.28 W**  
**Efficacy: 114 lm/W**

IES FILE: TB3LED-1000-80-35-GZ-4.IES  
 TESTED ACCORDING TO IES LM-79-2008

### CANDELA DISTRIBUTION

Vertical Angle	Horizontal Angles				
	0	22.5	45	67.5	90
0	3204	3204	3204	3204	3204
5	3474	3490	3497	3398	3162
15	1976	2108	2567	3167	2928
25	1250	1305	1585	2353	2449
35	969	985	1099	1612	1798
45	764	760	802	1077	1171
55	576	562	564	690	712
65	392	371	356	405	403
75	203	187	173	186	183
85	42	39	35	33	32
90	1	1	2	2	2

### ZONAL LUMENS

Zone	Lumens
0	
0-10	279
10-20	626
20-30	744
30-40	750
40-50	673
50-60	542
60-70	380
70-80	202
80-90	49
90	

### LUMINANCE DATA (cd/m²)

Vertical Angle	Horizontal Angles		
	0	45	90
45	11087	11649	17008
55	10313	10091	12751
65	9521	8639	9796
75	8067	6847	7251
85	4954	4105	3731

## ● PHOTOMETRIC DATA - NARROW DIRECT

1000 lm/ft

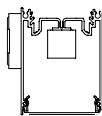

### PHOTOMETRIC CURVE

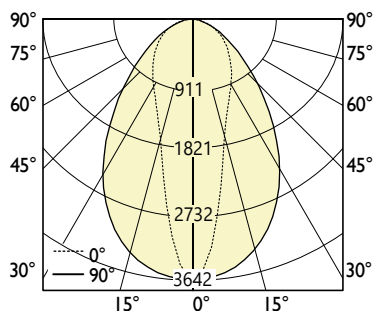

**Luminaire Lumens: 4402 lm**  
**Input Watts: 41 W**  
**Efficacy: 108 lm/W**

IES FILE: TB3DLED-1000-80-35-NW-4.IES  
 TESTED ACCORDING TO IES LM-79-2008

### CANDELA DISTRIBUTION

Vertical Angle	Horizontal Angles				
	0	22.5	45	67.5	90
0	3642	3642	3642	3642	3642
5	3612	3545	3390	3243	3201
15	3358	2853	2192	1858	1775
25	2824	2040	1455	1281	1246
35	2078	1436	1079	994	979
45	1336	1000	806	760	757
55	790	665	566	561	573
65	434	402	361	378	398
75	196	191	181	201	217
85	38	39	42	50	55
90	3	3	3	4	4

### ZONAL LUMENS

Zone	Lumens
0	
0-10	303
10-20	657
20-30	779
30-40	782
40-50	693
50-60	551
60-70	382
70-80	203
80-90	50
90	

### LUMINANCE DATA (cd/m²)

Vertical Angle	Horizontal Angles		
	0	45	90
45	18443	11123	10457
55	13450	9640	9751
65	10035	8346	9198
75	7389	6843	8203
85	4217	4725	6171

**i** All IES files are available for download at: [www.axislighting.com](http://www.axislighting.com)