

# Wet Beam DI LED | Pendant mount

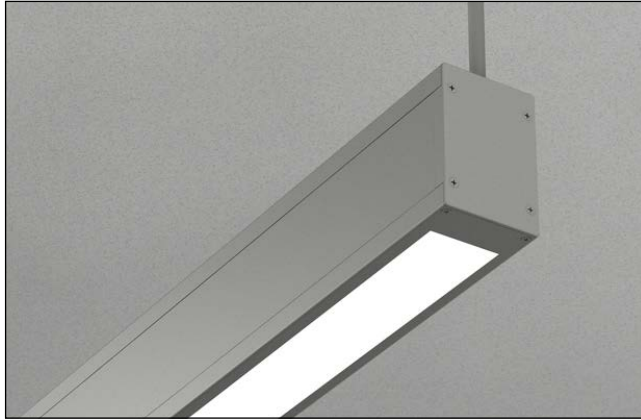

Project \_\_\_\_\_

Type \_\_\_\_\_

Notes \_\_\_\_\_

## PERFORMANCE PER LINEAR FOOT AT 3500K

NOMINAL LUMEN OUTPUT		INPUT WATTS*	EFFICACY
UPLIGHT	DOWNLIGHT		
1000 lm/ft	1000 lm/ft	22.5 W/ft	89 lm/W
	1000 lm/ft	13.4 W/ft	81 lm/W
1000 lm/ft		10.2 W/ft	98 lm/W

Please consult factory for custom lumen output and wattage.

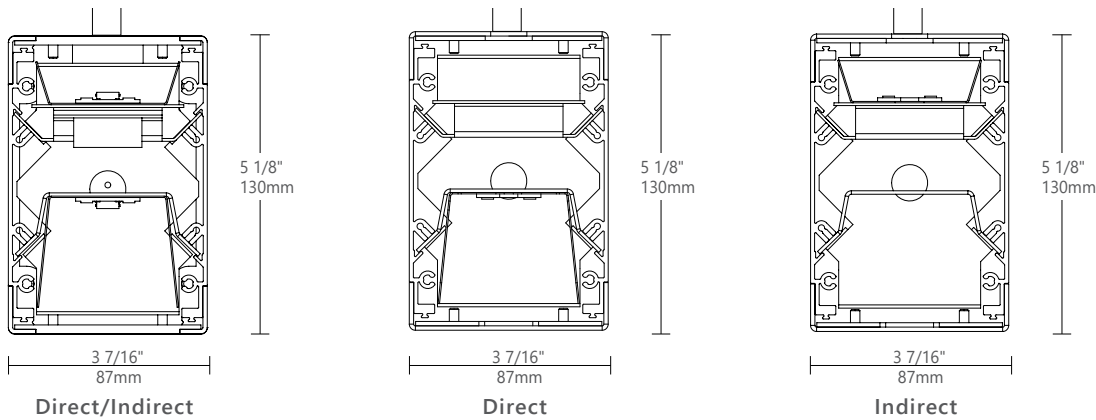

## Ordering Guide

PRODUCT ID	NOM.LUMENS/FT UP	NOM.LUMENS/FT DOWN	CRI	COLOR TEMP.	SO SHIELDING UP
<b>WBDILED</b> Pendant Direct/Indirect LED	<b>400</b> 400 lm/ft up - Minimum	<b>400</b> 400 lm/ft up - Minimum	<b>80</b> 80 CRI	<b>27</b> 2700 K	<b>SO</b> spotless lens
<b>WBDLED</b> Pendant Direct LED	<b>1000</b> 1000 lm/ft down - Maximum	<b>1000</b> 1000 lm/ft down - Maximum	<b>90</b> 90 CRI	<b>30</b> 3000 K	
<b>WBILED</b> Pendant Indirect LED				<b>35</b> 3500 K <b>40</b> 4000 K	
Outputs between listed min and max are available. Consult factory for outputs outside of the listed range.		Outputs between listed min and max are available. Consult factory for outputs outside of the listed range.			Extruded Polycarbonate

SO SHIELDING DOWN	LENGTH (FT)	FINISH	VOLTAGE	DRIVER	CIRCUITS
<b>SO</b> spotless lens	<b>2</b> 2' <b>3</b> 3' <b>4</b> 4' <b>6</b> 6' <b>8</b> 8' <b>12</b> 12' <b>S(L)</b> system run	<b>AP</b> aluminum paint <b>W</b> white <b>BLK</b> black <b>C</b> custom	<b>120</b> 120 V <b>277</b> 277 V <b>347</b> 347 V <b>UNV</b> universal <b>DC</b> low voltage*	<b>DP</b> dimming (0-10V) 1% <b>LT(#)</b> Lutron * <b>BI</b> bi-level dimming <b>O(#)</b> other * <b>POE(#)</b> POE drivers*	<b>1</b> 1 circuit <b>2</b> 2 circuits <b>2A/B</b> 2 alternating <b>+E(#)</b> emergency section* <b>+NL(#)</b> night light section* <b>+GTD(#)</b> generator transfer device*
Extruded Polycarbonate	Minimum Length is 2ft Only available in full foot increments		* Only available with POE drivers.	* Operating up to -20°C; Specify system ** Please consult factory; see page 2	* Specify quantity

MOUNTING/SUSPENSION	BATTERY (OPTIONAL)	OTHER (OPTIONAL)	IC CONTROLS (OPTIONAL)	CUSTOM (OPTIONAL)
<b>SA(L)</b> drywall+stem length <48" (18" std.) <b>SASL(L)</b> drywall stem sloped ceiling	<b>B(#)</b> battery pack	<b>+TF</b> Top feed* <b>+N</b> natatorium finish	<b>OS(#)</b> occupancy sensor <b>EN(#)</b> Enlighted integral <b>WC(#)</b> wireless control dimming	<b>C</b> custom
<a href="#">See Mounting kit guide for full specification code.</a>	Requires 120V or 277V Minimum 5ft; Not available with 347V Please consult factory	*See page 2 for more details. Consult factory.	<a href="#">See integrated controls guide for more details.</a> Please consult factory	Please specify

# Wet Beam DI LED | Pendant mount

## ● MOUNTING OPTIONS

### SAS STEM MOUNT IN SOLID CEILING

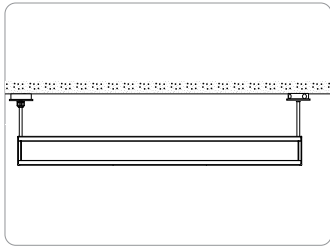

#### POWER FEED THROUGH STEM

Please consult factory for number of wire limit

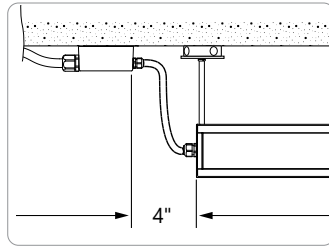

#### EF END FEED - STANDARD

## ● POWER FEED

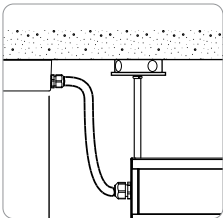

#### EF END FEED

**STANDARD**

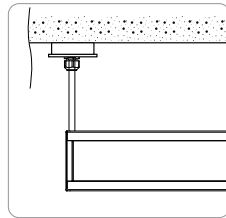

#### TF TOP FEED

**OPTIONAL**

## ● MOUNTING POINTS

4' - 49"  
8' - 99"

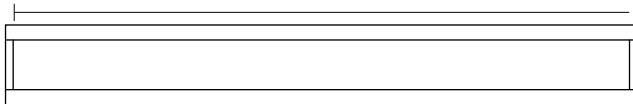

**i** Row configuration, specification sheets and mounting spacing guides are available for download at: [www.axislighting.com](http://www.axislighting.com)

## ● OTHER MOUNTING OPTIONS

WET BEAM DI LED is also available in a wall mount.

## ● WEIGHT

**Pendant LED 4ft** 12.8 lbs / 5.8 kg  
**Pendant LED 8ft** 24.5 lbs / 11.1 kg

## ● GASKETED FIXTURE

With its gasketed end cap and lens the WET BEAM DI LED is made for wet locations, and is ideal for exterior soffits and canopies of malls, hospitals and other institutions.

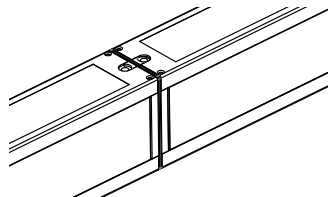

## ● OPTICS

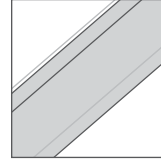

50 spotless lens

### SPOTLESS LENS

Extruded Polycarbonate snap-in lens with micro lens

## ● CONSTRUCTION

<b>Housing</b>	Extruded aluminum (0.062" nominal) Up to 70% recycled content
<b>End Cap</b>	Die cast zinc (0.070" nominal)
<b>Interior Brackets</b>	Die formed sheet steel (16 gauge)
<b>Gaskets</b>	Moulded elastomer (0.100" nominal)
<b>Lens Gaskets</b>	Extruded elastomer (0.045" nominal)
<b>Lens</b>	Extruded polycarbonate (0.125" nominal)
<b>Fasteners</b>	All external fasteners are tamper proof TORX T15H

## ● ELECTRICAL

**Lutron driver** LDE1 - Hi-lume 1% EcoSystem with Soft-on, Fade-to-Black

**Other drivers\*\*** DALI - Digital Addressable Lighting Interface  
DMX - Digital Multiplex  
Xitanium SR - For wireless sensor

**Power over Ethernet MOLEX**  
**POE drivers\*** IGOR  
UL2108 certified for integral or remote driver SMARTENGINE  
O - Other (Consult factory)

**Emergency** Integral emergency battery pack or emergency circuit optional.

**Input Voltage** 120V, 277V, 347V, UNV.

**i** Incorporating these components may have limitations or affect the length of the luminaire. Please contact factory for more details.

## ● LED SYSTEM

**CRI** Minimum 80 or 90 color rendering index.

**CCT** Choice of 2700K, 3000K, 3500K and 4000K color temperature with a great color consistency (within 3-step MacAdam ellipse). Both within fixture and fixture to fixture.

**LED life** Minimum 50,000h with 85% of lumen maintenance in 25°C ambient temperature, in compliance with IES LM-80 testing measurements.

**Thermal Management** Aluminum housing acting as the heat sink to maximize life.

# Wet Beam DI LED | Pendant mount

---

## ● WARRANTY

Axis Lighting will warrant defective LEDs, boards, and drivers for 5 years from date of purchase. Warranty is valid if luminaire is installed and used according to specifications. If defective, Axis will send replacement boards or drivers at no cost along with detailed replacement instructions and instructions on how to return defective components to Axis.

## ● FINISH

Powder coated and custom finishes are also available.

## ● JOINER SYSTEM

WET BEAM DI LED modular system consists of smaller modules joined and gasketed together allowing for system runs in lengths of 4' and 8' as well as custom lengths up to 12'.

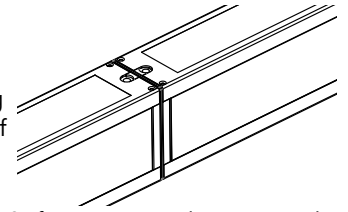

\* For continuous rows allow 2" for connectors between each fixture.

## ● APPROVALS

Certified wet locations to UL and CSA standards 

# Wet Beam DI LED | Pendant mount

## ● PHOTOMETRIC DATA

### SO Spotless lens - Down

1000 lm/ft

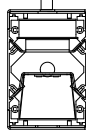

### PHOTOMETRIC CURVE

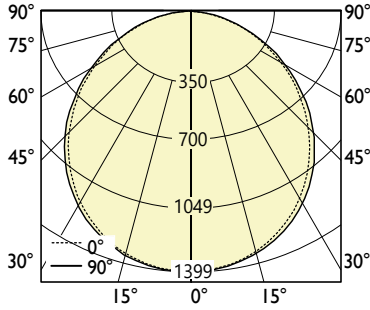

**Lumen/ft: 1000 lm/ft**  
**Total Lumens: 4000 lm (for 4ft)**  
**Input Watts: 49.4 W**  
**Efficacy: 81 lm/W**

IES FILE: WBDLED-0-1000-80-35-SO-4.IES

TESTED ACCORDING TO IES LM-79-2008

### CANDELA DISTRIBUTION

Vertical Angle	Horizontal Angles				
	0	22.5	45	67.5	90
0	1399	1399	1399	1399	1399
5	1395	1394	1392	1392	1391
15	1348	1344	1341	1338	1337
25	1254	1249	1242	1238	1238
35	1117	1110	1104	1097	1096
45	945	937	927	920	918
55	741	730	720	712	709
65	510	499	490	481	479
75	276	266	257	249	248
85	72	66	60	56	56
90	6	3	3	3	3

### ZONAL LUMENS

Zone	Lumens
0	
0-10	132
10-20	379
20-30	575
30-40	693
40-50	720
50-60	650
60-70	492
70-80	281
80-90	78
90	

### LUMINANCE DATA (cd/m<sup>2</sup>)

Vertical Angle	Horizontal Angles		
	0	45	90
45	12340	12103	11979
55	11921	11592	11413
65	11132	10692	10455
75	9834	9160	8839
85	7642	6397	5878

### SO Spotless lens - Up

1000 lm/ft

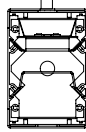

### PHOTOMETRIC CURVE

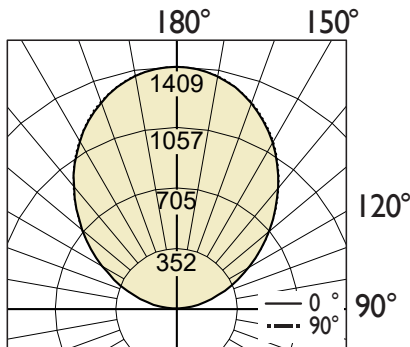

**Lumen/ft up: 1000 lm/ft**  
**Total Lumens: 4000 lm (for 4ft)**  
**Input Watts: 40.7 W**  
**Efficacy: 98 lm/W**

IES FILE: WBILED-0-1000-80-35-SO-4.IES

TESTED ACCORDING TO IES LM-79-2008

### CANDELA DISTRIBUTION

Vertical Angle	Horizontal Angles				
	0	22.5	45	67.5	90
90	10	4	3	3	3
95	80	72	64	56	53
105	285	272	260	248	242
115	520	506	492	479	471
125	750	736	723	710	703
135	954	943	929	918	912
145	1128	1118	1107	1097	1092
155	1265	1257	1249	1241	1238
165	1358	1354	1349	1345	1343
175	1405	1403	1402	1401	1400
180	1409	1409	1409	1409	1409

### ZONAL LUMENS

Zone	Lumens
90	
90-100	77
100-110	278
110-120	490
120-130	648
130-140	720
140-150	695
150-160	577
160-170	381
170-180	133
180	

**i** All IES files are available for download at: [www.axislighting.com](http://www.axislighting.com)

# Wet Beam DI LED | Pendant mount

## ● PHOTOMETRIC DATA

Uplight  
1000 lm/ft  
Downlight  
1000 lm/ft

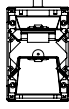

### PHOTOMETRIC CURVE

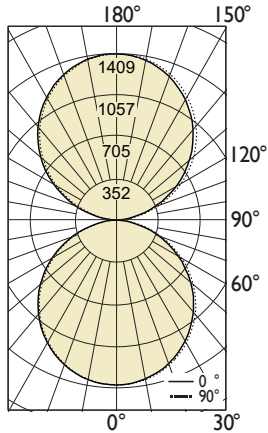

Lumen/ft up: 1000 lm/ft  
Lumen/ft down: 1000 lm/ft  
Total Lumens: 7999 lm (for 4ft)  
Input Watts: 90.1 W  
Efficacy: 89 lm/W

IES FILE: WBDILED-1000-1000-80-35-SO-4.IES

TESTED ACCORDING TO IES LM-79-2008

### CANDELA DISTRIBUTION

Vertical Angle	Horizontal Angles				
	0	22.5	45	67.5	90
0	1399	1399	1399	1399	1399
5	1395	1394	1392	1392	1391
15	1348	1344	1341	1338	1337
25	1254	1249	1242	1238	1238
35	1117	1110	1104	1097	1096
45	945	937	927	920	918
55	741	730	720	712	709
65	510	499	490	481	479
75	276	266	257	249	248
85	72	66	60	56	56
90	10	4	3	3	3
95	80	72	64	56	53
105	285	272	260	248	242
115	520	506	492	479	471
125	750	736	723	710	703
135	954	943	929	918	912
145	1128	1118	1107	1097	1092
155	1265	1257	1249	1241	1238
165	1358	1354	1349	1345	1343
175	1405	1403	1402	1401	1400
180	1409	1409	1409	1409	1409

### ZONAL LUMENS

Zone	Lumens
0	
0-10	132
10-20	379
20-30	575
30-40	693
40-50	720
50-60	650
60-70	492
70-80	281
80-90	78
90	
90-100	77
100-110	278
110-120	490
120-130	648
130-140	720
140-150	695
150-160	577
160-170	381
170-180	133
180	

### LUMINANCE DATA (cd/m<sup>2</sup>)

Vertical Angle	Horizontal Angles		
	0	45	90
45	12340	12103	11979
55	11921	11592	11413
65	11132	10692	10455
75	9834	9160	8839
85	7642	6397	5878

**i** All IES files are available for download at: [www.axislighting.com](http://www.axislighting.com)