

Wall

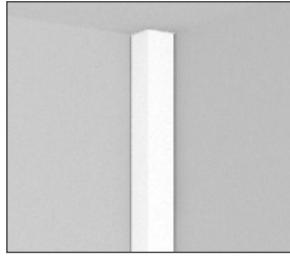

Wall Corner

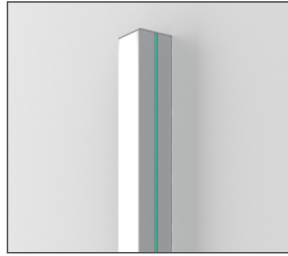

Shown with groove finish

Project \_\_\_\_\_

Type \_\_\_\_\_

Notes \_\_\_\_\_

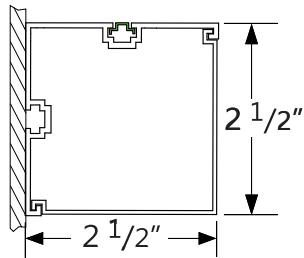

Wall - Groove  
Recommended on  
visible side

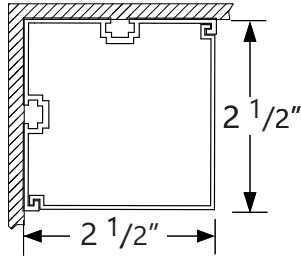

Wall Corner - Groove  
not available



CONTROL  
SENSORS

### Ordering Guide

ED2WV		UB			FINISH	
PRODUCT ID	NOM. LUMENS/FT	CRI	COLOR TEMP.	SHIELDING	LENGTH	FINISH
ED2WV Edge 2 Wall Vertical	400 400 lm/ft - Min	80 80 CRI	27 2700 K	UB Ultra Blend Lens	2 2'	AP aluminum paint W white BLK black C custom
	1000 1000 lm/ft - Max	90 90 CRI	30 3000 K		3 3'	
			35 3500 K		4 4'	
			40 4000 K		5 5'	
					6 6'	
					7 7'	
					8 8'	
					12 12'	
					S# system run	
Outputs between listed min and max are available. Consult factory for outputs outside of the listed range.				For all other lengths and related outputs, please consult factory..		

POSITION	GROOVE FINISH (OPT.)	VOLTAGE	DRIVER	CIRCUITS
W wall	AP aluminum paint	120 120 V	DP dimming (0-10V) 1% - integral*	1 1 circuit
WCO wall corner	W white	277 277 V	LT Lutron-remote (1) - remote**	2 2 circuits
	BLK black	347 347 V*	BI bi-level dimming - remote**	+E(##) emergency circuit (3)
	C custom	UNV universal	O other (2) - remote**	
See page 2 for more information.	Not applicable for wall corner (WCO) position. See page 2 for more details	* Not available with 347V	* Not available with 347V ** Remote driver (1) Specify system. Remote only. (2) Please consult factory; see page 2	(3) Specify quantity

FL	BATTERY - REMOTE (OPTIONAL)	OTHER (OPTIONAL)	IC CONTROLS (OPTIONAL)	CUSTOM (OPTIONAL)
FL flat standard	B# remote battery pack	F fuse	DS# daylight sensor OS# occupancy sensor DOS# daylight & occupancy sensor EN# Enlighted integral (4) ENR# Enlighted remote (4) WC# wireless control dimming	C custom
For close end cap only	Remote only	Requires 120V or 277V	(4) Please consult factory Specify quantity. Requires 8" blank See integrated controls guide more details.	Please specify

### ● SPECIFICATIONS

#### CONSTRUCTION

<b>Housing</b>	Extruded aluminum (0.075" nominal) Up to 70% recycled content
<b>End Cap</b>	Cast aluminum
<b>Interior Brackets</b>	Die formed sheet steel (20 gauge)
<b>Reflectors</b>	White powder coated sheet steel (22 gauge)
<b>Lenses</b>	Extruded acrylic (0.070" nominal)

### ● ELECTRICAL

<b>Mini driver</b>	EDGE 2 features integral mini driver technology. 0-10V dimming standard.
<b>Emergency</b>	Remote emergency battery pack or emergency circuit optional.
<b>Input Voltage</b>	120V, 277V, 347V, UNV.

**i** Incorporating these components may have limitations or effect the length of the luminaire, please contact factory for more details.

### ● LED SYSTEM

<b>CRI</b>	Minimum 80 or 90 color rendering index.
<b>CCT</b>	Choice of 2700K, 3000K, 3500K and 4000K color temperature with a great color consistency (within 3-step MacAdam ellipse). Both within fixture and fixture to fixture.
<b>LED life</b>	Minimum 50,000h with 85% of lumen maintenance in 25°C ambient temperature, in compliance with IES LM-80 testing measurements.
<b>Thermal Management</b>	Aluminum housing acting as the heat sink to maximize life.
<b>Environment</b>	Dry and damp rated in operating ambient temperatures of 0-40°C (32-104F).

### ● POSITION

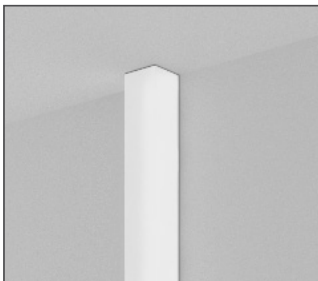

W - Wall

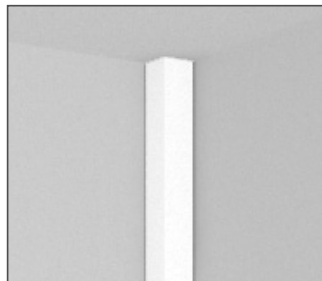

WCO - Wall Corner

### ● WEIGHT

<b>Direct 4 ft</b>	4.7 lbs / 2.1 kg
<b>Direct 8 ft</b>	9.2 lbs / 4.2 kg
<b>Direct 12 ft</b>	13.9 lbs / 6.3 kg

### ● OPTICS

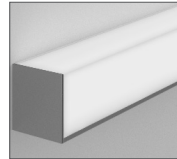

UB Ultra Blend Lens

### ● SYSTEM (S#)

EDGE 2 linear systems, with the use of a strong profile, allow for a nearly hair thin connection system of continuous runs. Lengths of 2', 3', 4', 8', 12' as well as custom lengths are available. Runs of EDGE 2 that are greater than 12' in length are designated as systems (S#). This means that the run is comprised of a combination of 4', 8' and/or 12' sections to be assembled on site using our joining system. For more information on systems and joining, please refer to the EDGE 2 installation sheets available for download at [www.axislighting.com](http://www.axislighting.com).

### ● WARRANTY

Axis Lighting will warrant defective LEDs, boards, and drivers for 5 years from date of purchase. Warranty is valid if luminaire is installed and used according to specifications. If defective, Axis will send replacement boards or drivers at no cost along with detailed replacement instructions and instructions on how to return defective components to Axis.

### ● GROOVE FINISH (OPTIONAL)

Optional InstaMount groove complements design elements in the space. Not available with wall corner mount option. Comes in various finishes.

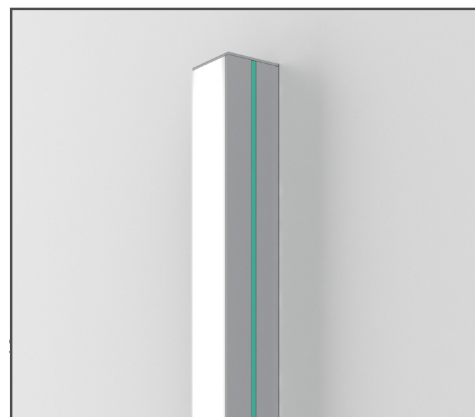

### ● MOUNTING SPACING

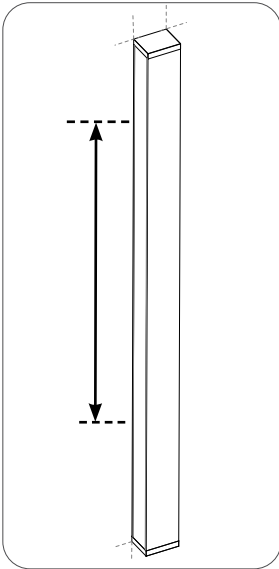

**EDGE 2 LED 4'** (32" C.C.)  
**EDGE 2 LED 8'** (80" C.C.)  
**EDGE 2 LED 12'** (128" C.C.)

**NOTE:** Use stud if possible for mounting

### ● VERTICAL MOUNTING DETAILS

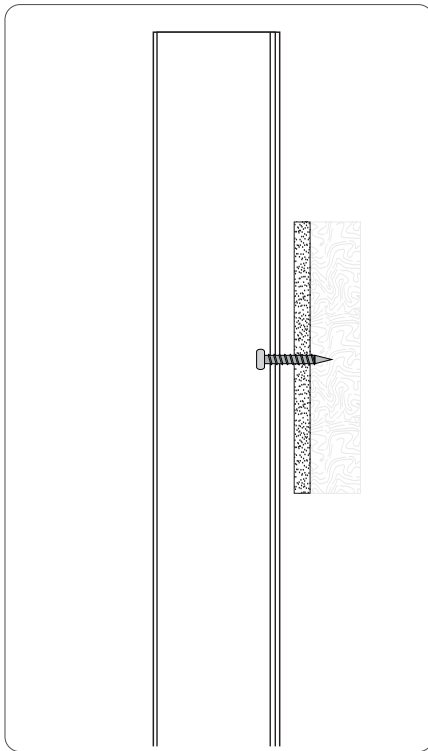

**SIDE VIEW**

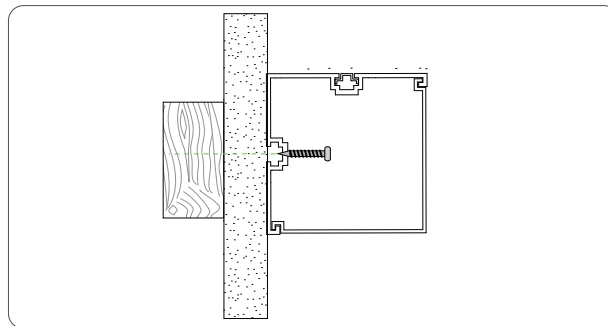

**TOP VIEW**

### ● OTHER MOUNTING OPTIONS

EDGE 2 is also available as Pendant or Surface.

**i** Specification sheets and installation sheets for all mountings for EDGE 2 luminaires are available for download at [www.axislighting.com](http://www.axislighting.com)

### PHOTOMETRIC DATA

400 lm/ft



#### PHOTOMETRIC CURVE

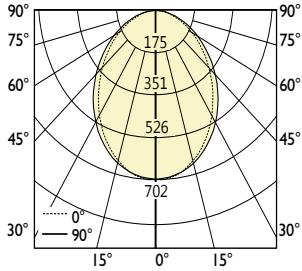

**Lumen/ft: 400 lm/ft**  
**Total Lumens: 1600 lm (for 4ft)**  
**Input Watts: 16.1 W**  
**Efficacy: 99 lm/W**

IES FILE: B2SQDLED-0-400-80-35-SO-4.IES

TESTED ACCORDING TO IES LM-79-2008

80 CRI shown. To calculate watts and efficacy at 90 CRI, apply a multiplier of 0.8.

#### CANDELA DISTRIBUTION

Vertical Angle	Horizontal Angles				
	0	22.5	45	67.5	90
0	700	700	700	700	700
5	698	693	694	695	694
15	646	646	650	655	656
25	559	561	572	582	585
35	451	456	470	484	489
45	342	347	362	377	382
55	241	247	259	272	275
65	154	157	166	175	177
75	80	81	86	91	91
85	20	21	23	25	25
90	1	1	2	2	3

#### ZONAL LUMENS

Zone	Lumens
0	
0-10	66
10-20	183
20-30	263
30-40	294
40-50	280
50-60	232
60-70	165
70-80	92
80-90	27
90	

#### LUMINANCE DATA (cd/m<sup>2</sup>)

Vertical Angle	Horizontal Angles		
	0	45	90
45	2955	3621	6587
55	2097	2673	5720
65	1387	1832	4804
75	773	1056	3748
85	221	324	2261

500 lm/ft



#### PHOTOMETRIC CURVE

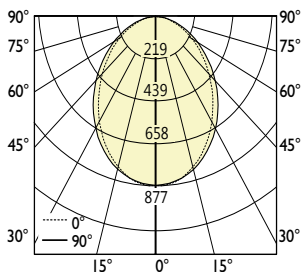

**Lumen/ft: 500 lm/ft**  
**Total Lumens: 2003 lm (for 4ft)**  
**Input Watts: 20.2 W**  
**Efficacy: 99 lm/W**

IES FILE: B2SQDLED-0-500-80-35-SO-4.IES

TESTED ACCORDING TO IES LM-79-2008

80 CRI shown. To calculate watts and efficacy at 90 CRI, apply a multiplier of 0.8.

#### CANDELA DISTRIBUTION

Vertical Angle	Horizontal Angles				
	0	22.5	45	67.5	90
0	874	874	874	874	874
5	873	867	867	868	868
15	808	808	812	819	820
25	699	702	715	727	731
35	564	571	588	605	611
45	427	434	453	472	477
55	301	309	324	340	344
65	192	197	208	219	221
75	100	102	108	114	114
85	26	26	29	31	32
90	1	1	2	3	4

#### ZONAL LUMENS

Zone	Lumens
0	
0-10	82
10-20	229
20-30	329
30-40	368
40-50	350
50-60	290
60-70	206
70-80	115
80-90	34
90	

#### LUMINANCE DATA (cd/m<sup>2</sup>)

Vertical Angle	Horizontal Angles		
	0	45	90
45	3693	4526	8234
55	2621	3341	7150
65	1733	2289	6005
75	966	1320	4685
85	276	404	2826